



2020-Current Silverado HD
Mud Flap Set, Front
Mounting Diagram & Instructions
Kit# GCR203F2

TO BE USED WITH SILVERADO CAP PART #FC002K

IMPORTANT:

Manufacturer is not responsible for negligent use of vehicle with mud flaps installed, including over-tightening of screws and bolts causing damage to vehicle or mud flaps.

TOOLS REQUIRED-

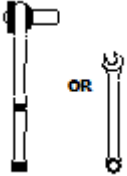

7/16" Open Wrench or Socket Wrench

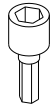

1/4" Socket Driver



T15 Torx Bit

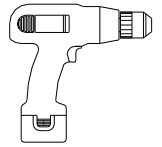

Electric or Rechargeable Drill

FLAPS

(1) Flap Assy Rear, DS

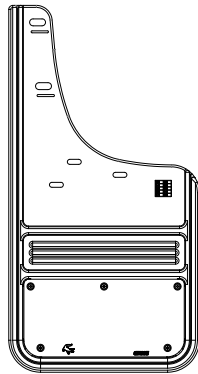

(1) Flap Assy Rear, PS

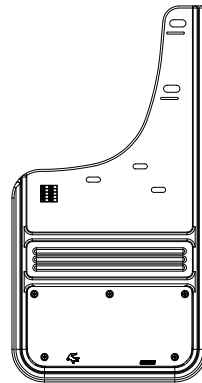

PARTS BAG # 770711

a) (4) Capscrew, Blk Ox. 1/4"-20UNC x 5/8" Part #014071



b) (6) Screw, Blk Ox. 1/4" Hex Head, #8-18x1" Part # 016055



c) (2) Screw, Sht. Mtl. Blk. Ox. 1/4" Hex Hd. #8-18 x 1.5" Part #016063



d) (2) Washer, Flat 0.203" x 0.781" SS Part #018018

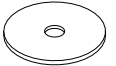

e) (2) Washer, HDPE 5/16" x 1" x 1/4" Part #018036



f) (2) "Z" Clip 0.281" x 1", 18g SS Part #018067

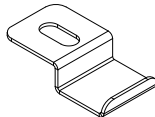

g) (6) Washer, Flat 0.203" x 1" 18g Blk Ox Part #018070

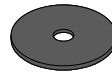

h) (4) Washer, Flat 0.281" x 1.5", Blk Ox. Part #018084

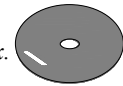

i) (2) Mud Flap Clip Driver Side Part # 769312

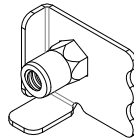

j) (2) Mud Flap Clip Passenger Side Part #769313

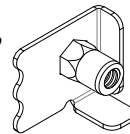

SOLD SEPARATELY FINISHING CAP FC002K:

(1) Finishing Cap Driver's Side

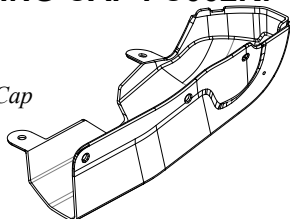

(1) Finishing Cap Passenger's Side

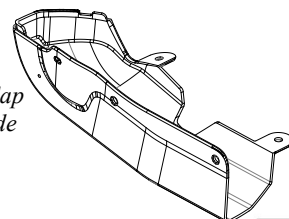

FINISHING CAP INSTALLATION *(For ease of installation it is suggested that the wheel be removed)*

1. Remove the 5 factory screws from the existing factory guard. Set this hardware aside for later reinstallation.
2. Gently pull the flare molding away from the body of the truck, and then quickly pull the guard down and away from the body of the truck to release the clip on the inside of the factory guard.
3. Slightly peel back the red 3M tape on the finishing cap and fold back so it can be fully peeled after cap is in place.
4. Position cap, ensuring the top lip of the cap slides under the fender molding as shown.
5. Reinstall the two factory screws on the underside and back of the finishing cap. Be careful not to overtighten.
6. Finish peeling 3M tape and press firmly on the bottom and side of the finishing cap to ensure a proper seal.
7. Repeat procedure on passenger side.

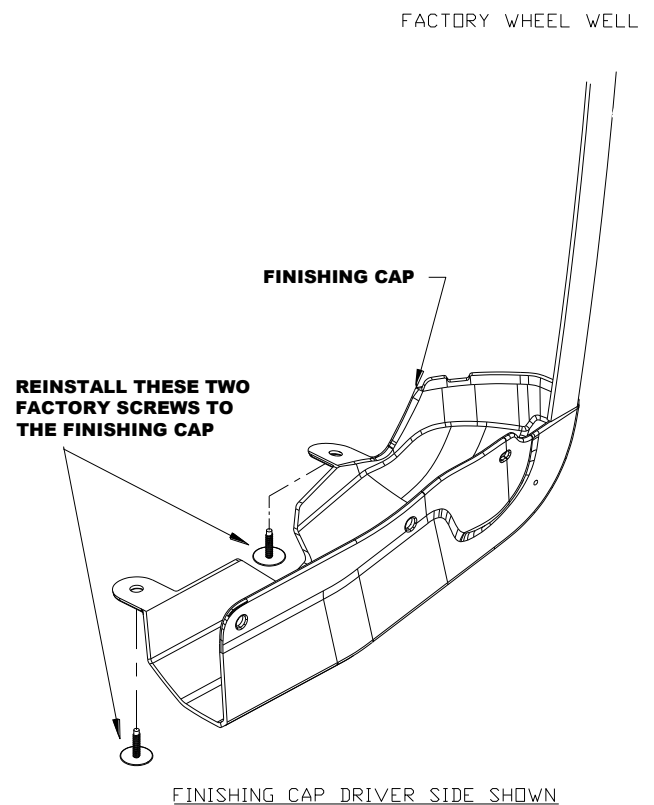
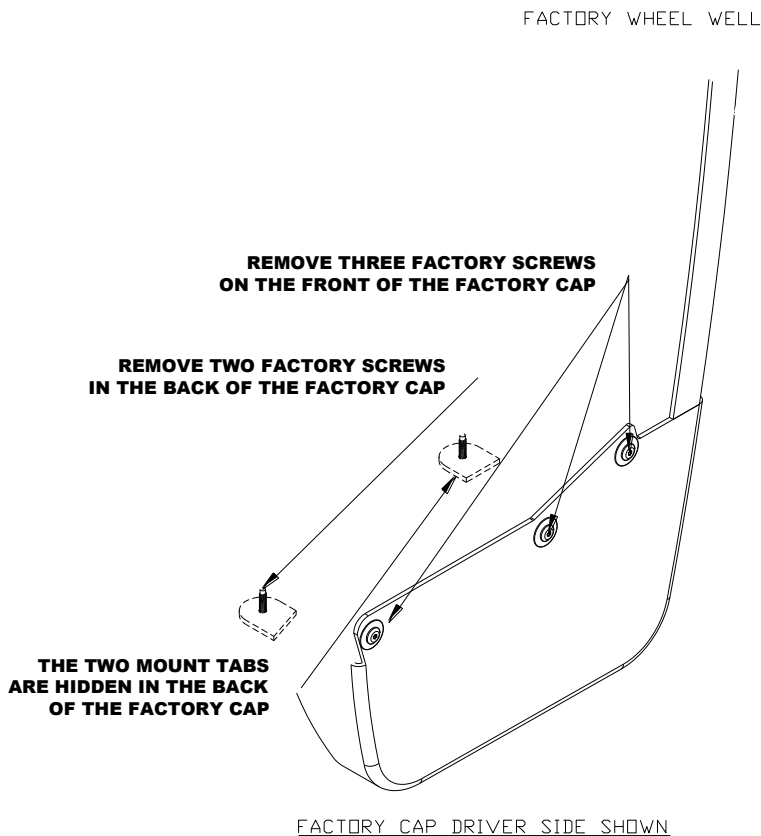

Please check out our YouTube channel to see an install video for this application.



MUD FLAPS:

1. Before you install your Mud Flap Set, see the diagram and parts list for all necessary parts. Start on the driver's side.
2. Loosely install mount clip (i) on mud flap hole #1 & #2 using a cap screw (a) and flat washer (h).
3. Loosely secure mud flap through hole #5 to finishing cap hole #8 using screw (c), flat washer (g), and spacer (e).
4. Install mount clip on hole #1 & #2 behind the fender lip. *Note* Ensure all factory holes line up with finishing cap holes.
5. Secure mud flap through hole #3 into finishing cap hole #6 using supplied screw (b) and flat washer (g).
6. Using a bubble level or other levelling tool, ensure that the mud flap is level and that the factory clips are aligned with the finishing cap holes. Tighten fasteners.
7. Install the "Z" bracket (f) to finishing cap hole #9 using supplied screw (b), and flat washer (d).
8. Install mud flap hole #4 to finishing cap hole #7 using screw (b) and flat washer (g).
9. Repeat procedure for passenger side.

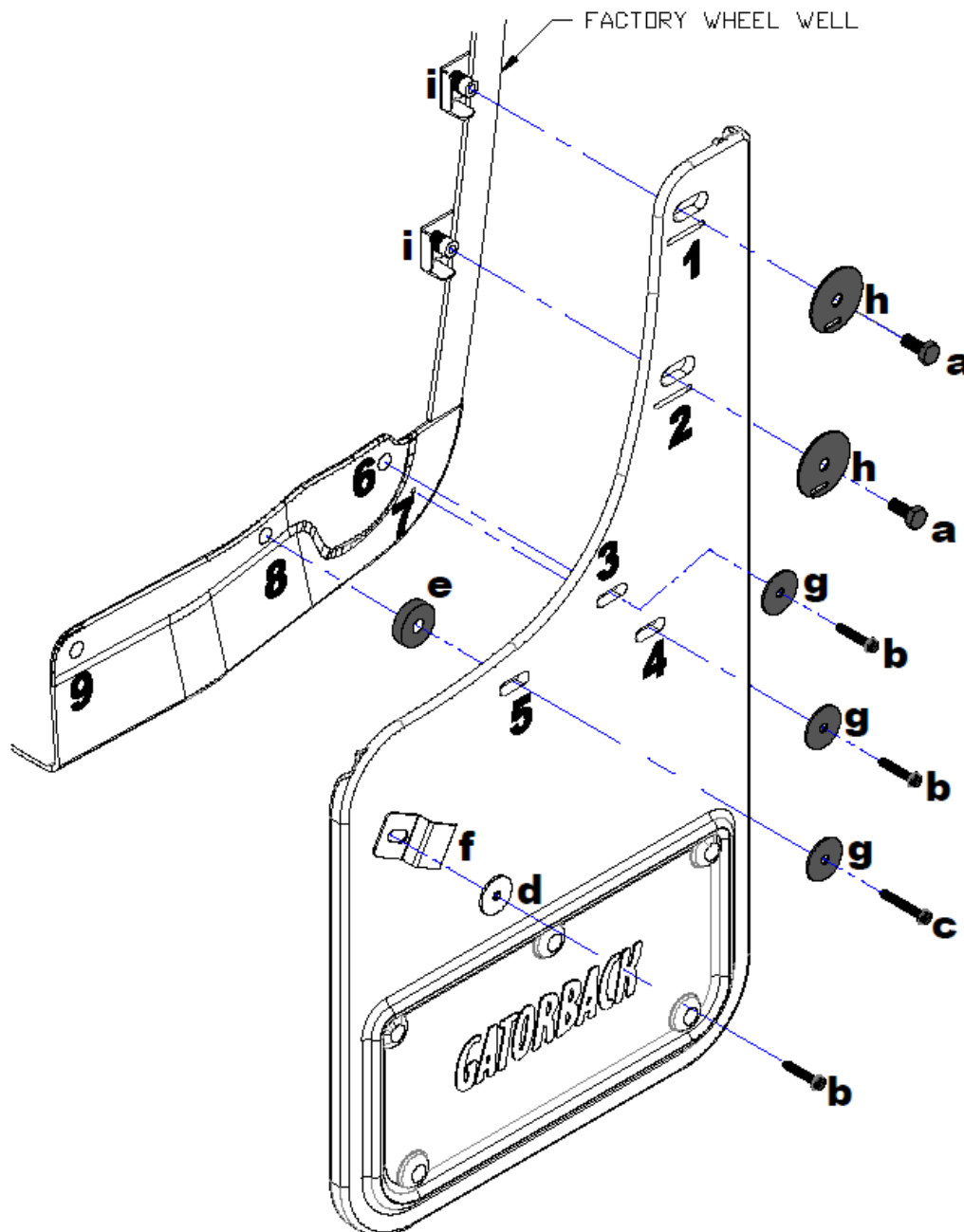

Please check out our YouTube channel to see an install video for this application.



Silverado HD Front