

## Tips & Tricks

- Always wear eye protection when installing covers.
- Elastic straps can snap back at you if released suddenly.
- The included plastic strip is useful for pushing cover and straps through small spaces.

## Headrest Removal

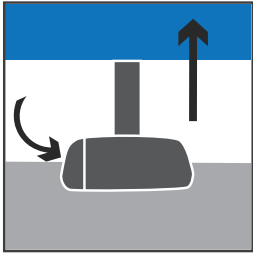

### Tab Removal

- Push in tab on guide post while lifting the headrest.
- Repeat on the opposite side if applicable.

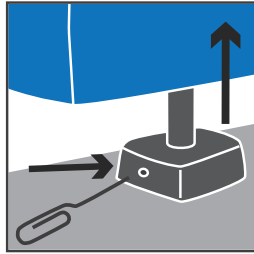

### Pin Hole Removal

- Insert a paperclip end or small allen key into the pin hole.
- While pressing the tool in, lift the headrest.
- Repeat on the opposite side if applicable.

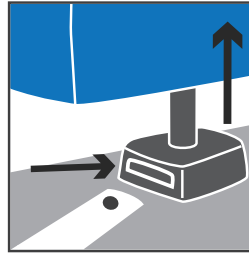

### Slot Removal

- Press into the slot with provided install tool or finger while lifting headrest.
- Repeat on opposite side if applicable.

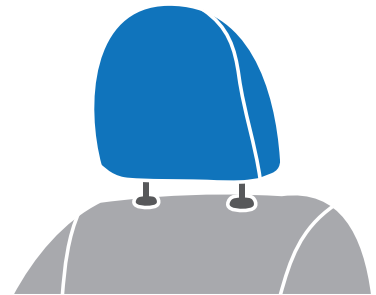

### Tips

- Try turning the cover half inside out, positioning the top and rolling the cover down.
- Ensure all the seams are aligned for proper fit.
- Center rear headrests may have two holes in the back of the cover. Feed the posts through these holes before proceeding.

## Tips

- The covers may be tight and cling to your seat. Ease them on gradually.
- If you are struggling to put the cover on try turning the cover half inside out, positioning the top and rolling the cover the rest of the way down.
- Alternatively a flexible piece of plastic, like the bag the covers came in, can be placed between the cover and the seat to decrease friction. Remove plastic after installation is complete.

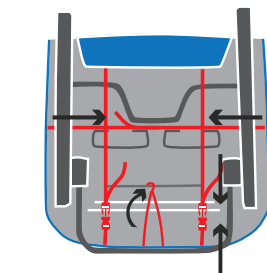
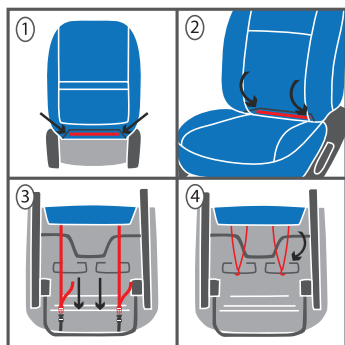

- Buckle straps front to back.
- Connect hook and loop straps side to side.
- Hook any elastic shock cord straps to the underside of the seat.

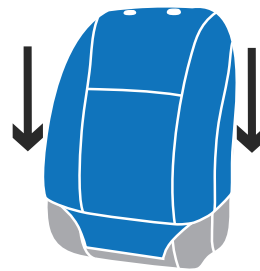

### Installation

- Match cutouts in the cover with any headrest guides, armrests, and levers.
- Airbag tags (newer models) and openings (older models) will face the door.
- Smooth the cover down over the seat.

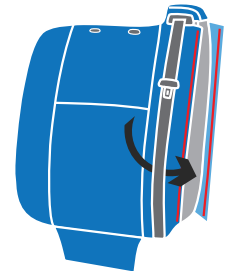

### Integrated Seatbelt

- Open hook and loop side closure on cover and pass the front of the cover underneath the seatbelt before closing the hook and loop again and proceeding with the installation.

## Tips

- Attach the hook and loop at the beginning of the flap to the hook and loop on the backrest cover if present.
- If the bottom cover seems too short to cover the areas closest to the backrest, try smoothing and pulling the cover towards the back more.
- Some covers may have hook and loop tabs that hook to the carpet on the bottom of the seat.

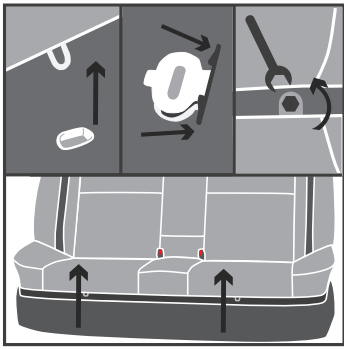

#### Seat Bottom Removal (if applicable)

- Look for any plastic tabs at the base of the seat.
- Pull or push in tabs and lift seat.
- If there are no plastic tabs jerk the seat up hard from the front edge.
- One retaining bolt may be located at the back.

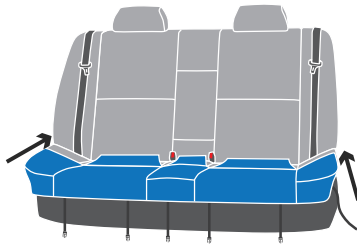

#### Solid Bottom Installation

- Remove the seat from the vehicle if necessary.
- Slide the cover onto the seat, lining up seams and smoothing as you go.
- Tuck in the cover around any seatbelt openings and into any plastic trim.

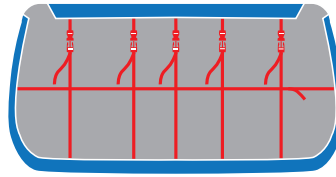

- Buckle the straps from the back to front under the seat.
- Connect the hook and loop straps from the sides under the seat.
- Replace seat if necessary while making sure the seatbelts are pulled back through.

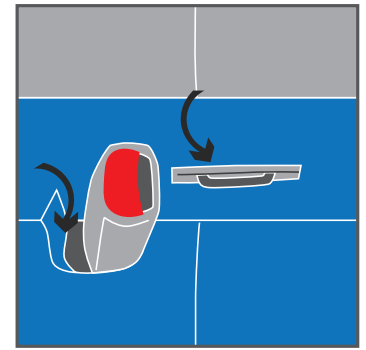

#### Seat Belts & Child Seat Anchors

- Tuck in any flaps around seat belts.
- Covers will have openings to accommodate child seat anchors.
- Pull any straps at the openings for the child seat anchors through.

## Tips

- If the bottom cover seems too short to cover the areas closest to the backrest, try smoothing and pulling the cover towards the backrest.
- Some covers may have hook and loop tabs that hook to the carpet on the bottom of the seat.

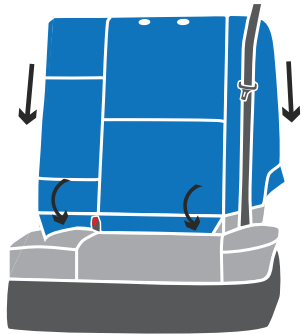

#### Installation

- Slide the cover over the seat, lining up the seams and smoothing as you go.
- Tuck the cover in around any headrest posts, levers, or openings.
- Push the flap between the seatback and bottom.

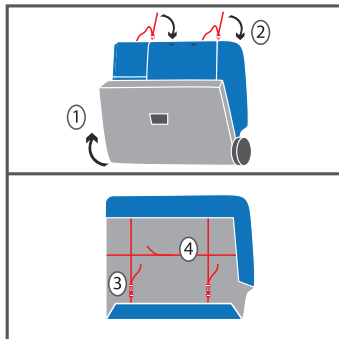

#### Truck Style

1. Lift the bottom of the seat to get more room behind the backrest.
2. Pass the straps at the top of the cover over the back.
3. Connect straps from the top to straps at the bottom.
4. Hook hook and loop straps together across the back.

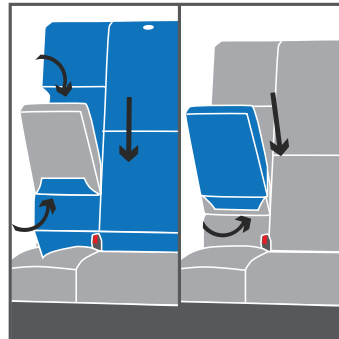

#### Center Armrest Installation

- Pull the armrest slightly out while putting cover on and put it through the opening in the cover.
- Tuck in anchor flaps/tabs or attach the hook and loop behind the armrest.
- Slide armrest on and attach hook and loop.

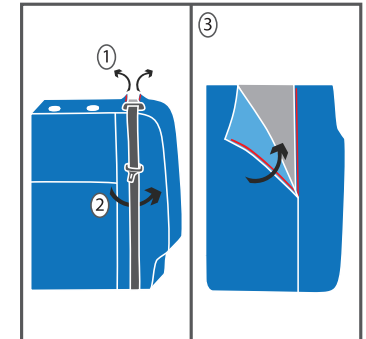

#### Integrated Seatbelt

1. Open hook and loop closure on back or side if present.
2. Slide the cover underneath the seatbelt before proceeding with installation. Reattach hook and loop and tuck cover in around the seat belt guides.

## Tips

- The backrest cover will always go underneath the seat belts.
- Moving the armrest up and down can help push the armrest cover into place.
- Tucking the cover in around any plastic trim will give the seat a more polished look.

## Care

Vacuum regularly to remove debris. Spot wash with a damp cloth. Use material specific cleaners for stains.

**WARNING:** Machine wash and dry cycles can potentially damage the foam backing on your covers.

**Scan code on phone or tablet to view full detailed seat cover installation instructions:**



If you encounter any problems during the installation of your Seat Cover, please contact our Customer Service Department, Monday - Friday, 8AM - 5PM (MST) at 866-755-6005 or by e-mail at [pfsales@covercraft.com](mailto:pfsales@covercraft.com). You may also access help videos on the web at <https://www.covercraft.com/us/en>.