



INSTALLATION INSTRUCTIONS FOR MOUNTING

LUVERNE GRILLE GUARD WITH THE FOLLOWING MODEL NO.:
321334 ON:
2013 AND NEWER DODGE RAM 4500/5500

1. READ THE INSTRUCTIONS COMPLETELY AND CHECK TO MAKE SURE THAT ALL OF THE REQUIRED PARTS ARE ON HAND BEFORE STARTING THE INSTALLATION. THE INSTALLATION REQUIRES:

- (1) GRILLE GUARD PACKAGE:
 - (1) GRILLE GUARD WELDMENT, BLACK
- (1) UPRIGHT/BRACKET PACKAGE:
 - (2) TOP MOUNTING BRACKETS
 - (1) BOTTOM MOUNTING BRACKET LH
 - (1) BOTTOM MOUNTING BRACKET RH
 - (1) HARDWARE PACKAGE

REFER TO SHEETS #1 - #3 FOR GUARD ASSEMBLY & INSTALLATION INSTRUCTIONS 2-9

2. INSTALL THE TOP MOUNTING BRACKETS (ITEM #2) TO THE PLATES ON THE END OF THE FRAME USING THE FOUR M10 X 1.5 X 45mm WASHER HEAD BOLTS (ITEM #8) AND THE FOUR M10 X 1.5 FLANGE NUTS (ITEM #11). AS SHOWN IN *fig. 1*. HAND TIGHTEN ONLY AT THIS TIME.
3. INSTALL THE LOWER MOUNTING BRACKETS (ITEM #3&4) TO THE BOTTOM AND SIDE OF THE TOW HOOK BRACKETS THAT HANG DOWN FROM THE BOTTOM OF THE FRAME MAKING SURE THE TWO HOLES IN THE BRACKETS SLIDE OVER THE TWO BOLTS THAT GO VERTICAL THROUGH THE FRAME, DO NOT REMOVE THE FACTORY NUTS. ONCE THE BRACKETS ARE IN PLACE FASTEN WITH THE M12 X 1.75 SERR FLANGE NUT (ITEM #19) ON THE SIDES, AND WITH THE 5/8"-11 X 2" CLIPPED HEAD BOLTS (ITEM #5), 5/8" FLAT WASHERS (ITEM #17), 5/8" LOCK WASHERS (ITEM #18) AND A 5/8"-11 HEX NUTS (ITEM #16) ON THE BOTTOM. LEAVE THE FASTENERS LOOSE AT THIS TIME.
4. ON THE BOTTOM MOUNTING BRACKET STUDS (ITEM #6), INSTALL A 1/2"-13 FLANGE NUT (ITEM #9) WITH THE FLANGE FACING OUT AND A 1/2" FLAT WASHER (ITEM #13) ON EACH END OF THE STUDS. INSERT THE ASSEMBLED STUD THROUGH THE HOLE IN THE LOWER PLASTIC FASCIA AND INTO THE SLOT IN THE FRAME MOUNTING BRACKET ANGLE. INSTALL A 1/2" FLAT WASHER (ITEM #13) AND A 1/2"-13 FLANGE NUT (ITEM #9) ON THE END OF EACH STUD. LEAVE LOOSE AT THIS TIME.
5. SET THE GRILLE GUARD WELDMENT (ITEM #1) ONTO THE UPPER MOUNTING BRACKETS SO THAT THE TOP MOUNTING BRACKETS ARE ON THE INSIDE OF THE UPRIGHTS, AT THE SAME TIME MAKE SURE THAT THE END OF THE STUD IS INSERTED INTO THE HOLE IN THE BOTTOM PLATE IN THE UPRIGHT. INSTALL THE FOUR M12 X 1.75 X 35mm CARRIAGE BOLTS (ITEM #7) INTO THE SIDE OF THE UPRIGHTS AND INTO THE TOP MOUNTING BRACKETS (ITEM #2) AND FASTEN WITH THE M12 NARROW FLAT WASHERS (ITEM #12), M12 LOCK WASHERS (ITEM #14) AND M12 X 1.75 ACORN NUTS (ITEM #10). INSTALL A 1/2"-13 FLANGE NUT (ITEM #9) AND A 1/2" FLAT WASHER (ITEM #13) ON EACH END OF THE STUDS. LEAVE BOLTS LOOSE AT THIS TIME.



6. CHECK THAT THE GRILL GUARD IS CENTERED AND VERTICAL ON THE BUMPER AND THE UPRIGHTS ARE STRAIGHT UP AND DOWN. THEN TIGHTEN THE FOUR M12 X 1.75 X 35mm CARRIAGE BOLTS (ITEM #7), SECURING THE GRILLE GUARD TO THE MOUNTING BRACKETS.
7. TIGHTEN THE EIGHT BOLTS (ITEM #8) SECURING THE TOP MOUNTING BRACKETS (ITEM #2) TO THE FRAME.
8. TIGHTEN THE TWO BOLTS (ITEM #11) SECURING THE FRAME ANGLE BRACKET TO THE BOTTOM OF THE TOW HOOK ON THE BOTTOM OF THE FRAME.
9. ADJUST THE TWO LOWER STUDS TO MAKE SURE THE GRILLE GUARD IS STRAIGHT UP AND DOWN AND TIGHTEN ALL OF THE FLANGE NUTS (ITEM #9).

SERVICE PARTS LIST

ITEM	PART NO.	QTY	DESCRIPTION
1	109213	1	GRILLE GUARD WELDMENT - BLACK
2	109213	2	MOUNTING BRACKET - TOP
3	202682	1	MOUNTING BRACKT BOTTOM, LH
4	202683	1	MOUNTING BRACKT BOTTOM, RH
5	104692	2	CLIPPED HEAD SCREW – 5/8”-11 X 2”, ZP
6	202684	2	MOUNTING BRACKET STUD – BOTTOM
7	109455	4	CARRIAGE BOLT - M12 X 1.75 X 35mm, BZP
8	109453	8	HEX FLANGE SCREW - M10 X 1.5 X 45mm, BZP
9	100123	8	SERRATED FLANGE NUT – ½”-13, ZP
10	109457	4	ACORN NUTS – M12 X 1.75, BZP
11	109459	8	SERRATED FLANGE NUT – M10 X 1.5, BZP
12	109462	4	NARROW FLAT WASHER – M12, BZP
13	100118	8	REGULAR FLAT WASHER – 1/2”, ZP
14	109464	4	SPRING LOCK WASHER – M12, BZP
15	106888	1	DECAL – LOGO, LUVERNE, 3/4 X 3
16	100149	2	HEX NUT – 5/8-11, ZP
17	100147	2	FLAT WASHER – 5/8”, ZP
18	100148	2	LOCK WASHER – 5/8, ZP
19	100794	4	SERRATED FLANGE NUT-M12 X 1.75,ZP



(A LUVERNE Company)

1200 E. Birch St.

Brandon, SD 57005

202689 SHEET 2 OF 3 26AUG13

SERVICE PARTS LIST
 MODEL NO - 321334

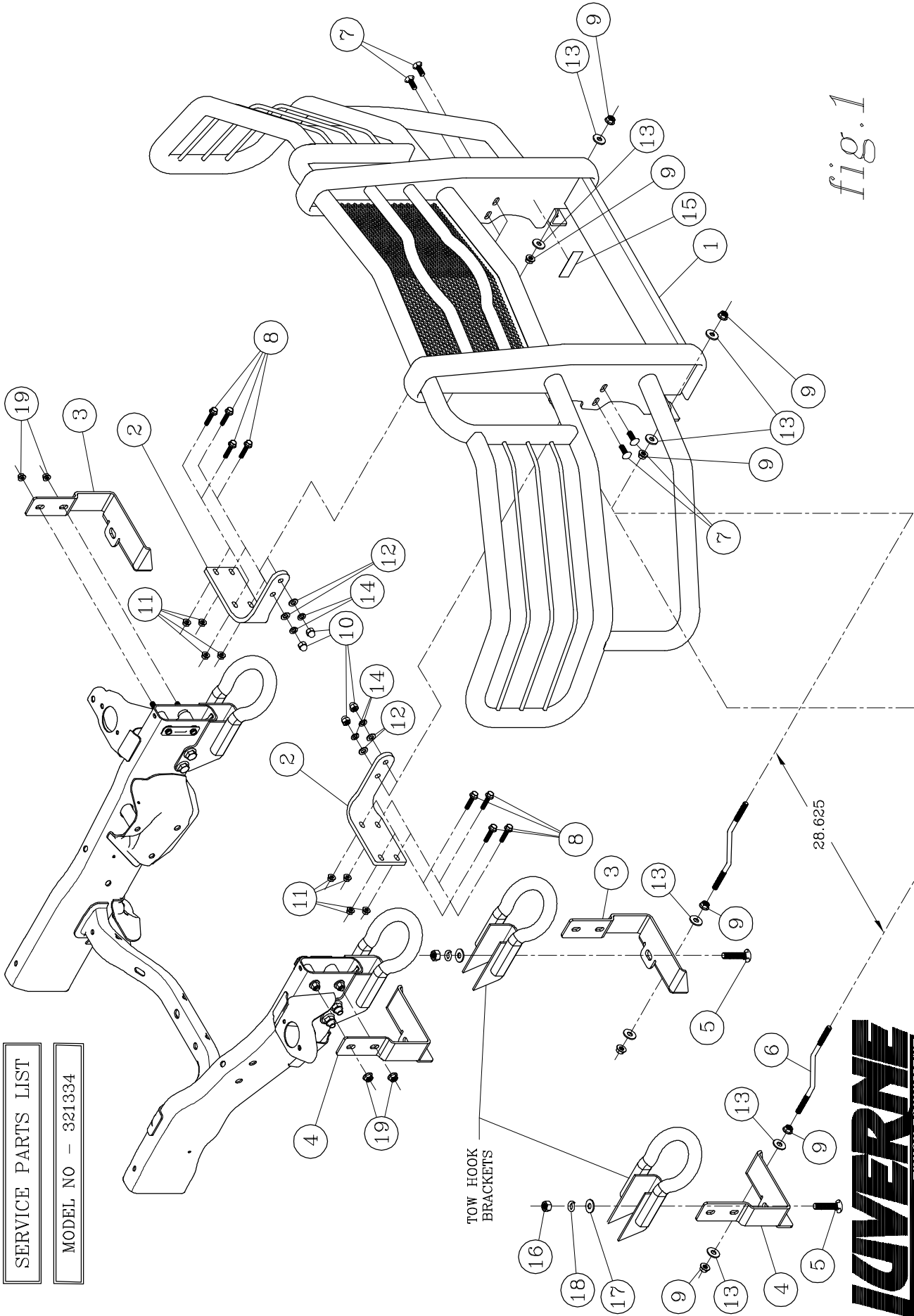

fig.1

LOVERNE
 TRUCK EQUIPMENT
 (A LOVERNE Company)

1200 E. Birch St.
 Brandon, SD 57005