

IMPORTANT:

Manufacturer is not responsible for negligent use of vehicle with mud flaps installed, including over-tightening of screws and bolts causing damage to vehicle or mud flaps.

NO-DRILL SYSTEM

TOOLS REQUIRED-

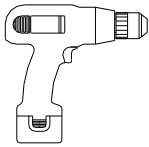

Electric or Rechargeable Drill



1/4" Drill Bit

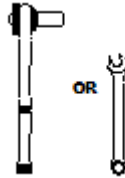

OR

5/16" Open Wrench or Socket Wrench

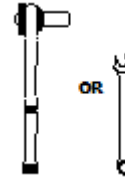

OR

3/8" Open Wrench or Socket Wrench

FLAPS

(1) Flap Assembly, Front, DS

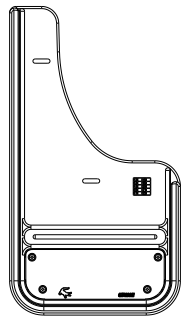

(1) Flap Assembly, Front, PS

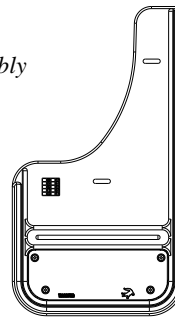

PARTS BAG # 768113

*a) (4) Washer, Flat
 0.203" x 1.5", 18GA, SS
 Part #018066*

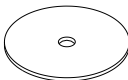

*b) (4) Washer, Flat
 0.203" x 0.781" 18ga, SS
 Part #018018*



*c) (10) Washer, Flat
 0.203"x0.885" Nylon
 Part # 054080*



*d) (2) Washer, Lock
 18-8SS, Helicoil
 Part #024001*



*e) (2) Screw, Mach.
 18-8SS, 10-24x1, Hex Hd
 Part # 012022*



*f) (2) Nut, Hex
 #10-24, SS
 Part # 025003*



*g) (4) Bolt, Hex Flange
 M4.2 x 1" Black, SS
 Part #016041*

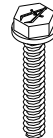

INSTALLATION *(For ease of installation it is suggested that the wheel be removed)*

1. Before you install your Mud Flap Set, see the diagram and parts list for all necessary parts. Start on the driver's side.
2. Remove 2 factory bolts from the fender
3. Secure flap through hole #2 to fender hole #5 using a stainless steel bolt (#016041), a stainless steel washer (#018066), and two nylon washers (#054080). Loosely secure at this point.



- Secure flap through hole #1 to fender hole #4 using a stainless steel bolt (#016041), a stainless steel washer (#018066), and three nylon washers (#054080). Loosely secure at this point.
- Using a bubble level or square, ensure that the mud flap is level. Viewing the vehicle from the back, the outer edge of the mud flap should appear parallel to the tires.
- Drill a 1/4" hole through the mud flap (#3) and liner (#6).
- Secure the mud flap to the liner using a machine screw (#012022), two stainless steel washers (#018018), a lock washer (#024001) and a hex nut (#025003).
- Carefully tighten all fasteners and ensure that the flap has remained level.
- Repeat procedure for the passenger side.

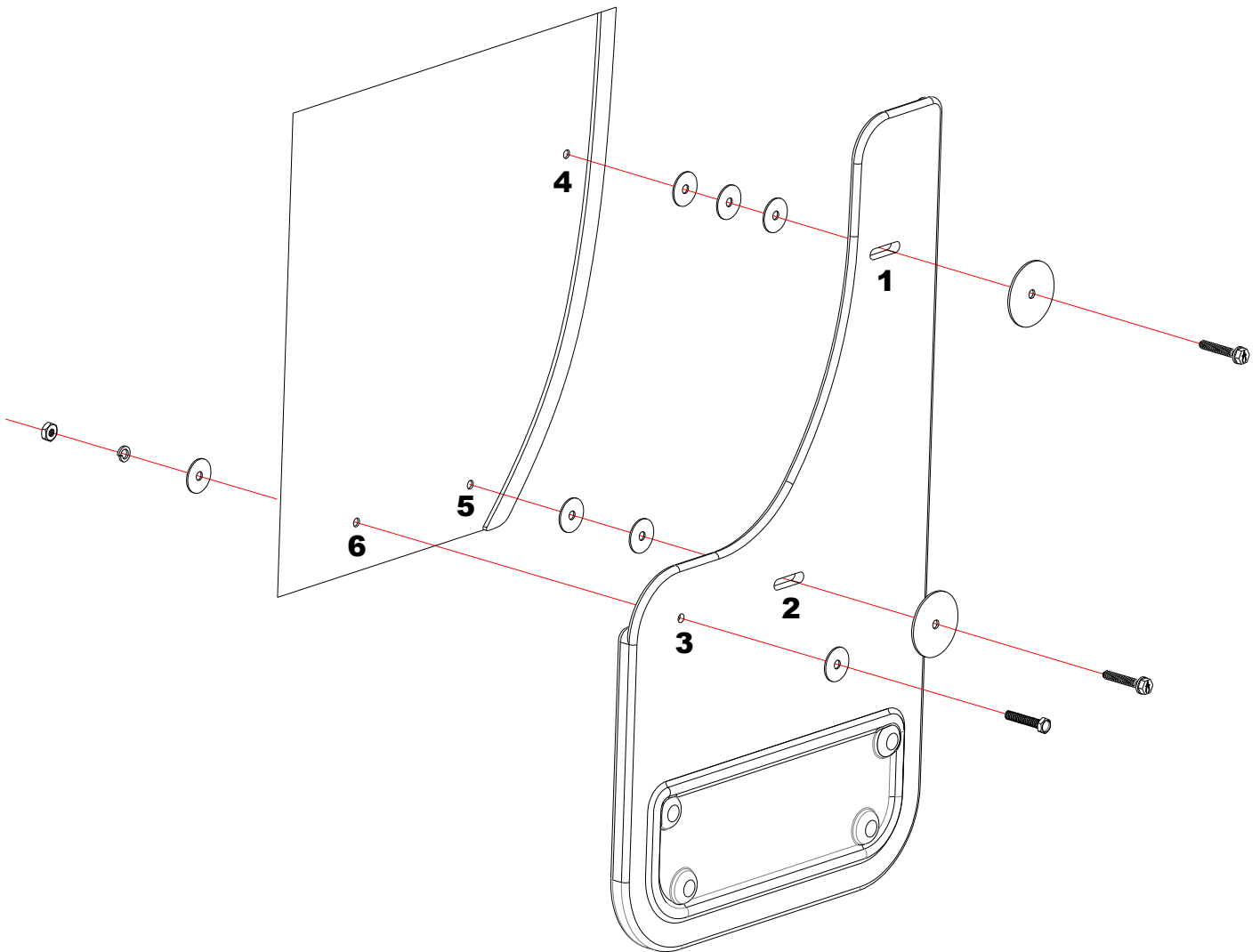

Please check out our YouTube channel to see an install video for this application.



IMPORTANT:

Manufacturer is not responsible for negligent use of vehicle with mud flaps installed, including over-tightening of screws and bolts causing damage to vehicle or mud flaps.

NO-DRILL SYSTEM

TOOLS REQUIRED-

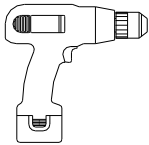

Electric or Rechargeable
Drill



1/4" Drill
Bit

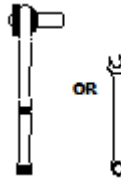

5/16" Open Wrench or
Socket Wrench

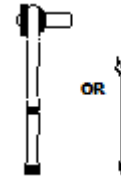

3/8" Open Wrench or
Socket Wrench

FLAPS

(1) Flap Assembly,
Front, DS

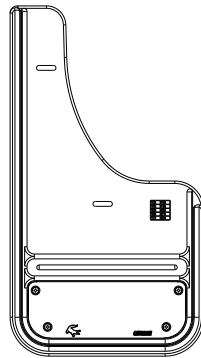

(1) Flap Assembly
Front, PS

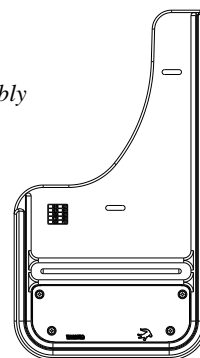

PARTS BAG # 768114

a) (4) Washer, Flat
0.203" x 1.5", 18GA, SS
Part #018066

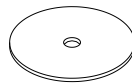

b) (4) Washer, Flat
0.203" x 0.781" 18ga, SS
Part #018018



c) (4) Washer, Flat
0.203" x 0.885" Nylon
Part # 054080



d) (2) Washer, Lock
18-8SS, Helicoil
Part #024001



e) (2) Screw, Mach.
18-8SS, 10-24x1, Hex Hd
Part # 012022

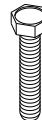

f) (2) Nut, Hex
#10-24, SS
Part # 025003

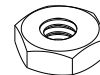

g) (4) Bolt, Hex Flange
M4.2 x 1" Black, SS
Part #016041

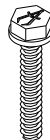

h) (2) Washer, Offset
0.203" x 1.5" SS
Part #018077

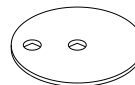

i) (2) Washer, Flat
5/16" x 1" x 1/4" HDPE
Part #018036



INSTALLATION (For ease of installation it is suggested that the wheel be removed)

- Before you install your Mud Flap Set, see the diagram and parts list for all necessary parts. Start on the driver's side.
- Remove 2 factory bolts from the fender holes #4 & #5.

- Secure flap through hole #2 to fender hole #5 using a stainless steel bolt (#016041), a stainless steel washer (#018066), and a HDPE washer (#018036). Loosely secure at this point.
- Secure flap through hole #1 to fender hole #4 using a stainless steel bolt (#016041), an offset washer (#018077), and two nylon washers. Loosely secure at this point.
- Using a bubble level or square, ensure that the mud flap is level. Viewing the vehicle from the back, the outer edge of the mud flap should appear parallel to the tires.
- Drill a 1/4" hole through the mud flap (#3) and liner (#6).
- Secure the mud flap to the liner using a machine screw (#012022), two stainless steel washers (#018018), a lock washer (#024001) and a hex nut (#025003).
- Carefully tighten all fasteners and ensure that the flap has remained level.
- Repeat procedure for the passenger side.

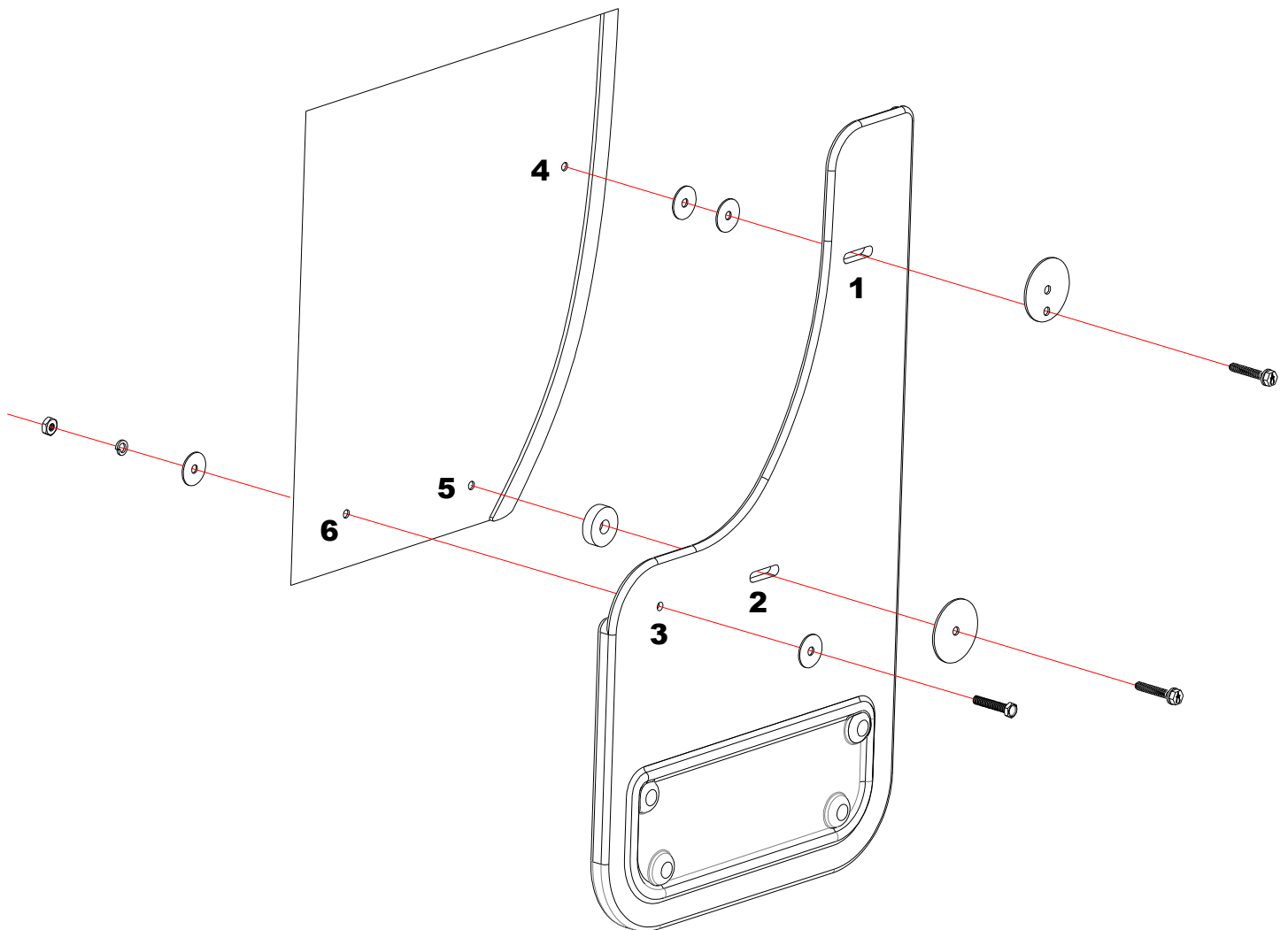

Please check out our YouTube channel to see an install video for this application.

