

INSTALLATION MANUAL

51189

Level of Difficulty

Easy

Installation difficulty levels are based on time and effort involved and may vary depending on the installer level of expertise, condition of the vehicle and proper tools and equipment.

Parts List

Qty	Description
1	Echo® manual override button
1	Reusable adhesive sticker

Tools Required

None

Maintenance

This button uses a CR2032 coin cell battery. Periodic inspection should be performed to ensure there is no visible damage.

Product Registration and Warranty

CURT stands behind our products with industry-leading warranties. To get copies of the product warranties, register your purchase or provide feedback, visit: warranty.curtgroup.com/surveys

⚠ WARNING

This device contains a battery composed of lithium, organic solvents and other combustible materials. Improper handling of the battery could lead to distortion, leakage, overheating, explosion or fire, causing personal injury. Never swallow, charge, heat, expose to open flames, moisture or liquid. Never attempt to disassemble, reverse the polarity or short circuit.

Product Photo



Echo® Mobile Brake Controller (not included)



⚠ CAUTION

When disposing of used batteries, remove the batteries in advance. If not possible, dispose entire product in a waste bin specific for electronics, as per the WEEE directive. Follow any national or local regulations for battery disposal that apply to your area. This button is not a toy. It contains small parts and accessories that present a choking hazard. Keep away from children or pets. Do not attempt to service this product.

NOTICE

Before you begin installation, read all instructions thoroughly. All steps must be followed to ensure the product will function properly. Once installed, test for proper function by using a test light or connecting a properly wired trailer. Battery life will be shortened with heavy usage and / or use in extreme conditions. Do not use product in temperatures below -4°F (-20°C) or above 129.2°F (54°C). This button is rated as splash-proof only. Do not submerge or attempt to use under water as this will result in irreversible damage that is outside our warranty coverage. Clean with a damp cloth and do not use chemical or abrasive cleaning products.

Step 1

Follow the instructions included with your Echo® mobile brake controller on how to install the unit and pair it to the app.

Once the Echo® mobile brake controller is paired to your device, select the menu button in the upper left corner of the app. Select the 'Echo® Manual Override Button' option from this screen.

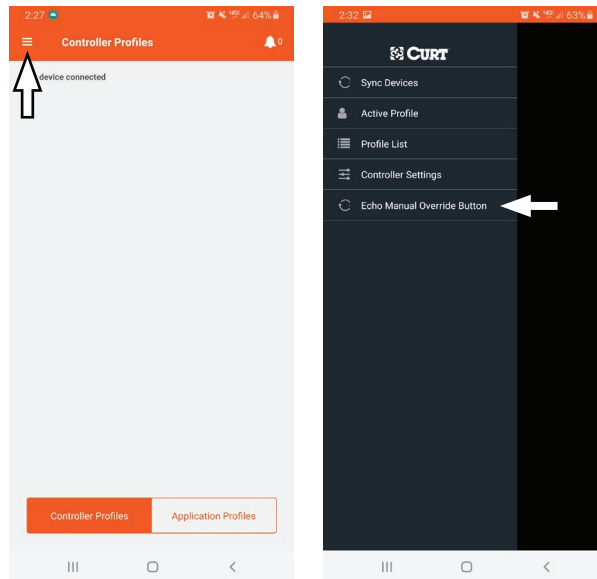

Step 2

Select the 'Start Scan' button in the app. While the app is scanning, press and hold the manual override button to pair.

If at any point, you want to stop the scan, press the 'Stop Scan' button.

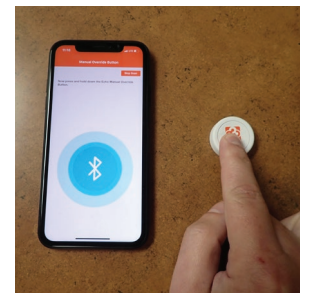
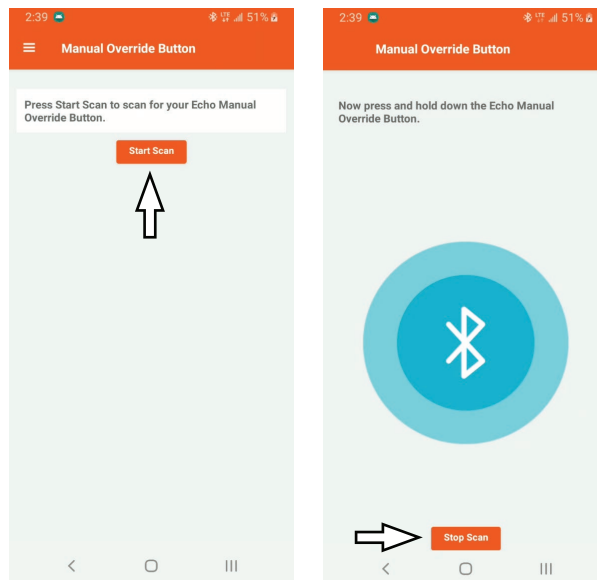

Step 3

The notification 'The Echo® Manual Override Button has been added' will appear if pairing is successful. Select 'OK' to complete pairing.

If the notification 'Device Not Found' appears, pairing was unsuccessful and you will need to repeat step 3.

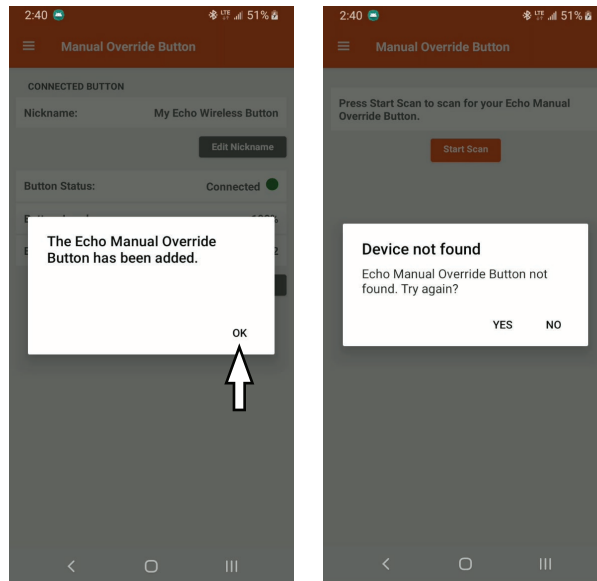

Step 4

With the button paired to your phone, a status bar will appear on the manual override screen. You will see a green or red dot showing the connections status.

● Connected ● Disconnected

The override button will continue to operate on any screen within the app or if the device screen is off, as long as the app is still running. However, you will only have visibility of the manual brake activation ring, displaying the stopping power being applied to the brakes while on the 'Active Profile' screen.

If you close and reopen the app, you must press the override button to reactivate and pair to your phone again.

As you press the override button, the brake activation ring will show stopping power being applied to the brakes. The notification 'Brakes Being Applied' will appear in the center of the ring.

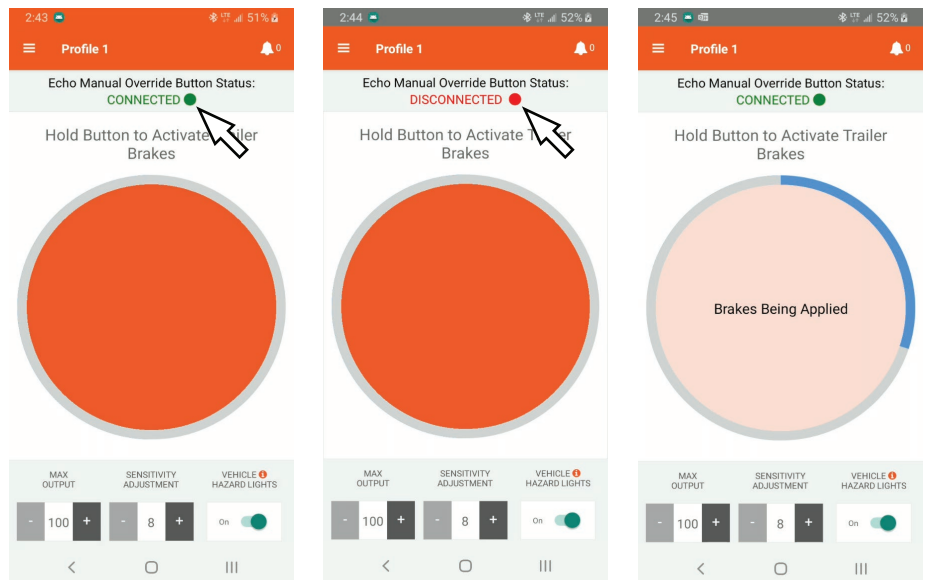

Step 5

To view the connection status, battery level and other details of the override button, select 'Echo® Manual Override Button' from the menu in the upper left corner of the screen.

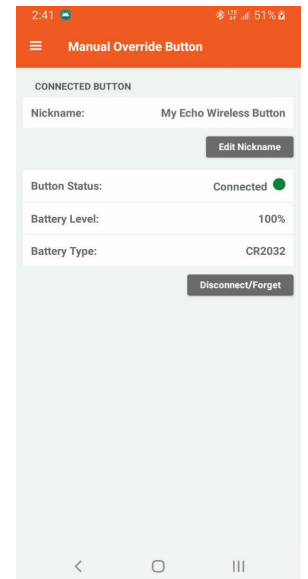
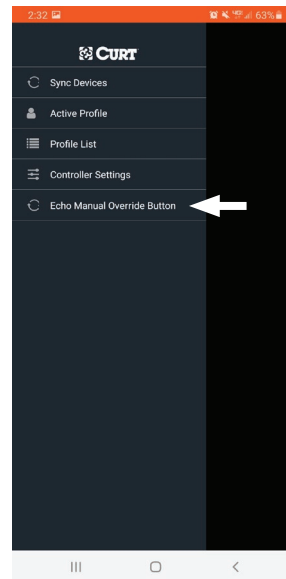
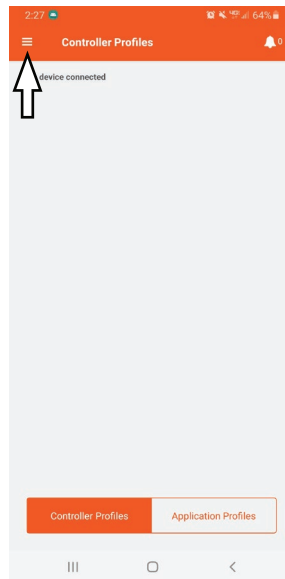

Step 6

From the 'Manual Override Button' screen, you can change the nickname of your override button.

To edit the nickname of the button, select the 'Edit Nickname'. Type in the desired name for your override button and select 'OK' to finalize.

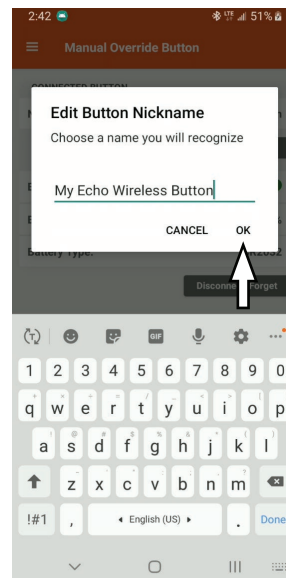
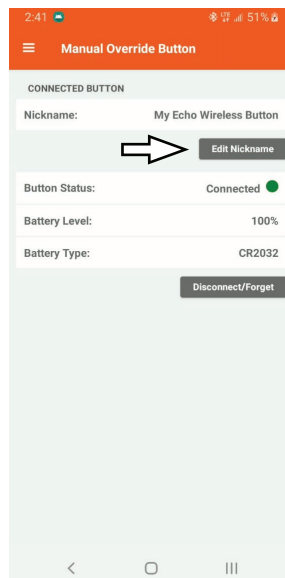

Step 7

To disconnect the override button, select 'Disconnect / Forget'

Note: The device can only connect to one override button at a time. If you wish to connect to another override button, you must disconnect the current button. Select 'Yes' to complete the disconnect.

The override button can only be connected to one device at a time, but it can be set up on several devices. If multiple devices in the area have a connection to the same override button, you will need to make sure the bluetooth is turned off on all undesired devices when pairing.

Reference step 5 on how to check the connection status of the override button.

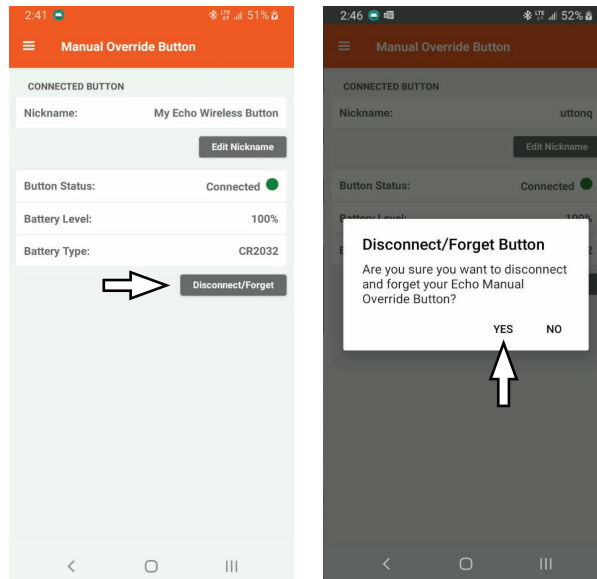

Step 8

Locate a suitable mounting location for the override button inside the vehicle. Clean the mounting surface prior to adhering the button.

The override button comes with a reusable adhesive sticker on the base. Peel off the protective film and mount the button in a safe and convenient place to operate while driving.

WARNING

Do not place the button over vehicle safety devices such as air bags, vehicle indicators or displays.

If you want to change the position of the button, you can remove it by peeling the button along with the adhesive off of the surface.

NOTICE

Be sure to peel rather than pull when removing the override button and adhesive to avoid damage to the mounting surface.

To clean your reusable adhesive, remove it from the button's base and rinse with water. Rub carefully and rinse again.

NOTICE

Do not apply solvents, chemicals or abrasive cleaning products as this will damage the adhesive.

Let the adhesive air-dry and it will return to its initial state and be ready to adhere again.

