

INSTALLATION INSTRUCTIONS AND PARTS LIST

MODEL 583254, 584254
54" O-MEGA II 6" OVAL STEPS
UNIVERSAL APPLICATION

1. READ INSTRUCTIONS COMPLETELY AND CHECK TO MAKE SURE THAT ALL REQUIRED PARTS (LISTED ON THE SERVICE PARTS LIST) ARE ON HAND BEFORE STARTING THE INSTALLATION.
2. FOLLOW THE INSTRUCTIONS INCLUDED WITH THE SPECIFIC BRACKET PACKAGE THAT YOU ARE USING, TO MOUNT THE BRACKETS TO YOUR VEHICLE.
3. BEFORE ATTACHING THE O-MEGA STEPS TO THE BRACKETS, PLACE THE STEP PADS (ITEM #2) ON TOP OF THE STEP PLATES ACCORDINGLY FOR YOUR VEHICLE. USING THE HOLES IN THE STEP PAD AS A GUIDE DRILL (5) 1/8" PILOT HOLES. ATTACH WITH (5) #8-18X1/2" TEK SCREWS (ITEM #6) PROVIDED. REPEAT FOR ALL STEP PADS.
4. INSTALL THE REQUIRED NUMBER OF SQUARE HEAD SCREWS (ITEM#4) INTO THE DESIGNATED SLOTS IN THE BOTTOM OF THE STEP PLATES.
5. INSTALL THE END CAPS (ITEM #3) AS SHOWN IN (FIG.1), TIGHTENING THE SERRATED NUTS (ITEM#5) TO 5 LB FT.
6. POSITION THE O-MEGA STEP ON THE MOUNTING BRACKETS SO THAT THE SQUARE HEAD SCREWS (ITEM #4) ARE LOCATED IN THE SLOTS OF THE MOUNTING BRACKETS AND THE STEP IS CENTERED, SIDE TO SIDE, ON THE VEHICLE. INSTALL 5/16" SERRATED FLANGE NUTS (ITEM #5) ON THE SQUARE HEAD SCREWS (ITEM #4) AND TIGHTEN TO 19 LB FT.

SERVICE PARTS LIST

ITEM	PART NO.	QTY	DESCRIPTION
1	553069	1	EXTRUSION-AL, 51.00"OMEGA STP, SILVER
1	553057	1	EXTRUSION-AL, 51.00"OMEGA STP, BLACK
2	552970	2	PAD-STEP PLATE, 4.50 X 20.00
3	107956	2	CAP-END,PLSTC,2.95 X 6.70
4	106880	8	SCREW-SQ HD,5/16-18 X 1,MAGNIGUARD
5	102680	8	NUT-SERR FLG,HX,SST,WX,5/16-18
6	107958	12	SCREW-PPH,TEK,#8-18 X 1/2",SST,BZP

INSTALLATION INSTRUCTIONS AND PARTS LIST

APPLICATION:
MODEL 571478 STEP BRACKETS
2014+ RAM PROMASTER VAN



1. READ INSTRUCTIONS COMPLETELY AND CHECK TO MAKE SURE THAT ALL REQUIRED PARTS (LISTED ON SERVICE PARTS LIST) ARE ON HAND BEFORE STARTING THE INSTALLATION.
2. ATTACHING THE BRACKETS TO THE VEHICLE AS SHOWN IN FIG 1:
 - 2.1 LOCATE THE 10MM THREADED STUD FACING FORWARD UNDER THE FRAME RAIL AND REMOVE THE NUT (THIS WILL BE REUSED).
 - 2.2 REMOVE THE SQUARE BODY PLUGS THAT ARE AT THE BOTTOM OF THE FRAME RAILS. **SCRAPE ANY UNDER COATING FROM THE UNDERSIDE OF THE VEHICLE WHERE THE BRACKET IS GOING TO TOUCH**, INSTALL THE T-BOLT INTO THE HOLE (ITEM #5). BOTH SIDES, MAKE SURE THE LONG TAB IS POINTED TOWARDS THE FRONT OF THE VEHICLE.
 - 2.3 INSTALL THE UPPER BRACKETS (ITEMS #3, 4) ON THE T-BOLT, AND THE FACTORY STUD USING THE EXISTING 10MM NUT, AND THE 1/2-13 NUT (ITEM #6). TIGHTEN THESE FASTENERS. BOTH SIDES.
 - 2.4 ATTACH THE LOWER BRACKETS (ITEMS #1, 2) ALONG WITH THE LOAD REACTION STUD BRACKET (ITEM #10) TO THE UPPER BRACKET USING THE SUPPLIED 3/8-16X1.0 BOLTS, WASHER, AND NUTS (ITEMS #7, 8, 9). KEEP THESE LOOSE FOR FINAL ADJUSTMENT.
5. ATTACHING THE STEP TO THE BRACKETS.
PLEASE REVIEW THE INSTALLATION INSTRUCTIONS THAT ARE INCLUDED IN YOUR STEP ASSEMBLY FOR SPECIFIC DETAILS.

SERVICE PARTS LIST

ITEM	PART NO.	QTY	DESCRIPTION
PARTS INCLUDED IN THE BRACKET PACKAGE			
1	552446	1	BRKT-MTG, LOWER REAR, LH,BLK
2	552447	1	BRKT-MTG, LOWER REAR, RH,BLK
3	552448	1	BRKT-MTG, UPPER REAR, LH,BLK
4	552449	1	BRKT-MTG, UPPER REAR, RH,BLK
5	552452	2	T-BOLT WELDMENT, 1/2-13X1.25,ZP
6	104261	2	NUT-HEX FLANGE, 1/2-13,ZP
7	106963	4	SCREW-HEX HEAD, 3/8-16X1.00,SST,BLACK
8	106998	4	WASHER-FLAT, 3/8", SST, BLACK
9	106995	4	NUT-HEX, FLANGE, 3/8-16, SST,BLACK



(A LUVERNE Company)

1200 E. Birch St.

Brandon, SD 57005

REV A 07JAN16
552514 SHEET 1 OF 2 12JUN14

SERVICE PARTS LIST

MODEL NO. - 571478

ROTATE THE T-BOLT WELDMENTS (ITEM #5) SO THE LONG TAB IS TOWARDS THE FRONT OF THE VEHICLE.

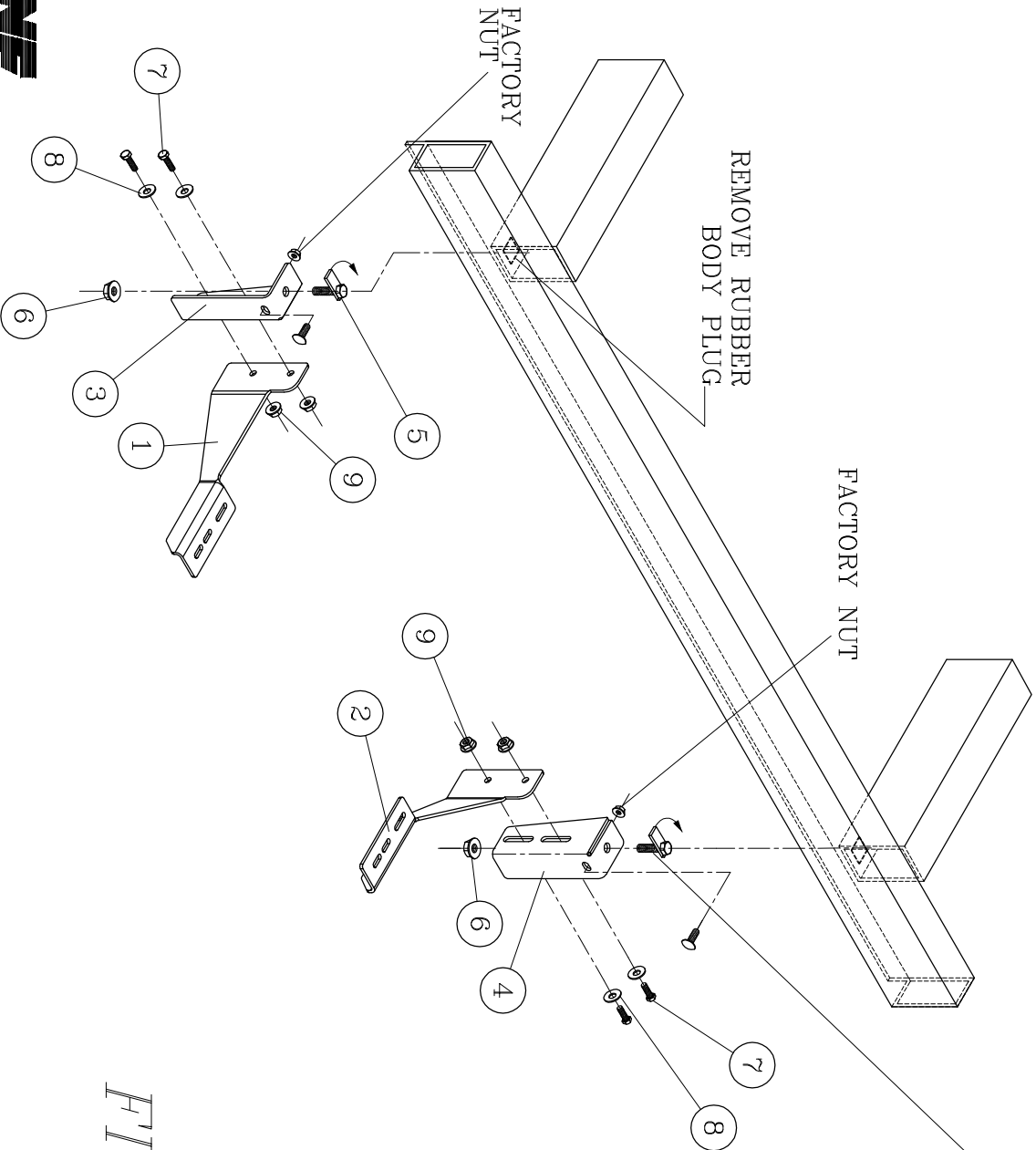

FIG. 1