



GATORBACK

MUDFLAPS

2021-C Tahoe/Suburban/Yukon/Yukon XL
Stainless Steel Mud Flap Set, Rear
Mounting Diagram & Instructions
Kit# GCS206R

IMPORTANT:

Manufacturer is not responsible for negligent use of vehicle with mud flaps installed, including over-tightening of screws and bolts causing damage to vehicle or mud flaps.



TOOLS REQUIRED-

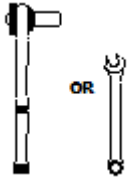

1/4" Open Wrench or
Socket Wrench

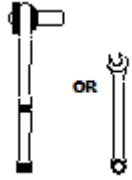

5/16" Open Wrench or
Socket Wrench

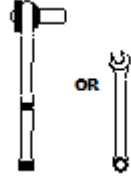

3/8" Open Wrench or
Socket Wrench

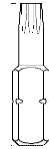

T15 Torx
Bit

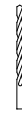

1/4" Drill
Bit

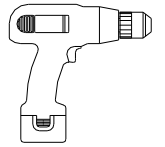

Electric or Rechargeable
Drill

FLAPS

(1) Flap Assy
Front, DS

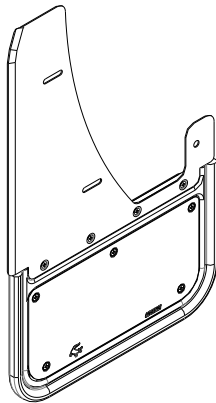

(1) Flap Assy
Front, PS

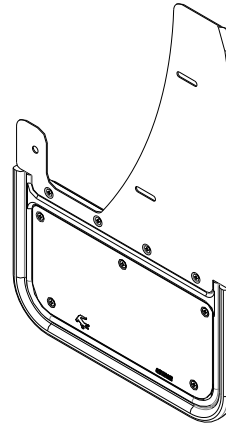

PARTS BAG #770007

a) (2) Screw, Mach, SS
#18-8SS, #10-24 x 1-1/2"
Part #012027

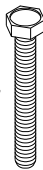

b) (4) Screw, Sht Mtl, SS
1/4" Hex Head #8-18 x 1.25"
Part #016060

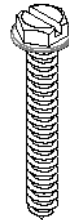

c) (2) Washer, Spacer
7/16" x 1" x 0.25"
Part # 018063

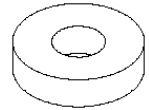

d) (10) Washer, Flat
0.203" x 1", 18g, SS
Part #018081

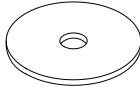

e) (2) Washer, Lock
18-8SS, #10 Helicoil
Part #024001



f) (2) Hex Nut
#10, SS
Part #025003

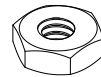

g) (4) Spacer, Nylon
0.257" x 1/2" x 1/2"
Part #054063

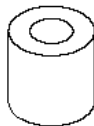

h) (2) Durashield Strip
5/8" x 1"
Part #770020

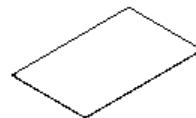

INSTALLATION *(For ease of installation it is suggested that the wheel be removed)*

1. Before you install your Mud Flap Set, see the diagram and parts list for all necessary parts. Start on the driver's side.
2. Remove and discard the factory screws from factory holes #1 & #2. ****Note**** Some models may be equipped with a factory mud guard and filler strip. These must be removed prior to installing your Gatorback Mud Flaps.
3. Ensuring that the mud flap ear is tucked behind the factory liner, loosely install mud flap hole #4 to factory hole #2 using a sheet metal screw (b), and flat washer (d), placing a flat washer (d) and spacer washer (c) between the mud flap and the factory hole (See Diagram).
4. Clean upper section of wheel well with alcohol to prepare for 3M Durashield strip (h). Hold the flap to the vehicle, lining up mud flap hole #3 with factory holes #1. Make a small mark on the place where the top of the mud flap meets the fender lip.
5. Install/center the 3M Durashield strip (h) where you have marked the wheel well.
6. Loosely install mud flap hole #3 to factory hole #1 using a sheet metal screw (b), and flat washer (d), placing a flat washer (d) and nylon spacer (g) between the mud flap and the factory hole. (See Diagram)
7. Using a bubble level or other levelling tool, ensure that the mud flap is level. Tighten fasteners
8. Using a 1/4" drill bit, drill a hole through mud flap hole #5 into the factory liner.
9. Secure mud flap hole #5 to newly drilled hole using a machine screw (a) and flat washer (d), place a nylon spacer (g) between the liner and the mud flap, and secure using a flat washer (d), lock washer (e), and hex nut (f). (See Diagram)
10. Repeat on passenger side.

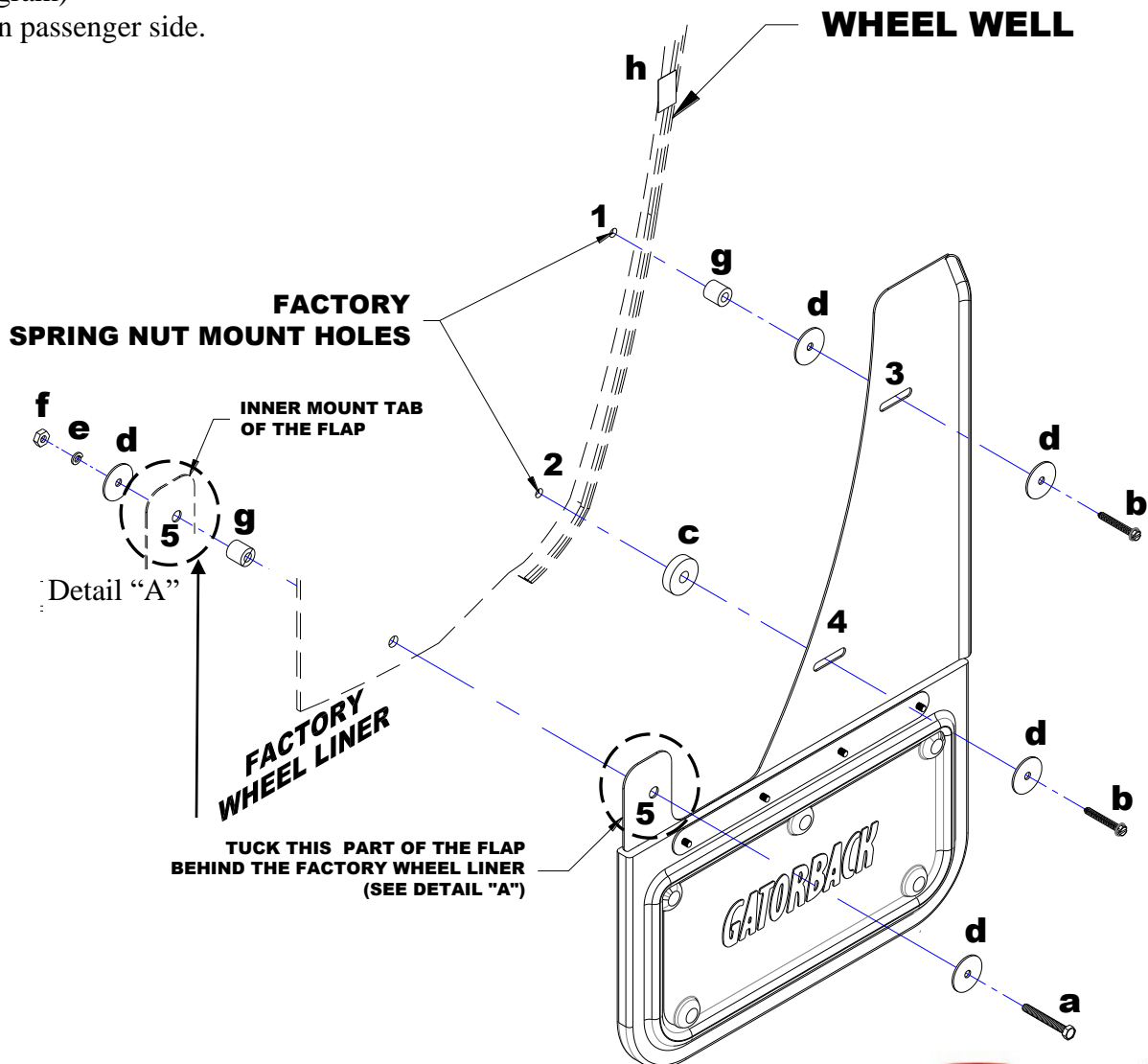

Please check out our YouTube channel to see an install video for this application.

