

IMPORTANT:

Manufacturer is not responsible for negligent use of vehicle with mud flaps installed, including over-tightening of screws and bolts causing damage to vehicle or mud flaps.

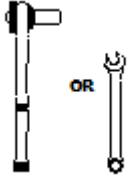

TOOLS REQUIRED-



7/16" Open Wrench or
Socket Wrench

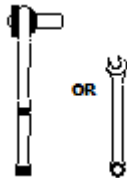

1/2" Open Wrench or
Socket Wrench

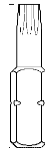

T15
Bit

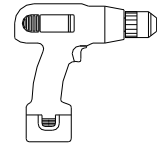

Electric or Rechargeable
Drill

FLAPS

(1) Flap Assembly,
Front, DS

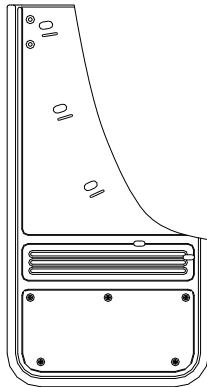

(1) Flap Assembly
Front, PS

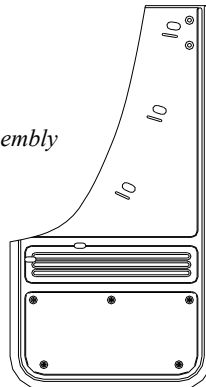

(1) Bracket
Front, DS
Part #771066

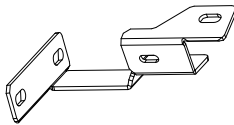

(1) Bracket
Front, PS
Part #771067

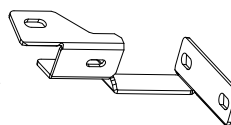

PARTS BAG # 771068

a) (6) Capscrew, SS
1/4"-20 x 5/8" Black Oxidized
Part #014071



b) (4) Capscrew, SS
1/4"-20 x 1" Black Oxidized
Part #014073

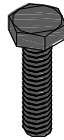

c) (4) Washer, Flat, SS
0.281" x 1" Black Oxidized
Part #018069

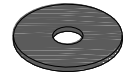

d) (6) Washer, Slotted, SS
0.281" x 1.5" Black Oxidized
Part # 018084



e) (4) Spring Nut, SS
1/4"-20UNC, 27/32" Reach
Part # 028011



f) (3) Mount Clip, SS
Driver Side
Part #769312

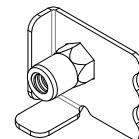

g) (3) Mount Clip, SS
Passenger Side
Part #769313

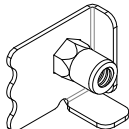

INSTALLATION *(For ease of installation it is suggested that the wheel be removed)*

1. Before you install your Mud Flap Set, see the diagram and parts list for all necessary parts. Start on the driver side.

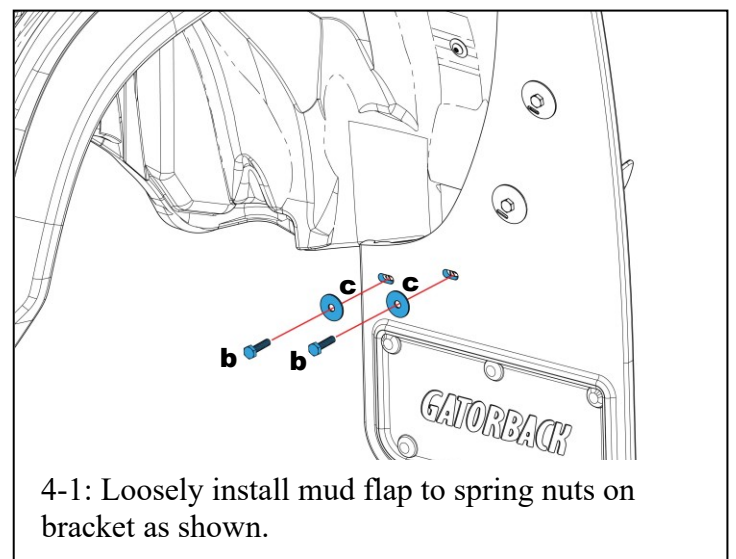
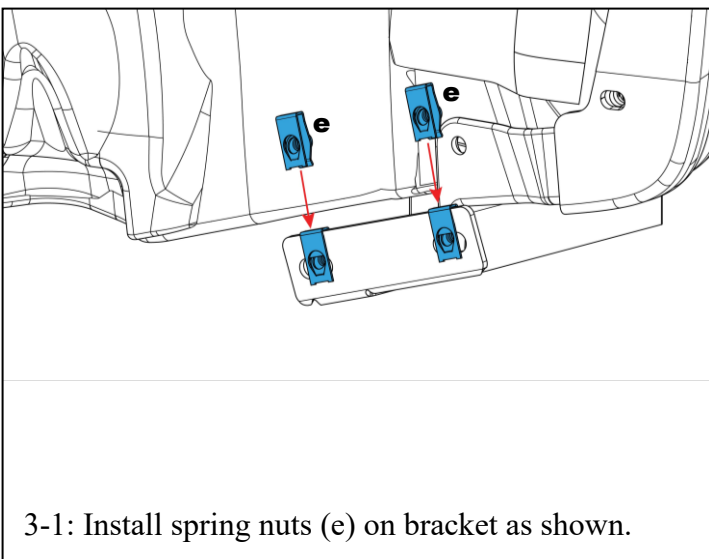
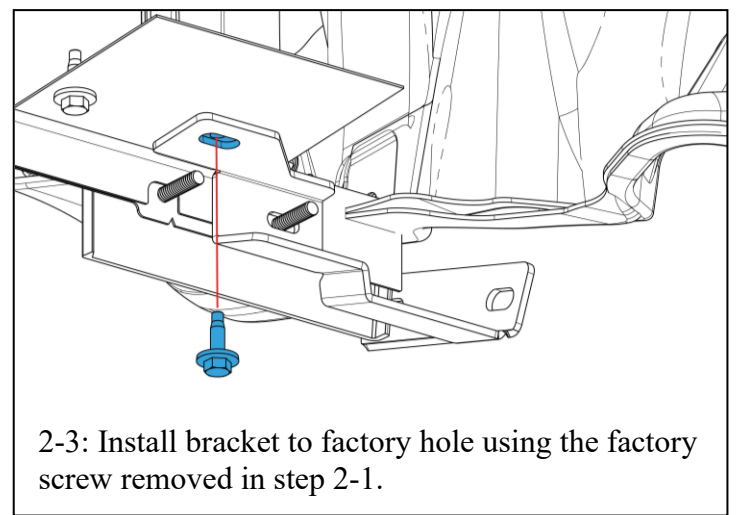
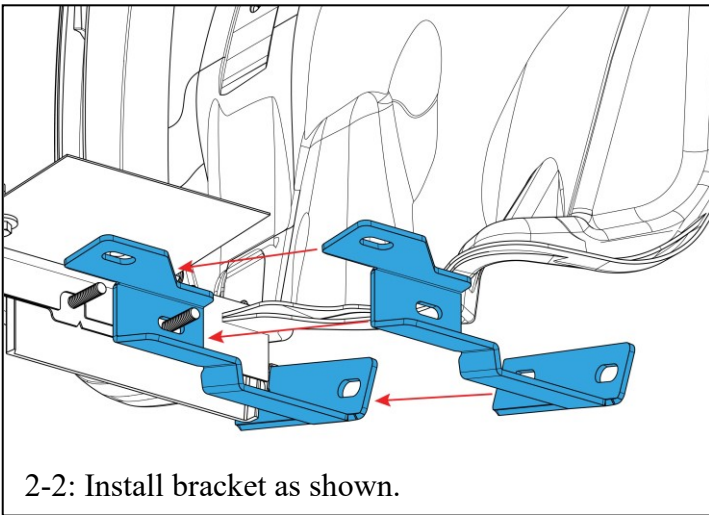
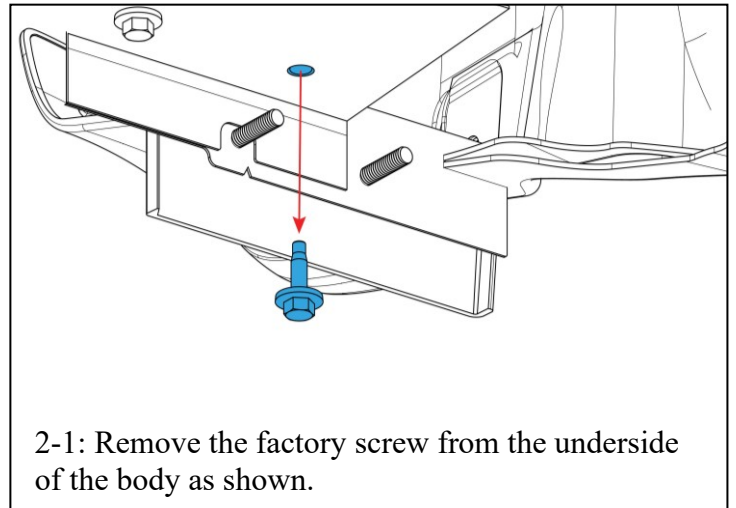
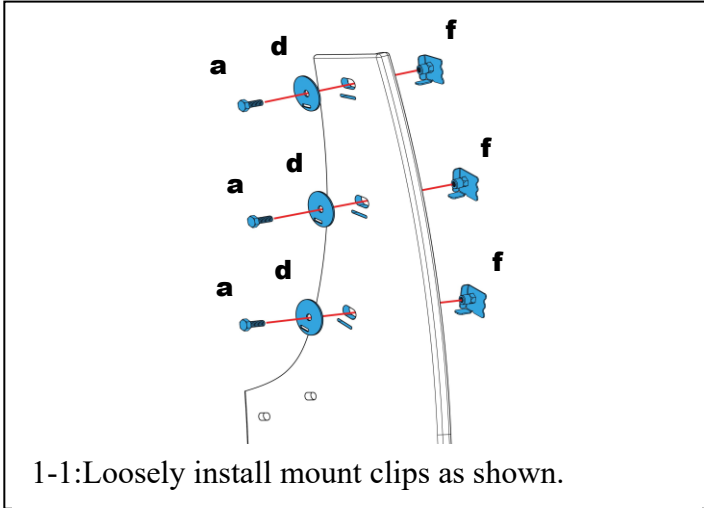

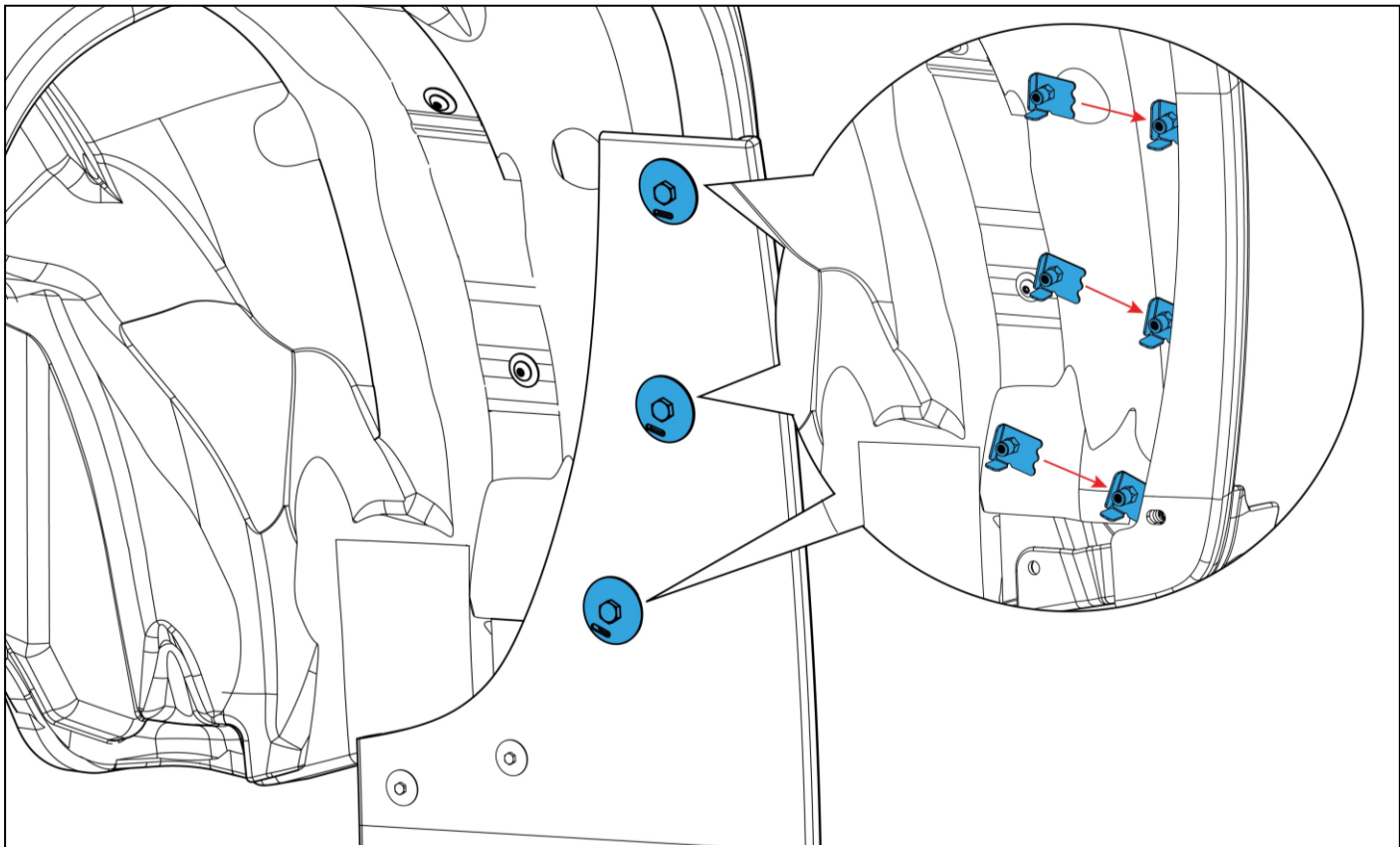

5-1: Slide mount clips behind fender lip.

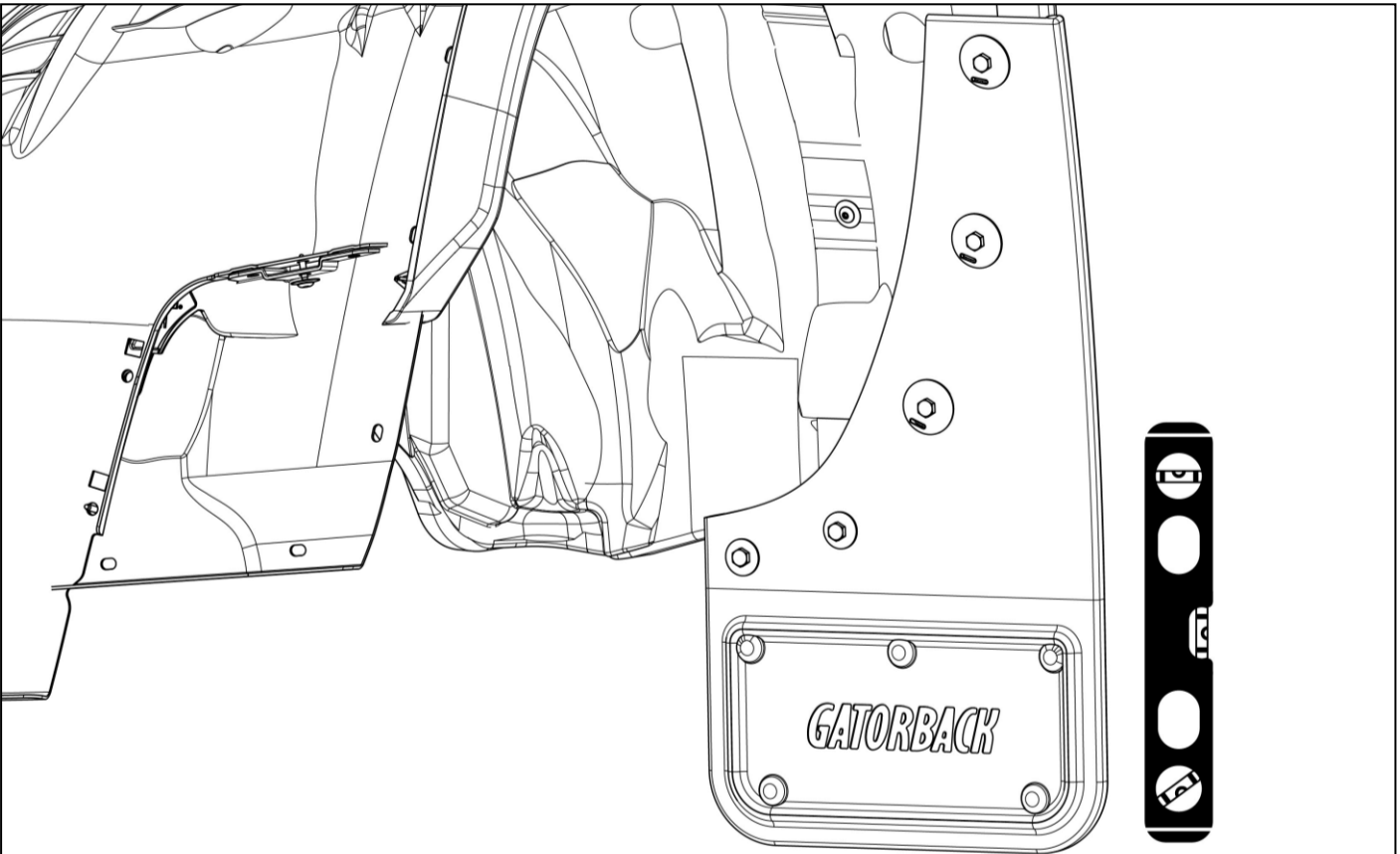

6-1: Using a square or other leveling tool, ensure that the mud flap is level. Tighten all fasteners.

Please check out our YouTube channel to see an install video for this application.





2023-C GMC Canyon
Mud Flap Set, Rear
Mounting Diagram & Instructions
Kit# GCR212R

IMPORTANT:

Manufacturer is not responsible for negligent use of vehicle with mud flaps installed, including over-tightening of screws and bolts causing damage to vehicle or mud flaps.



TOOLS REQUIRED-

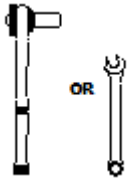

7/16" Open Wrench or
Socket Wrench

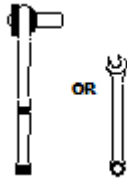

1/4" Open Wrench or
Socket Wrench

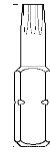

T15
Bit

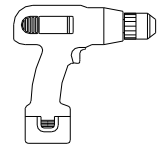

Electric or Rechargeable
Drill

FLAPS

(1) Flap Assembly,
Rear, DS

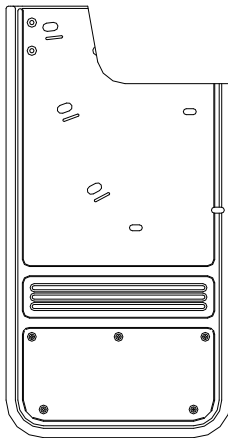

(1) Flap Assembly
Rear, PS

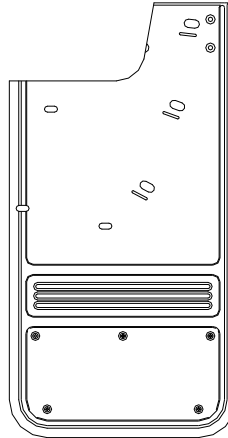

PARTS BAG # 771069

a) (6) Capscrew, SS
1/4"-20 x 5/8" Black Oxidized
Part #014071



b) (6) Sheet Metal Screw, SS
8-18 x 1" Black Oxidized
Part #016055



c) (6) Washer, Flat, SS
0.203" x 1" Black Oxidized
Part #018070

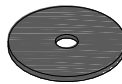

d) (6) Washer, Slotted, SS
0.281" x 1.5" Black Oxidized
Part # 018084



e) (3) Mount Clip, SS
Driver Side
Part #769312

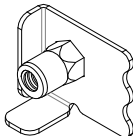

f) (3) Mount Clip, SS
Passenger Side
Part #769313

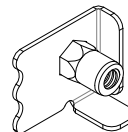

INSTALLATION *(For ease of installation it is suggested that the wheel be removed)*

Before you install your Mud Flap Set, see the diagram and parts list for all necessary parts. Start on the driver's side.

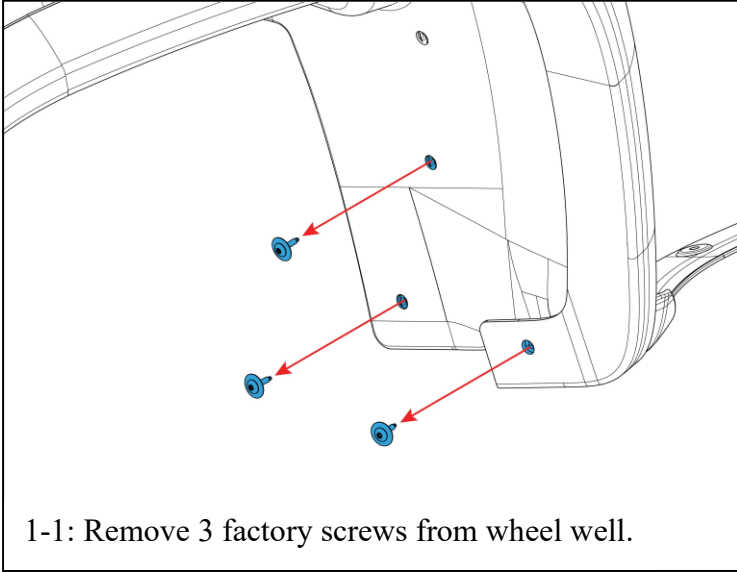

1-1: Remove 3 factory screws from wheel well.

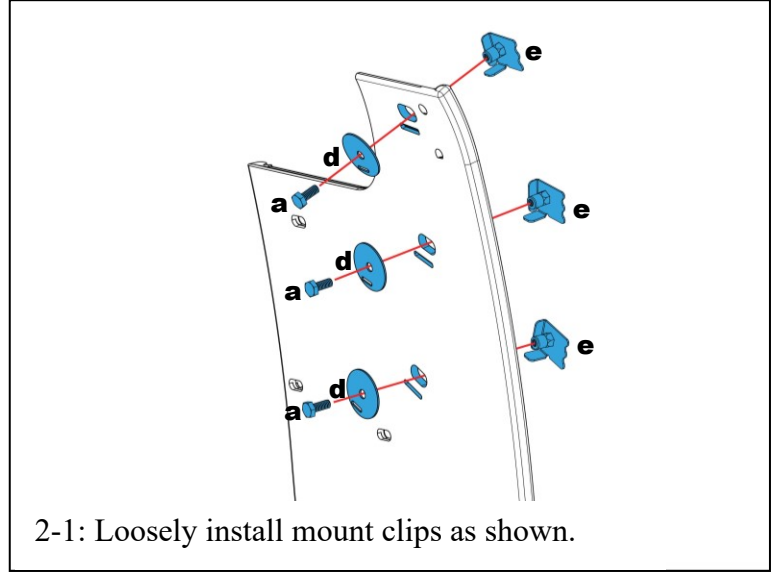

2-1: Loosely install mount clips as shown.

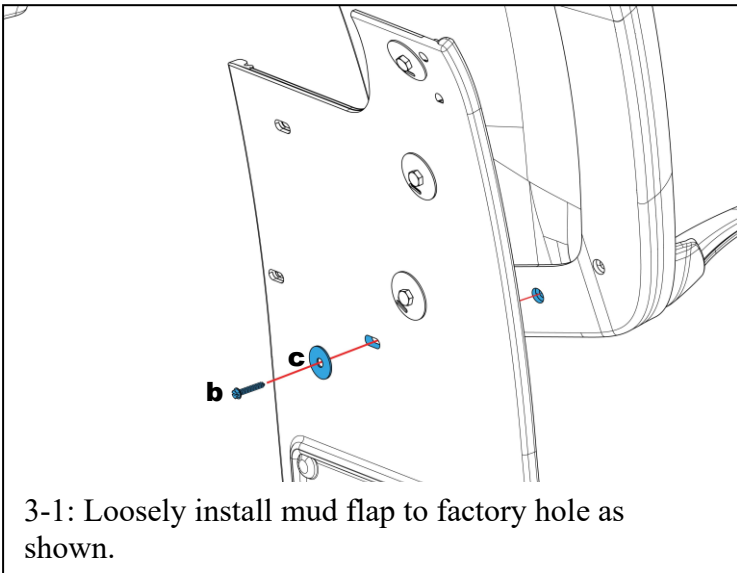

3-1: Loosely install mud flap to factory hole as shown.

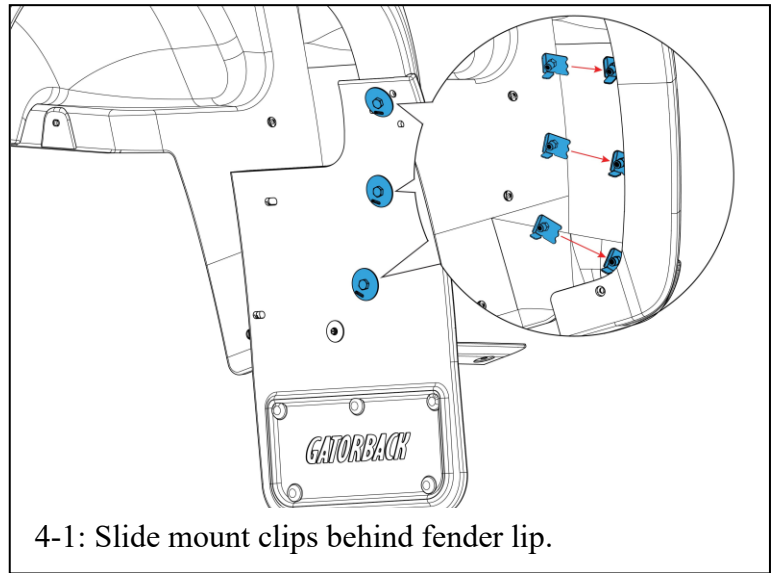

4-1: Slide mount clips behind fender lip.

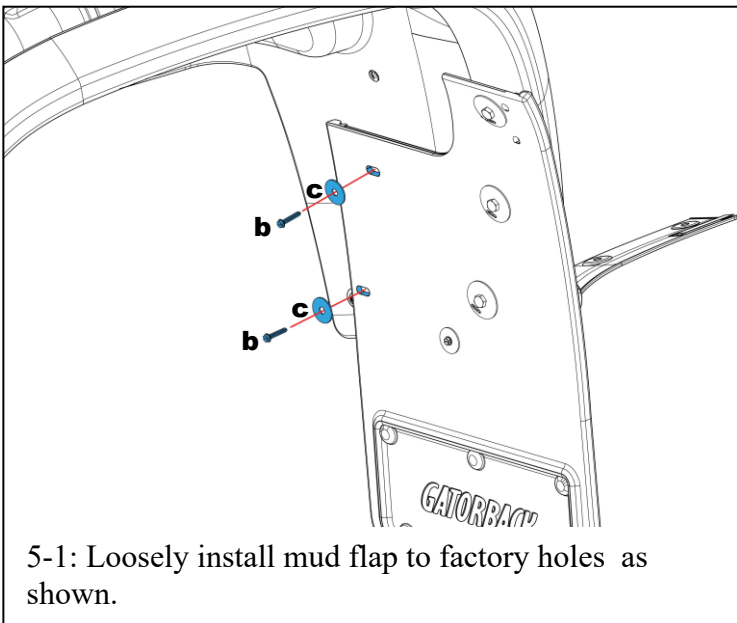

5-1: Loosely install mud flap to factory holes as shown.

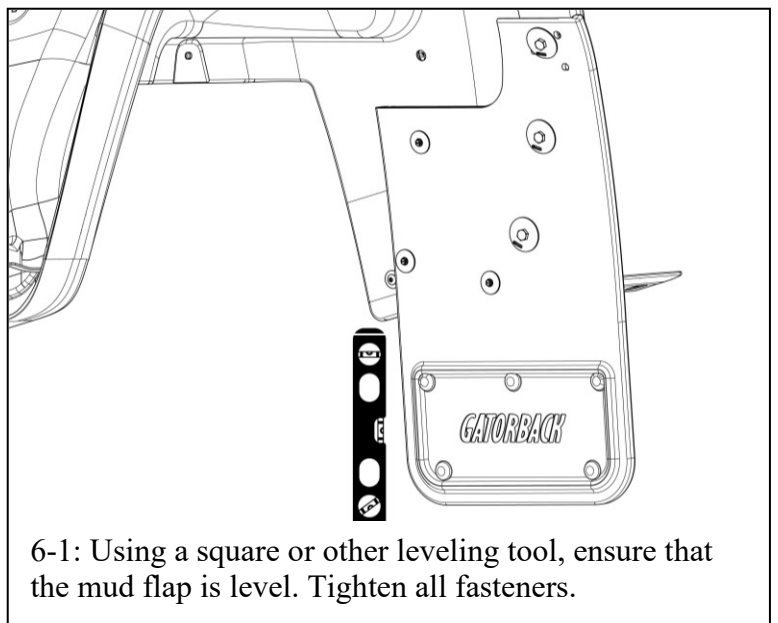

6-1: Using a square or other leveling tool, ensure that the mud flap is level. Tighten all fasteners.

Please check out our YouTube channel to see an install video for this application.

