

# INSTALLATION INSTRUCTIONS

Sportsman and Sportsman X Grille Guard



**APPLICATION:**

2012– 2019 Nissan Frontier

**PART NUMBER:**

40-2075, 45-2070, 40-32075

ITEM	QUANTITY	DESCRIPTION	TOOLS NEEDED
1	1	GRILLE GUARD	RATCHET
2,3	2	LOWER BRACKET (DRIVER & PASSENGER)	ALLEN KEY
4,5	2	UPPER SUPPORT STRAP (DRIVER & PASSENGER)	16mm SOCKET
6	2	M10-1.50 NUT PLATE	17mm SOCKET
7	2	SHORT SPACER	18mm SOCKET
8	2	M10-1.50 x 45mm HEX HEAD CAP SCREW (Yellow Zinc)	16mm WRENCH
9	2	M10 FLAT WASHER (Yellow Zinc)	17mm WRENCH
10	2	M10 LOCK WASHER (Yellow Zinc)	18mm WRENCH
11	2	M10-1.50 x 30mm HEX SOCKET BUTTON HEAD SCREW (S/S) *	TORQUE WRENCH
12	2	M10 CUPPED WASHER (S/S) *	
13	2	M10-1.50 SERRATED FLANGE NUT (S/S) *	
14	6	M12-1.75 x 30mm HEX SOCKET BUTTON HEAD SCREW (S/S) *	
15	6	M12 CUPPED WASHER (S/S) *	
16	6	M12 SERRATED FLANGE NUT (S/S) *	
17	4	M12-1.25 x 35mm HEX HEAD CAP SCREW (Yellow Zinc)	
18	4	M12 LOCKWASHER (Yellow Zinc)	
19	4	M12 FLAT WASHER (Yellow Zinc)	

(S/S)= STAINLESS STEEL, \*=FOR 40-2075 BLACK ZINC PLATED S/S

**ANTI-SEIZE LUBRICANT MUST BE USED ON ALL STAINLESS STEEL FASTENERS TO PREVENT THREAD DAMAGE AND GALLING.**

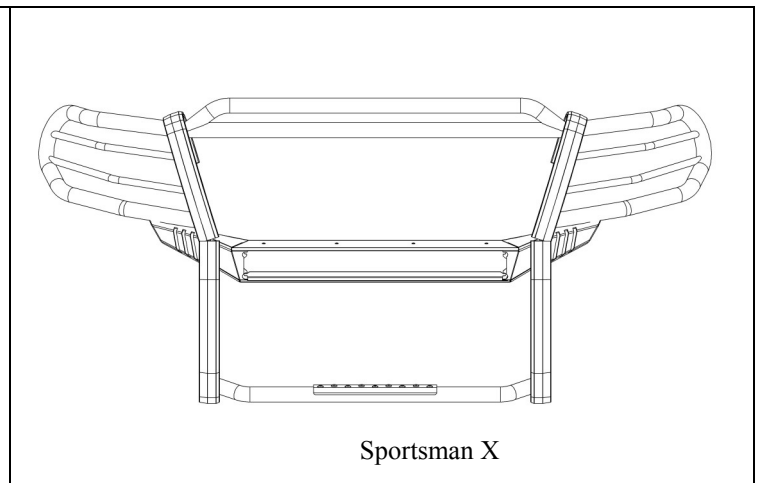
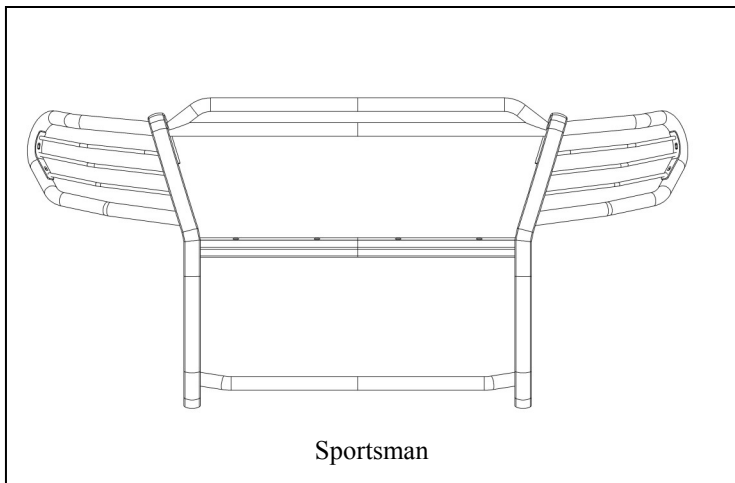

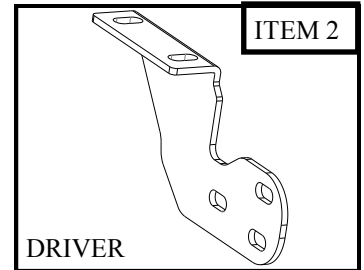
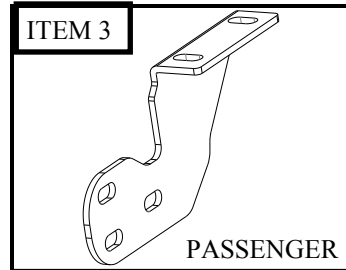
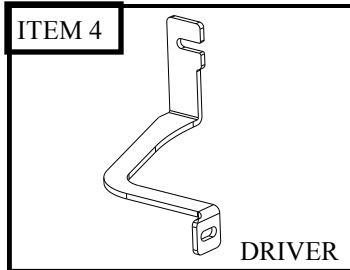
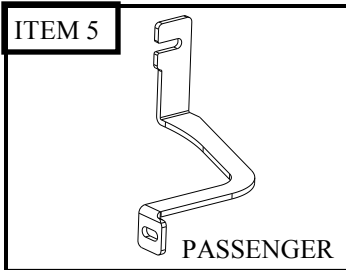

### PROCEDURE

1. Remove contents from box, verify if all parts listed are present and free from damage.  
Carefully read and understand all instructions before attempting installation.  
**Failure to identify damage before installation could lead to a rejection of any claim.**
2. On the front of the vehicle, locate on the underside of the vehicle frame the body chassis that has two threaded holes per side. (Figure 1) *Note: If equipped remove the factory tow hooks. Tow hooks cannot be re-used.*
3. Loosely attach the Lower Brackets (item 2 &3) to each side of the frame, using (4) M12 fine thread hex head cap screws (item 17), (4) M12 lock washers (item 18), and (4) M12 flat washers (item 19). (Figure 2)

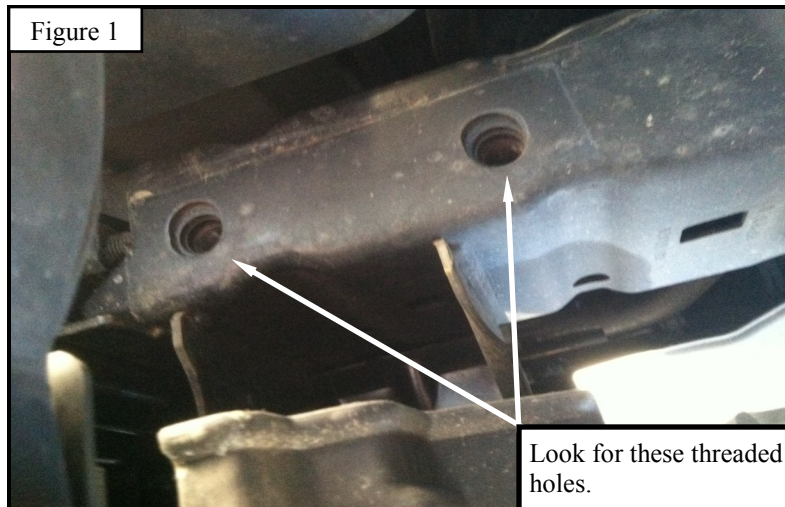

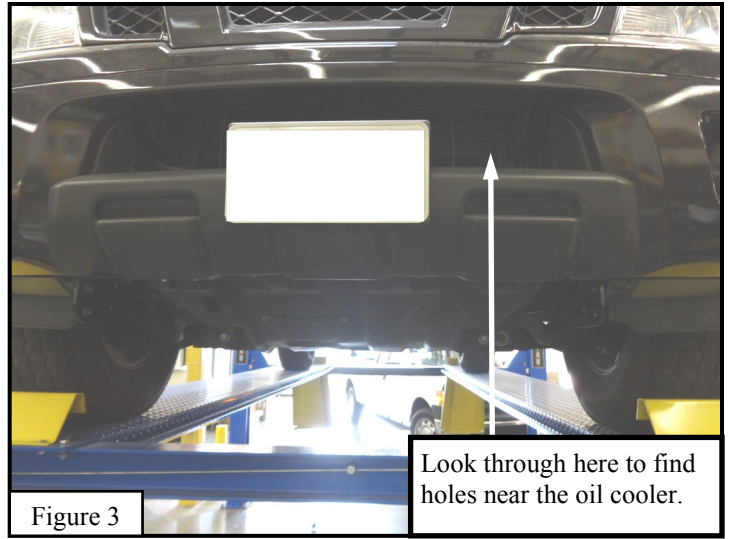
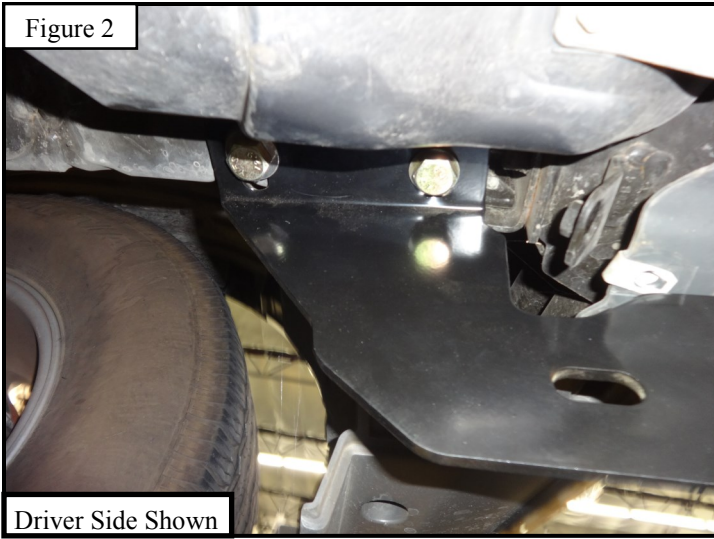

4. Proceed to locate through the front bumper, under the oil coolers, a set of holes. (Figures 3 & 4)
5. Through the back side of the holes attach loosely the M10 nut plates (item 6) then proceed to install per side, (1) short spacer (item 7), (1) M10 flat washer (item 9), (1) M10 lock washer (item 10), and (1) M10 hex head cap screw (item 8). (Figures 4 & 5)

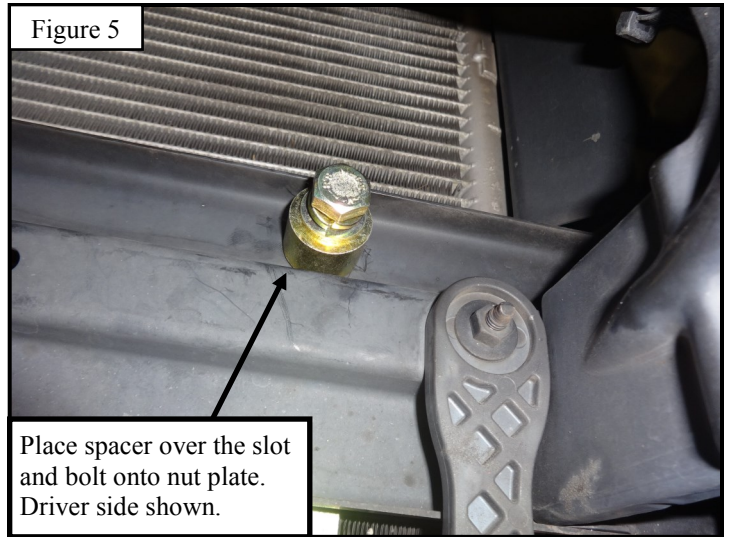
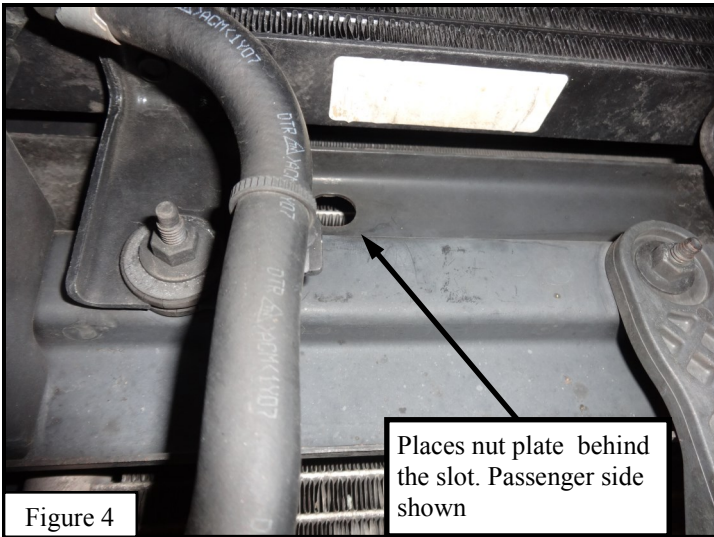

6. In between items 5 and item 7 on the previously attached spacers, slide the fork side of the upper support strap (items 2 & 3) to both driver and passenger side. (Figure 6)



Figure 6

Slide fork side of the bracket here.

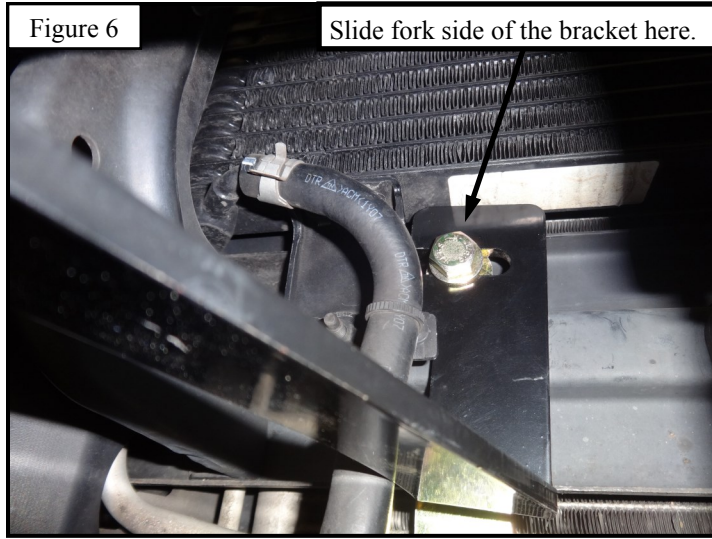

7. Align the Sportsman Grille Guard (item 1) to the bottom brackets so that the brackets align inside the grille guard. Attach to the bottom brackets using (6) M12 hex socket button head screws (item 14), (6) M12 cupped washers (item 15), and (6) M12 serrated flange nuts (item 16).
8. To attach top support brackets use (2) M10 hex socket button head screw (item 11), (2) M10 cupped washers (item 12), and (2) M10 serrated flange nuts (item 13). (Figures 7, 8 & 9)
9. Adjust the grille guard as necessary and tighten all M10 bolts to 25 to 30 ft-lbs and all M12 to 50-55 ft-lbs.

Figure 7

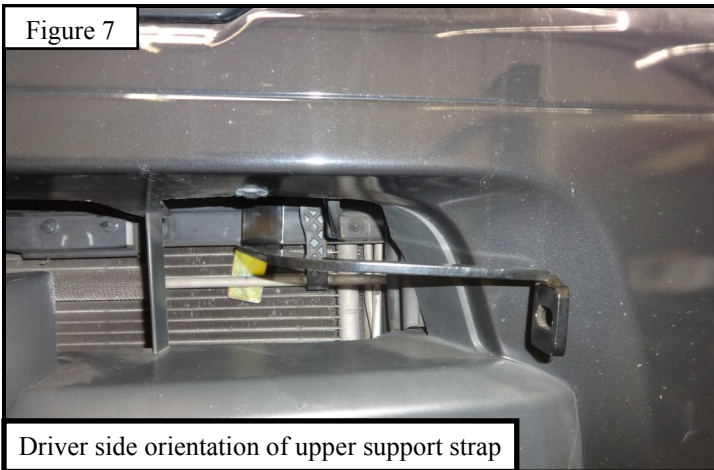

Driver side orientation of upper support strap

Figure 8

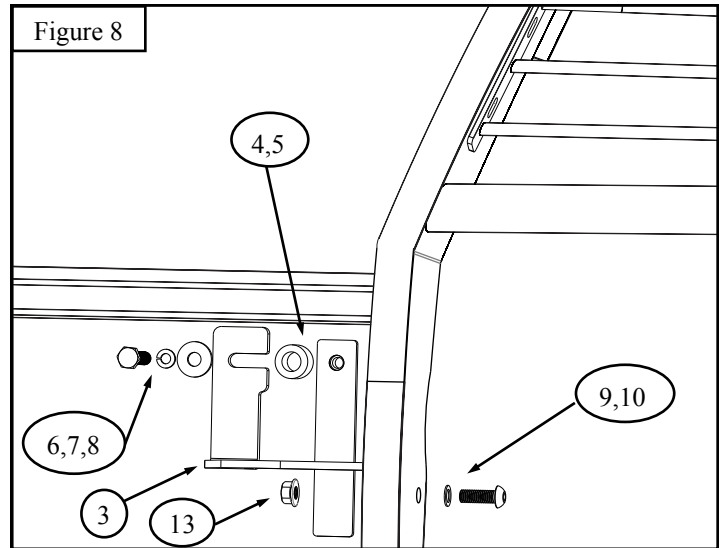

Westin Automotive Products, Inc.  
 320 W. Covina Blvd  
 San Dimas, Ca. 91773

Thank You for choosing Westin products  
 For Additional installation assistance please call  
 Customer service (800) 793-7846  
[www.westinautomotive.com](http://www.westinautomotive.com)

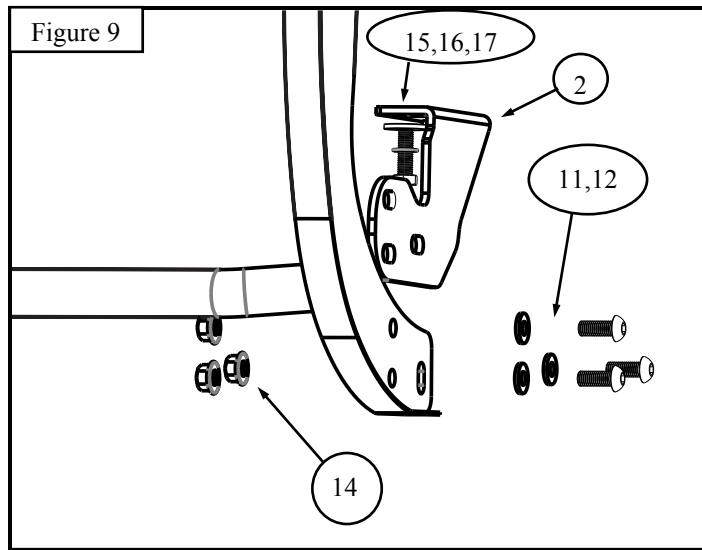

INSTALLATION COMPLETE



**CARE INSTRUCTIONS**

- REGULAR WAXING IS RECOMMENDED. DO NOT USE ANY TYPE OF POLISH OR WAX THAT MAY CONTAIN ABRASIVES.
- STAINLESS STEEL PRODUCTS CAN BE CLEANED WITH MILD SOAP AND WATER. STAINLESS STEEL POLISH SHOULD BE USED TO POLISH SMALL SCRATCHES.
- GLOSS BLACK FINISHES SHOULD BE CLEANED WITH MILD SOAP AND WATER.

**WESTIN** Westin Automotive Products, Inc.  
320 W. Covina Blvd  
San Dimas, Ca. 91773

Thank You for choosing Westin products  
For Additional installation assistance please call  
Customer service (800) 793-7846  
[www.westinautomotive.com](http://www.westinautomotive.com)



## WARNING



Failure to follow these instructions could lead to death, personal injury, and / or property damage.

Failure to follow these instructions could lead to death, personal injury, and / or property damage.

### FASTENERS:

All Westin supplied fasteners must be utilized and installed in accordance with the installation instructions and apply torque to the specifications as defined. **DOUBLE CHECK ALL FASTENERS BEFORE INITIAL USE, AND PERIODICALLY IN THE FUTURE TO ENSURE PROPER FUNCTION AND SAFETY.**

### DRILLING:

Most Westin products do not require drilling for installation. If drilling is defined as required, use caution when drilling a vehicle. **FAILURE TO REVIEW AN AREA TO BE DRILLED MAY RESULT IN PERSONAL INJURY AND/OR INJURY TO OTHERS AS WELL AS VEHICLE DAMAGE.**

### EYE PROTECTION:

**ALWAYS WEAR SAFETY GLASSES OR GOGGLES DURING THE INSTALLATION PROCESS TO AVOID PERSONAL INJURY.**

### MAXIMUM TOWING/CARRYING CAPACITY: (if applicable)

The Westin Receiver Hitches will have a visible tow rating label affixed directly on the product. User should never exceed the vehicle manufacturers maximum tow and weight rating regardless of the capacity of the hitch. **FAILURE TO FOLLOW THESE GUIDELINES WILL VOID THE WESTIN WARRANTY AND MAY RESULT IN PERSONAL INJURY AND/OR INJURY TO OTHERS AS WELL AS VEHICLE DAMAGE.**

### FOR CALIFORNIA RESIDENTS ONLY-PROP 65 WARNING:

Some products may contain chemicals such as DEHP, which can cause cancer, birth defects or other reproductive harm. For more info go to [www.p65warnings.ca.gov](http://www.p65warnings.ca.gov)