

IMPORTANT:

Manufacturer is not responsible for negligent use of vehicle with mud flaps installed, including over-tightening of screws and bolts causing damage to vehicle or mud flaps.



TOOLS REQUIRED-



Phillips Screw Driver



Push Pin Removal Tool

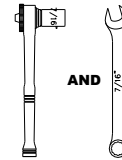

10mm Open Wrench and
Socket Wrench

FLAPS & BRACKETS

(1) Flap Assembly,
Front, DS
Part #766515

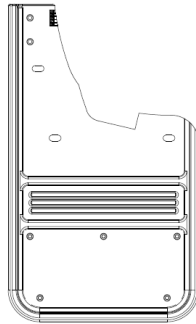

(1) Flap Assembly
Front, PS
Part #766516

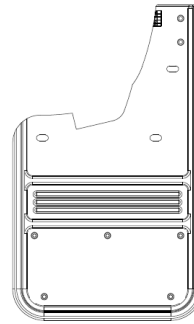

(2) Front Brace
Part #766512

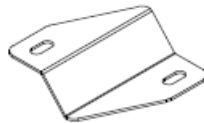

(2) Front Washer Plate
Part #766513

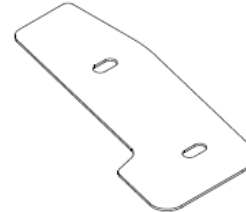

PARTS BAG # 766514

a) (4) Screw, Sht Metal
SS, #14-10 x 1"
Part #010048



b) (2) Screw, Mach.
SS, M6-35mm, Hex
Part #012028



c) (10) Washer, Flat
0.281" x 1", SS
Part #018028



d) (2) Washer, Lock
18-8SS, 1/4"
Part #024000



e) (2) Nut, Hex
SS, M6-1
Part # 025022



g) (4) Washer, Nylon
1"OD x 0.318"ID x 0.04"
Part # 054061

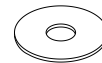

INSTALLATION *(For ease of installation it is suggested that the wheel be removed)*

1. Before you install your Mud Flap Set, see the diagram and parts list for all necessary parts.
2. Remove the factory screws on the inner fender and push pin on the underside of the mud flap. Remove the factory mud flap and reinstall the factory push pin.
3. Loosely install the front brace to the inner hole #1 of the mud flap, through the bottom hole #2 on the brace using (1) machine screw #012028, (2) stainless steel washers #018028, (1) lock washer #024000, and (1) hex nut #025022. (See Diagram.)
4. Loosely install the front brace to the inner most wheel well factory hole through the upper hole #3 on the brace, using a factory screw and (1) stainless steel washer #018028.
5. Loosely attach the mud flap and washer plate through holes #4 & #5 using (2) stainless steel washers #018028, (2) nylon washers #054061, and (2) sheet metal screws #010048.
6. Using a bubble level or square, ensure that the mud flap is level. Viewing the truck from the back, the outer edge of the mud flap should appear parallel to the tires
7. Carefully tighten all fasteners (do not overtighten, as this can strip the factory plastic inserts), ensuring that the mud flap remains level.
8. Repeat procedure for the passenger side.

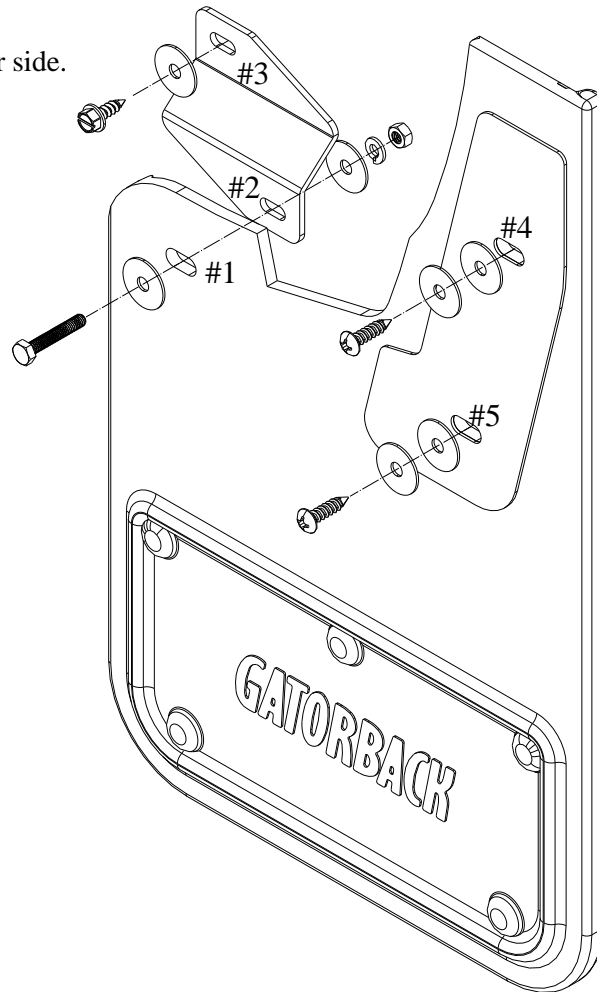

Please check out our YouTube channel to see an install video for this application.

