



**2020-2023 Sierra HD
Mud Flap Set, Rear
Mounting Diagram & Instructions
Kit# GCR200R**

TO BE USED WITH SILVERADO CAP PART #FC004R

IMPORTANT:

Manufacturer is not responsible for negligent use of vehicle with mud flaps installed, including over-tightening of screws and bolts causing damage to vehicle or mud flaps.

TOOLS REQUIRED-

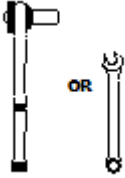

7/16" Open Wrench or
Socket Wrench

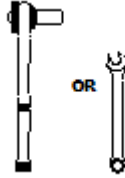

1/4" Open Wrench or
Socket Wrench



T15 Torx
Bit

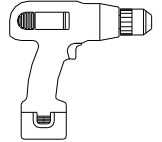

Electric or Rechargeable
Drill

FLAPS

(1) Flap Assy
Rear, DS

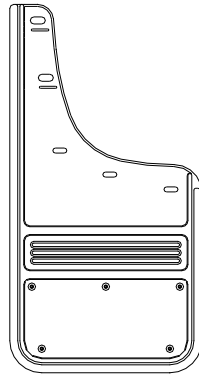

(1) Flap Assy
Rear, PS

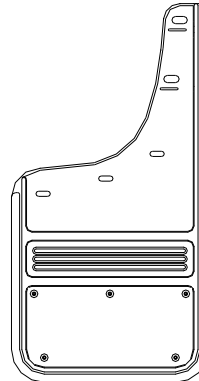

PARTS BAG #770667

a) (4) Capscrew, Blk Ox
1/4"-20UNC x 3/4"
Part # 014070

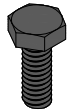

b) (6) Screw, Blk Ox..
1/4" Hex Head, #8-18x1.5"
Part #016063



c) (6) Washer, Flat
0.203" x 1.5" SS Blk Ox
Part #018080



d) (4) Washer, Flat
0.281" x 1.5" Blk Ox.
Part #018084



e) (2) Mud Flap Clip
Driver Side
Part # 769312

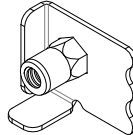

f) (2) Mud Flap Clip
Passenger Side
Part #769313

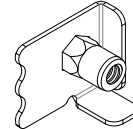

For Finishing Cap Installation:

g) (4) Screw, Blk Ox.
1/4" Hex Head, #8-18x1"
Part #016055



h) (4) Washer, Flat
0.203" x 0.781" Blk Ox.
Part #018085

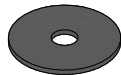

FINISHING CAPS FC004R:

(1) Finishing Cap
Driver's Side

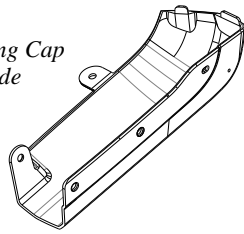

(1) Finishing Cap
Passenger's Side

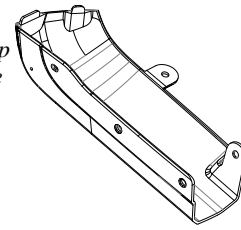

INSTALLATION *(For ease of installation it is suggested that the wheel be removed)*

CAPS:

1. Remove the 5 factory screws from the existing factory guard.
2. Gently pull the guard from the truck.
3. Position cap, ensuring the top lip of the cap slides under the fender molding as shown.
4. Install the underside and back of the finishing cap to the factory holes using a screw (g) and flat washer (h). Be careful not to overtighten.
5. Repeat procedure on passenger side.

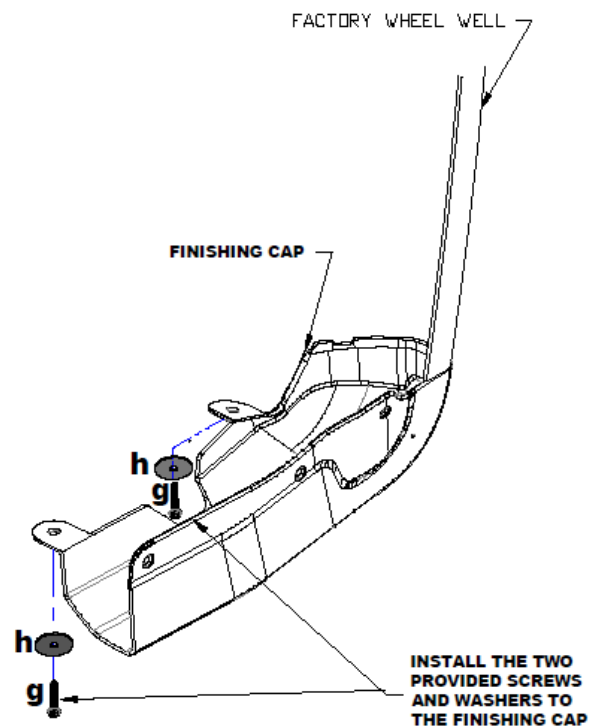
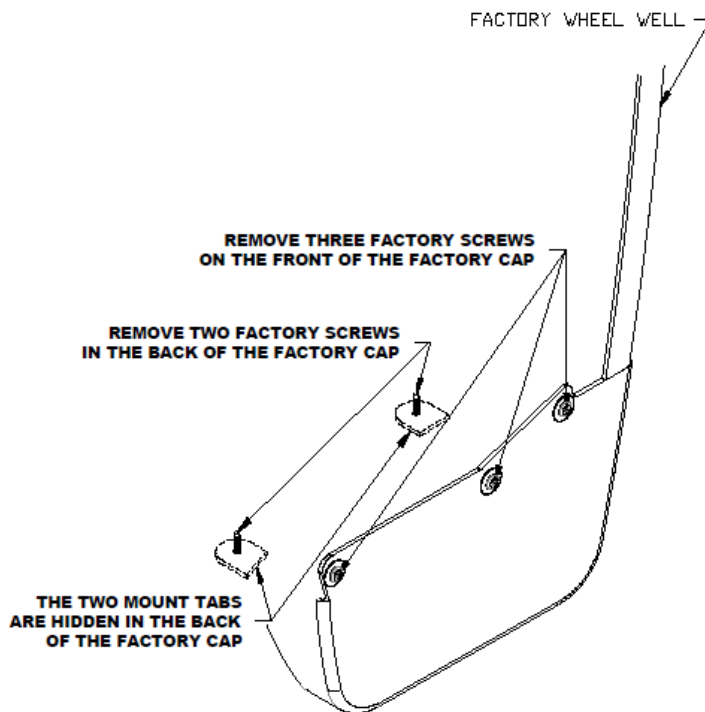

*Universal Instructions: Diagram of parts may vary due to application differences.

Please check out our YouTube channel to see an install video for this application.



MUD FLAPS:

1. Before you install your Mud Flap Set, see the diagram and parts list for all necessary parts. Start on the driver's side.
2. Loosely install mount clip (e) to mud flap holes #1 & #2 using a cap screw (a) and flat washer (d)
3. Loosely secure mud flap hole #3 to finishing cap hole #6 using screw (b) and flat washer (c)
4. Secure mount clips (e) on holes #1 & #2 behind fender lip. *Note* Ensure all factory holes line up with finishing cap holes.
5. Secure mud flap through holes #4 & #5 into finishing cap hole #7 & #8 using supplied screw (b), and washer (c).
6. Using a bubble level or other levelling tool, ensure that the mud flap is level. Tighten fasteners, being careful not to overtighten.
7. Repeat procedure for passenger side.

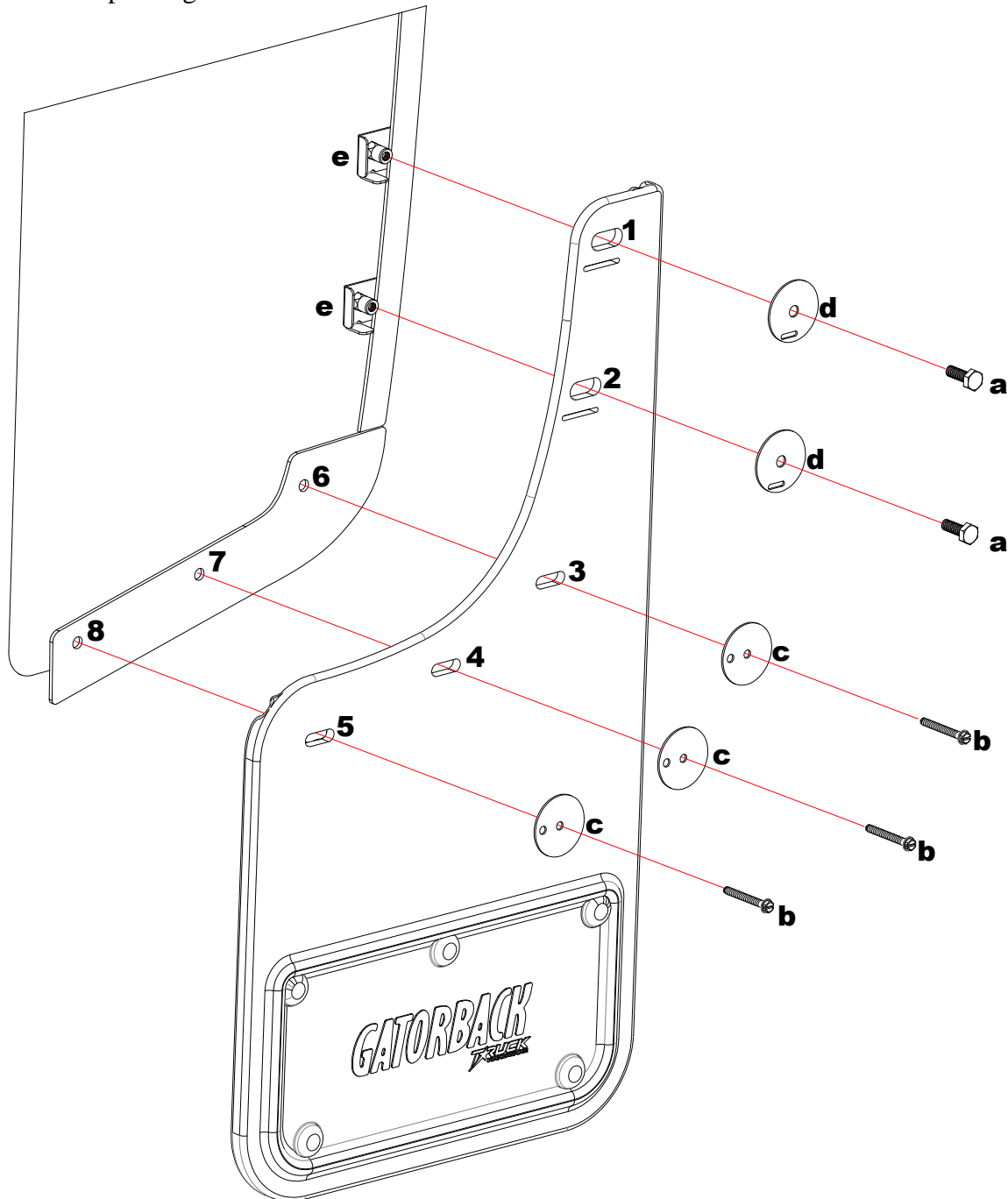

Please check out our YouTube channel to see an install video for this application.



Sierra Rear