



**2020 GMC Sierra HD**  
**2" Offset Mud Flap Set, Front**  
**Mounting Diagram & Instructions**  
**Kit# GCS200F**

**IMPORTANT:**

*Manufacturer is not responsible for negligent use of vehicle with mud flaps installed, including over-tightening of screws and bolts causing damage to vehicle or mud flaps.*



**TOOLS REQUIRED-**

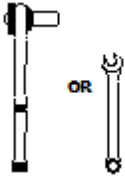

7/16" Open Wrench or  
Socket Wrench



1/4" Socket Driver  
Bit



T15 Torx

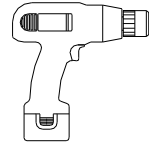

Electric or Rechargeable  
Drill



**\*Note\*** These flaps are meant for use with the Factory Protector Only. They are NOT meant for use with the Factory Splash Guard.

**FLAPS**

(1) Flap Assy  
Front, DS

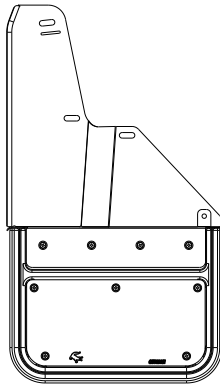

(1) Flap Assy  
Front, PS

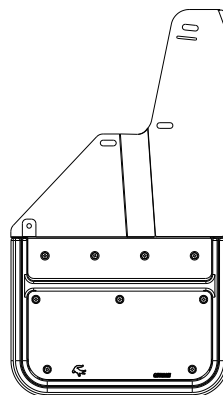

**PARTS BAG # 768389**

**a)** (2) Washer, Flat  
0.281" x 1", 18g, SS,  
Part #018028

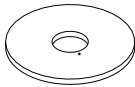

**b)** (4) Washer, Flat  
0.203" x 1", 18g, SS,  
Part #018081

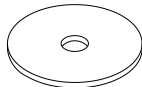

**c)** (2) Washer, Flat  
0.437" x 1", Nylon  
Part #054091



**d)** (2) Cap Screw, SS  
1/4"-20UNC x 5/8"  
Part #014006

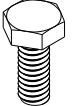

**e)** (4) Screw, Sheet Metal, SS  
1/4" Hex Washer Head, #8-18x1"  
Part # 016054

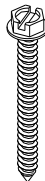

**f)** (1) Mud Flap Clip  
Driver Side  
Part # 768157

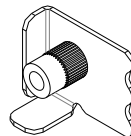

**g)** (1) Mud Flap Clip  
Passenger Side  
Part #768158

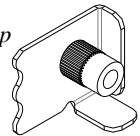

## INSTALLATION *(For ease of installation it is suggested that the wheel be removed)*

1. Before you install your Mud Flap Set, see the diagram and parts list for all necessary parts. Start on the driver's side.
2. Remove factory screw from wheel well holes #5 & #6.
3. Loosely install mount clip (f) on mud flap hole #1 using a cap screw (d), stainless steel washer (a), and nylon washer (c).
4. Tuck the offset tab #4 underneath the factory plastic cap until the tab is fully engaged inside the factory plastic cap
5. Loosely secure mud flap through hole #2 into factory hole #5 using supplied sheet metal screw (e) and stainless steel washer (b).
6. Install mount clip (f) on hole #1 behind the fender lip.
7. Loosely secure mud flap through hole #3 into hole #6 using supplied screw (e) and washer (b).
8. Using a bubble level or other levelling tool, ensure that the mud flap is level. Tighten fasteners.
9. Repeat procedure for passenger side.

