



i-LOCK[®] Electronic Cam Lock – 10 Button

E902

- 10 button electronic lock
- Simple touch screen entry
- 1 to 15 digit user defined code
- Clutch Knob
- Two Versions
 - i Standard use - Enter a user code and it remains until reset
 - ii One time use - Enter code to lock and unlock only once
- Button cell battery with up to one year life (CR2032)
- Optional battery pack
- Audible alarm when incorrect code is entered 4 times
- Low power alarm – Audible signal sounds when 300 cycles remain

Material and Finish

- Housing: Zinc Diecast
- Silver Powder Coat



Rev 0
03/31/2016

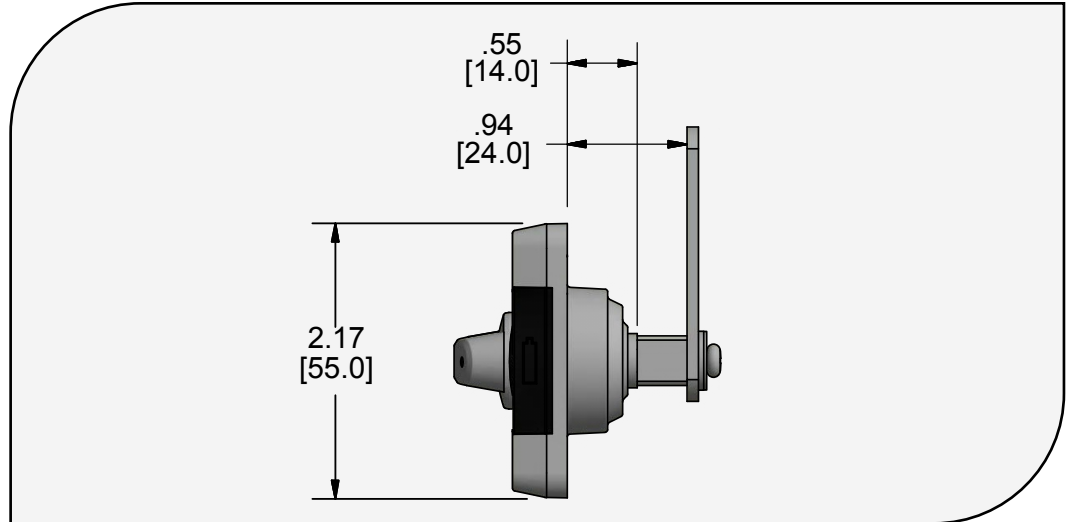

Horizontal		
Part Number	Use	Color
E902RSS	Standard	Silver
E902R1S	One-Time	Silver

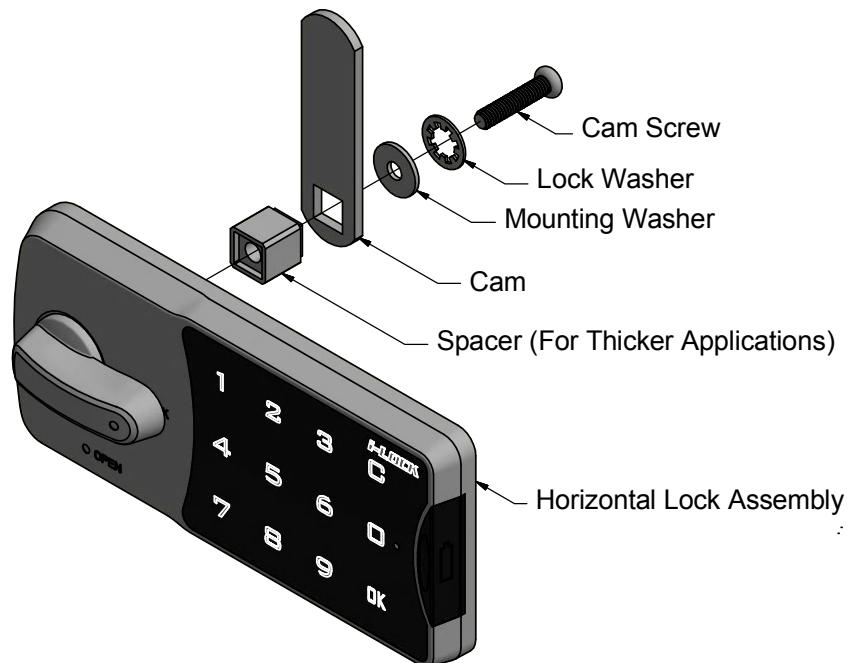

Illinois Lock Company
A division of the Eastern Company

www.illinoislock.com • sales@illinoislock.com • 847-537-1800



i-LOCK[®] Electronic Cam Lock – 10 Button

E902

Material and Finish

- Housing: Silver ABS plastic
- Zinc diecast

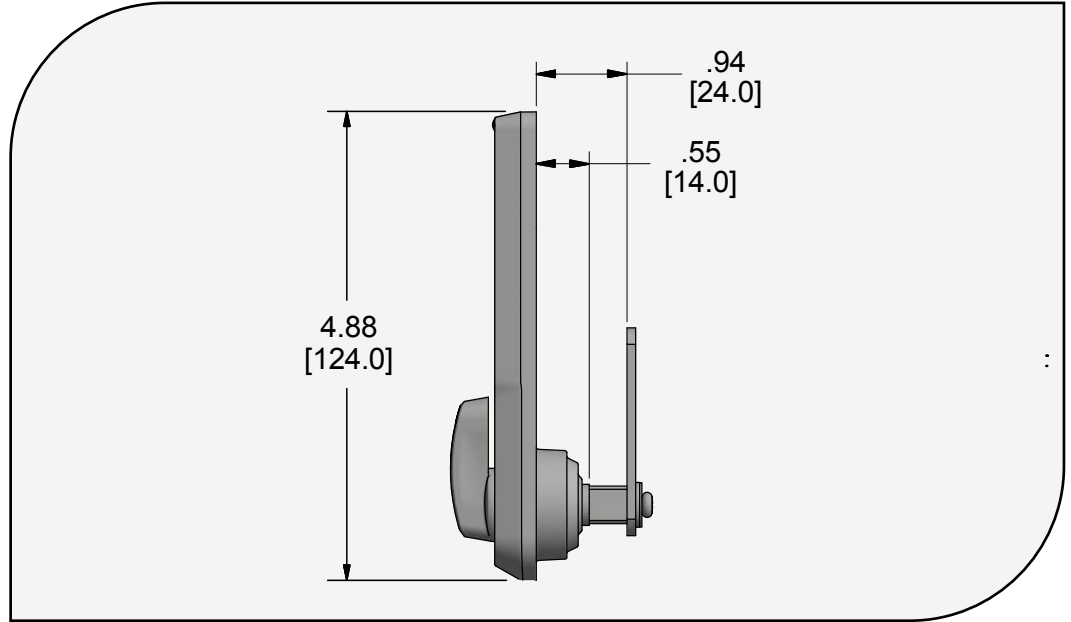

Vertical		
Part Number	Use	Color
E902VSS	Standard	Silver
E902VIS	One-Time	Silver

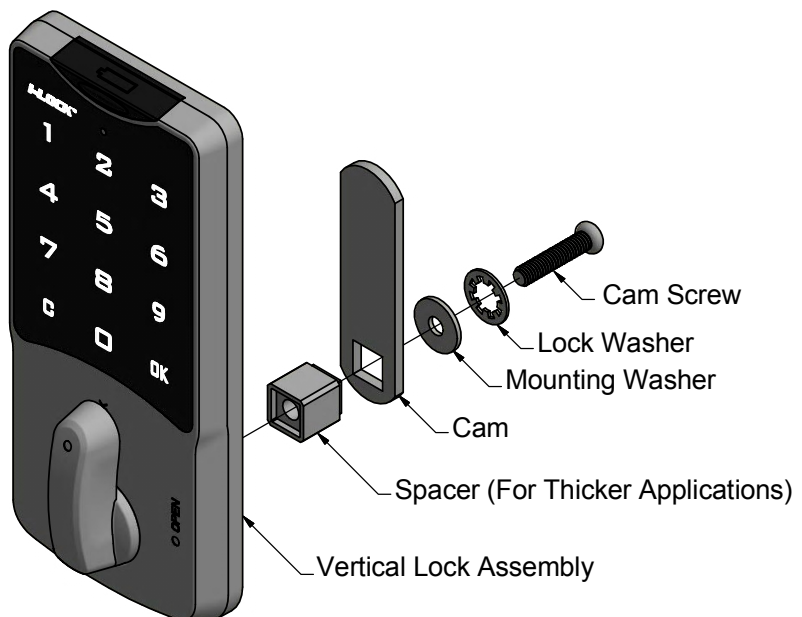

Illinois Lock Company
A division of the Eastern Company

www.illinoislock.com • sales@illinoislock.com • 847-537-1800



i-LOCK[®] Electronic Cam Lock – 10 Button

E902

Lock Models, Rotations & Application Sizing

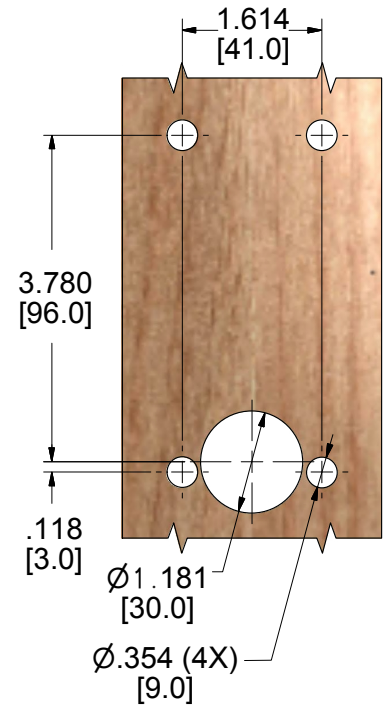
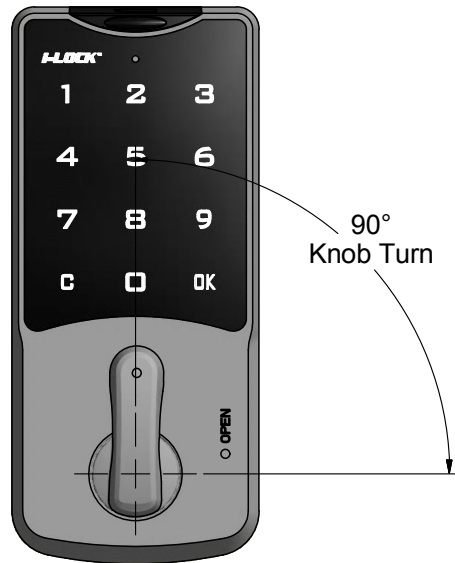
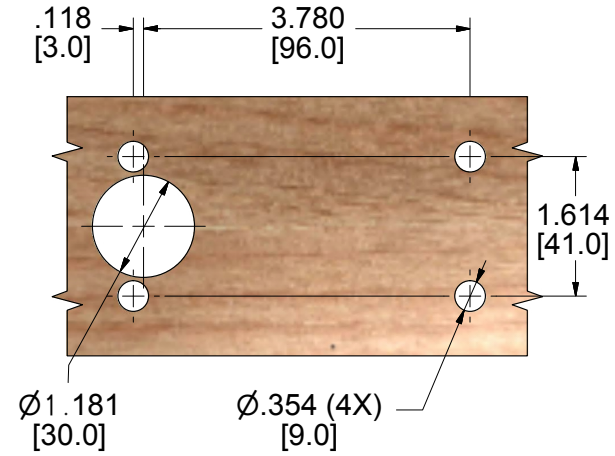
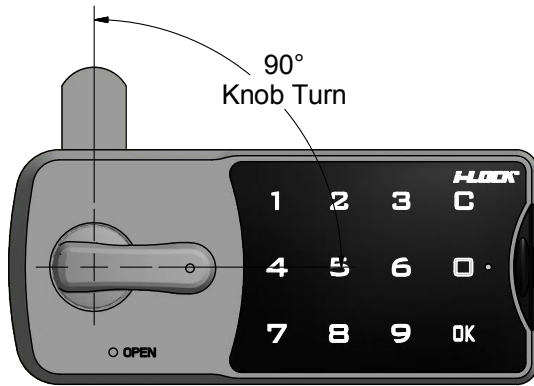



i-LOCK[®] Electronic Cam Lock – 10 Button

E902

Cam Types

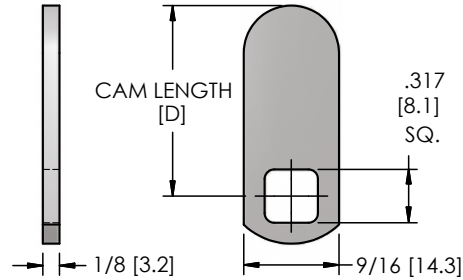

Straight Cams		
Part Number	Cam Length [D-Dim]	
	Inches	Millimeters
142F6280002G	5/8	15.9
026F1780002G	7/8	22.2
142F6380002G	1-1/8	28.6
168F4380002G	1-1/4	31.7
234F7280002G	1-17/32	38.9
119F8780002G	1-21/32	42.1

* length tolerance +/- .039" [1mm]

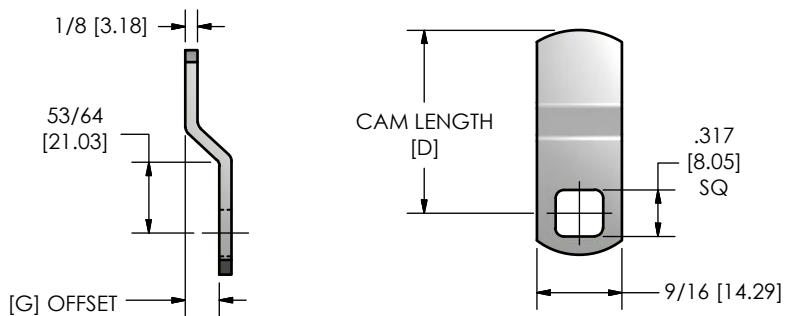

Offset Cams				
Part Number	Cam Length [D-Dim]		Offset Length [G-Dim]	
	Inches	Millimeters	Inches	Millimeters
026F1880002G	7/8	22.2	1/8	3.2
026F2080002G	7/8	22.2	1/4	6.4
026F1980002G	1-1/4	31.8	1/8	3.2
026F1780002G	1-1/4	31.8	1/4	6.4
234F7180002G	1-7/16	36.5	1/4	6.4

* length tolerance +/- .039" [1mm]

Illinois Lock Company
A division of the Eastern Company

www.illinoislock.com • sales@illinoislock.com • 847-537-1800



i-LOCK[®] Electronic Cam Lock – 10 Button E902

Accessories/Replacement Parts

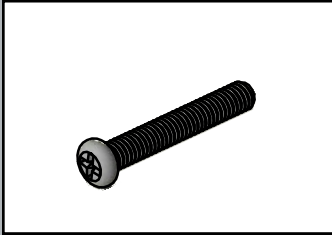

M4 X .7mm X 25mm
[4 pieces included]

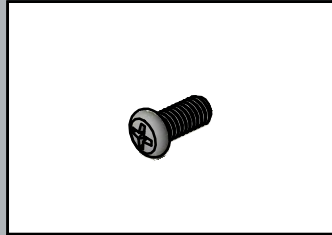

M4 X .7mm X 8mm
[4 pieces included]

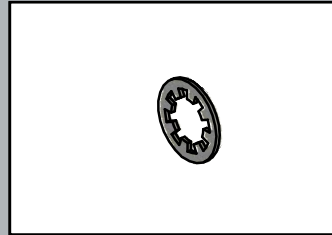

Lock Washer
[4 pieces included]

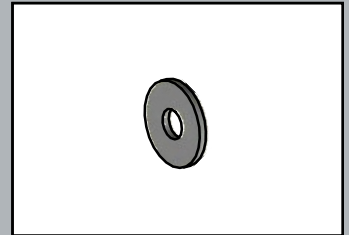

Mounting Washer
[4 pieces included]

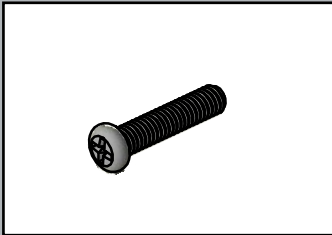

M4 X .7mm X 18mm

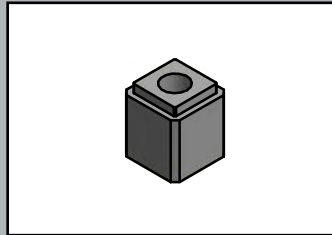

10mm Spacer

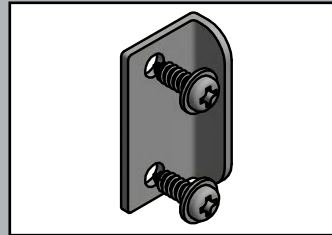

Strike Plate Kit
PN: XS9278



i-LOCK[®] Electronic Cam Lock – 10 Button E902

**All In-Stock Cam
Locks
Supplied with following
Hardware:**

- Lock Mounting Nut
- Cam Mounting Screw
- 1-1/4" straight cam
- Long Mounting Screw
- Short Mounting Screw
- Strike Plate Kit

In-Stock Cam Locks

Part Number	Use	Color
E902VSS	Standard	Silver
E902V1S	One-Time	Silver
E902RSS	Standard	Silver
E902R1S	One-Time	Silver