



2019-C Ram 1500 New Body No-Drill Front Rubber Mud Flap Set Mounting Diagram & Instructions Kit's # RCR34F

IMPORTANT:

Manufacturer is not responsible for negligent use of vehicle with mud flaps installed, including over-tightening of screws and bolts causing damage to vehicle or mud flaps.



TOOLS REQUIRED



Push Pin Removal
Tool

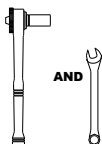

5/16 & 3/8" Open End
Wrench & Socket Wrench

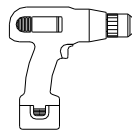

Electric or Chargeable
Drill



1/4" Drill Bit

FLAPS

(1) Flap Assembly,
Front, DS

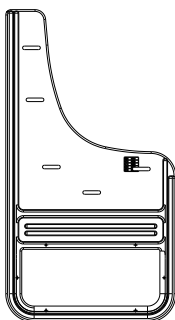

(1) Flap Assembly,
Front, PS

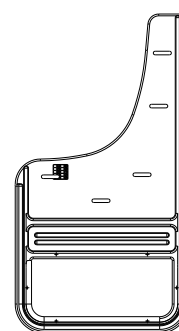

PARTS BAG # 766781

a) (4) Washer, Flat
0.203" x 1", SS
Part #018081



b) (2) Washer, Lock
#10, Helicoil, SS
Part #024001



c) (2) Hex Nut
#10, SS
Part #025003



d) (2) Mach. Screw
#10-24 x 1", SS
Part #012022



e) (2) Bolt, Hex Flange
M4.2 x 1", SS
Part #016041

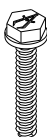

f) (8) Washer, Flat, SS
0.203" x 1.5", 18ga
Part #018066



g) (2) Spring Nut
#8, 9/16" Reach
Part #028004



INSTALLATION

1. Before you install your Gatorback Mud Flap, see the diagram and parts list for all necessary parts.
2. Remove factory push pin from fender (Hole #9).
3. Pull back liner and install spring nut to sit over hole where push pin was removed. (See Diagram).
4. Remove 3 factory bolts from fender holes #6 to #8.
5. Install mud flap through holes #1 to #3 into factory holes #6 to #8 using factory screws and 1-1/2" stainless steel washers (018066).
6. Install mud flap to spring nut through factory hole #9 using provided bolt (016041).

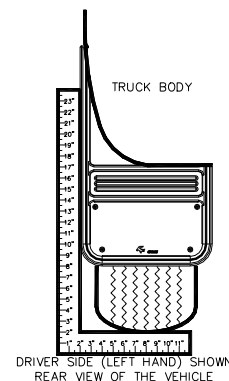

7. Using a bubble level or square, ensure that the mud flap is level. Viewing the vehicle from the back, the outer edge of the mud flap should appear parallel to the tires.
8. Carefully tighten all fasteners. Ensure that the mud flap has remained level.
9. Drill ¼" hole through mud flap hole #5 into plastic liner, creating hole #10.
10. Secure flap through hole #5 to plastic liner hole #10 with a machine screw (012022), 2 stainless steel washers (018081), a lock washer (024001), and a hex nut (025003).
11. Repeat procedure on passenger side.

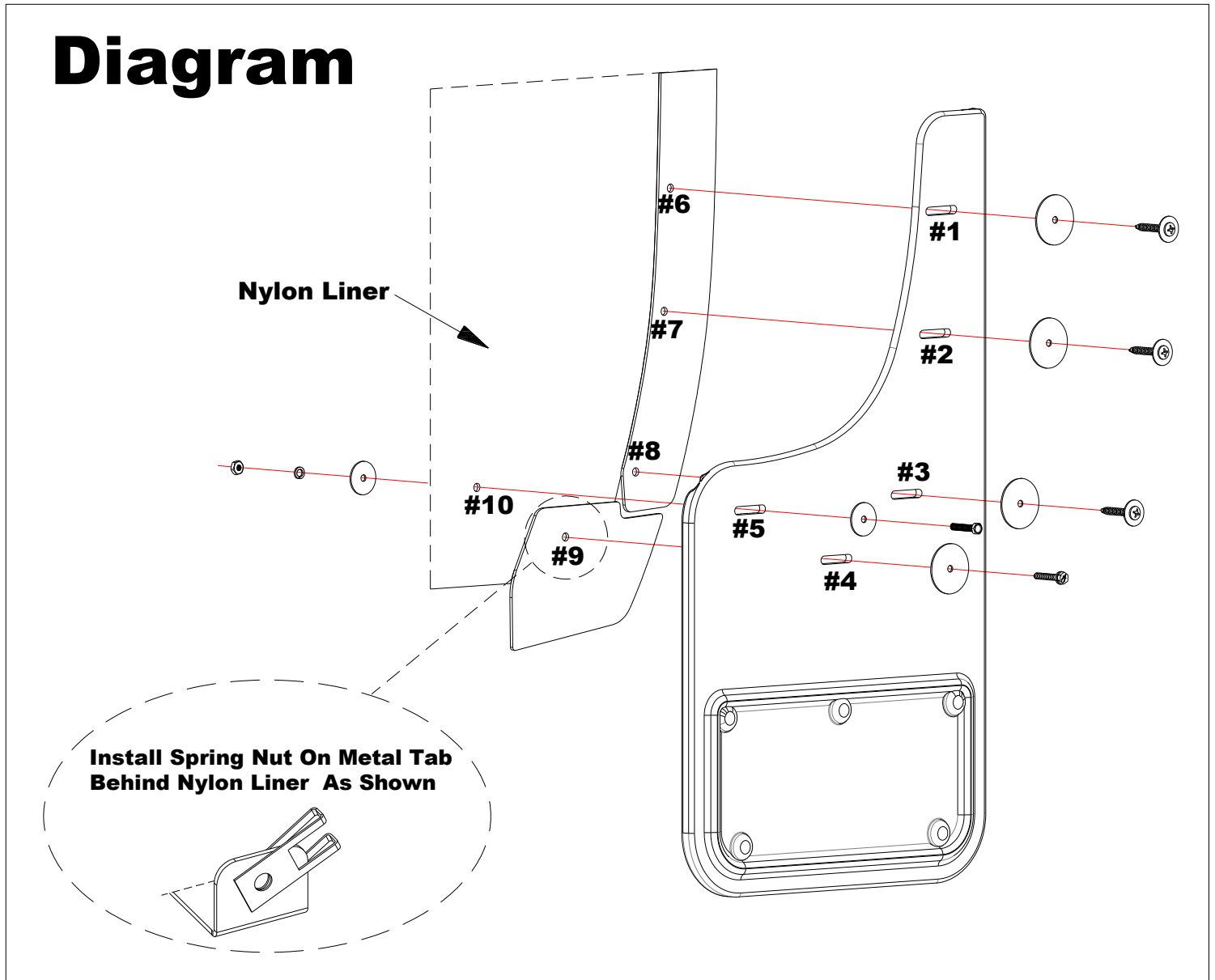

Please check out our YouTube channel to see an install video for this application.

