

PRIMARY APPLICATION

FORD
F-250 Super Duty 4 x 4 (2017 - 2020)
F-350 Super Duty 4 x 4 (2017 - 2020)

TOOLS REQUIRED

- 1 Jack
- 2 Safety Jack Stands
- 1 9/16 Wrench/Sockets
- 1 Ratchet
- 1 7/32 Allen Wrench

PARTS LIST

Item	QTY	Part#	Description
A	2	512344	Upper Bracket 1
B	2	512345	Upper Bracket 2
C	2	511418	Black SumoSprings -47
D	2	512162	Lower Bracket
E	8	512244	Flat Washer
F	8	512323	3/8"-16 x Nyloc Nut
G	2	112282	Clamp Plate
H	4	512356	3/8"-16 Clip Nut
J	4	512340	3/8"-16 x 1" FHCS
K	6	512207	3/8"-16 x 3/4" Serrated Flange Bolt
L	8	512302	3/8" Flanged Lock Nut
M	4	512296	3/8"-16 x 3" FHCS
N	2	112196	3/8" 7"x 5" U-bolt

APPROXIMATE INSTALL TIME

2 Hours

**Driver Side
(Passengers Side Similar)**

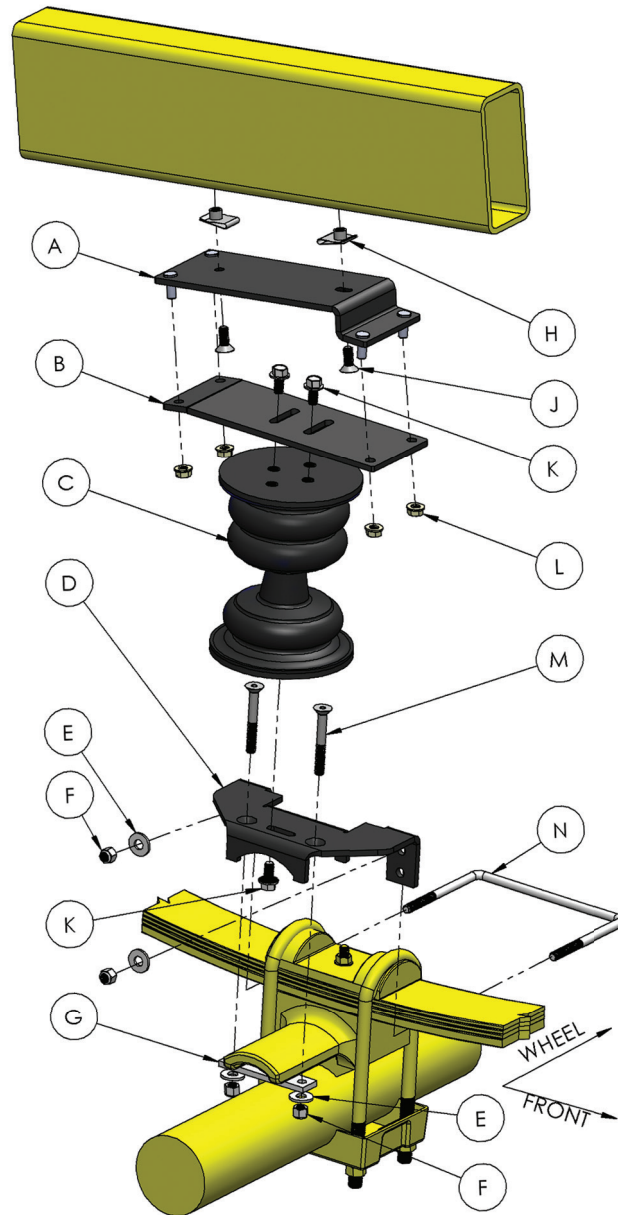

SuperSprings International, Inc.

505 Maple Avenue
Carpinteria, CA 93013

Technical Support
+1 (805) 745-5553
tech@supersprings.com

supersprings.com

Never exceed the manufacturer's Gross Vehicle Weight Rating (GVWR) located on your vehicle's identification tag.

SAFETY NOTICE: We recommend installation be done by a professional or persons with sound mechanical knowledge.

WARNING: These instructions are a general guide for installation. SuperSprings International, Inc. assumes no liability for the actual installation process. Consumers and installers should apply common automotive safety practices when raising and working on any vehicle. **Do not put yourself in a position where, if the vehicle were to move**

unexpectedly, you may be injured. SuperSprings' products are designed to improve vehicle ride quality. Do not load any vehicle beyond the manufacturer's specifications.

BEFORE INSTALLATION: Ensure the vehicle is on a level surface, the parking brake is ON, with the ignition OFF, and place blocks in front of and behind the front tires to prevent the vehicle from moving.

DURING AND/OR AFTER INSTALLATION: Ensure emergency brake cables are not touching the SuperSprings. Secure any cables out of the way with zip ties or by re-routing. **Ensure all A/C lines, brake cables and frame are clear of contact or interference.**

1. Park vehicle on level hard surface. Place wheel blocks in front and behind the front wheels to prevent rolling. Observe all safety precautions and wear safety glasses.
2. Raise the back of the vehicle allowing the axle to hang free and rest the frame on the safety jack stands rated for the weight of the vehicle. Removal of the rear wheels is optional.
3. Starting on the driver's side unbolt and remove the factory jounce bumpers from the underside of the frame and remove the factory studs that are clipped into the frame.
4. Attach two 3/8 clip nuts (ITEM H) onto the frame where the factory studs were positioned. Ensure that the threaded portion is up inside the frame.
5. Using the two 3/8"-16 FHCS (ITEM J), attach the **Upper bracket 1 (ITEM A)** to the frame with the bent end toward the front of the vehicle as in the diagram on page 1. Place a drop of the blue loctite on the threads of each bolt.
6. Using two 3/8"-16 x 3/4" **Serrated Flange Bolt (ITEM K)** attach the top half of the **Black SumoSprings -47 (ITEM C)** to the **Upper Bracket 2 (ITEM B)**. Leave the bolts slightly loose so that the position of the SumoSprings can be adjusted.
7. Place the **Upper Bracket 2** and **SumoSprings** assembly (ITEMS B & C) onto the studs of the **Upper Bracket 1 (ITEM A)**. The end of the **Upper Bracket 2** with the bend goes toward the rear of the truck as in the diagram on page 1. Fasten the brackets together with four 3/8" **Flanged Lock Nuts (ITEM L)**.
8. Place one 3/8"-16 x 3/4" **Serrated Flange Bolt (ITEM K)** into the slot of the **Lower Bracket (ITEM D)** as seen in diagram on page 1. [Temporarily thread one 3/8" Flanged Lock Nut loosely onto the bolt to keep it in place]
9. Place the lower bracket on the bump stop contact perch and position tight to the leaf pack.
10. Place two 3/8"-16 x 3" FHCS (ITEM M) down through the lower bracket.
11. Place the 3/8" 7"x 5" **U-bolt (ITEM N)** around the factory u-bolts and below the leaf pack so that the ends protrude through the holes in the **Lower Bracket (ITEM D)** and fasten securely with the **Flat Washers (ITEM E)** and **3/8"-16x Nyloc Nuts (ITEM F)**.
12. Place the **Clamp Plate (ITEM G)** over the ends of the 3/8"-16 x 3" FHCS (ITEM M) and fasten tight to the bottom of the bump stop perch using the **5/16" Flat Washers (ITEM E)** and **3/8"-16x Nyloc Nuts (ITEM F)**.
[be careful not to over tighten the lower bracket hardware to the point of bending it]
13. Hold the head of the 3/8"-16 x 3/4" **Serrated Flange Bolt (ITEM K)** in place with a wrench, remove the temporary 3/8" nut and add some loctite to the threads of the bolt.
14. Place the lower half of the SumoSprings onto the bolt and turn the SumoSprings to thread it into place.
15. Raise the axle so the upper and lower halves of the SumoSprings are close enough to be aligned and tighten the mounting bolts for each.
16. Repeat steps 3-15 on passenger side of truck.
17. If rear wheels were removed you can now reinstall the rear wheels and torque wheel nuts to manufacturers spec.
18. Jack up vehicle, remove safety jack stands.
19. Remove wheel blocks from the front wheels.
20. Fill out warranty information at: supersprings.com/warranty/

