



2021-2022 Ford Bronco

Mud Flap Set, Rear

Mounting Diagram & Instructions

GCN406R

IMPORTANT:

Manufacturer is not responsible for negligent use of vehicle with mud flaps installed, including over-tightening of screws and bolts causing damage to vehicle or mud flaps.

TOOLS REQUIRED-

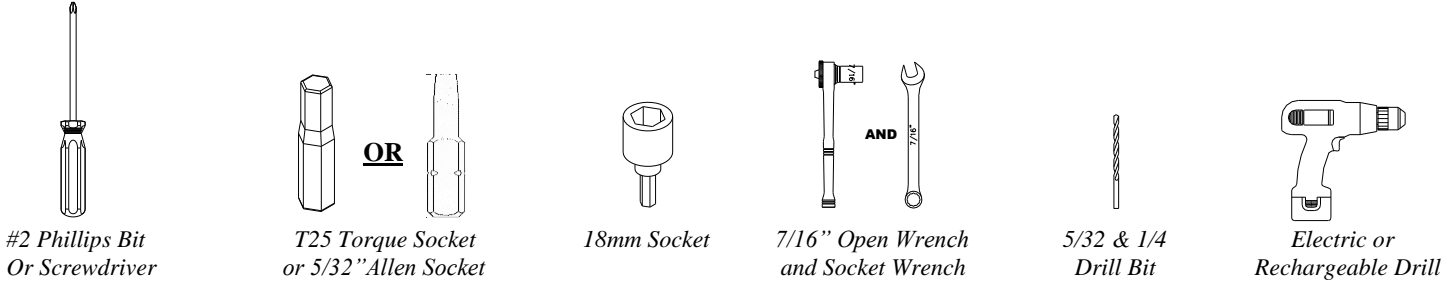

FLAPS/BRACKETS/LOCKING CAPS

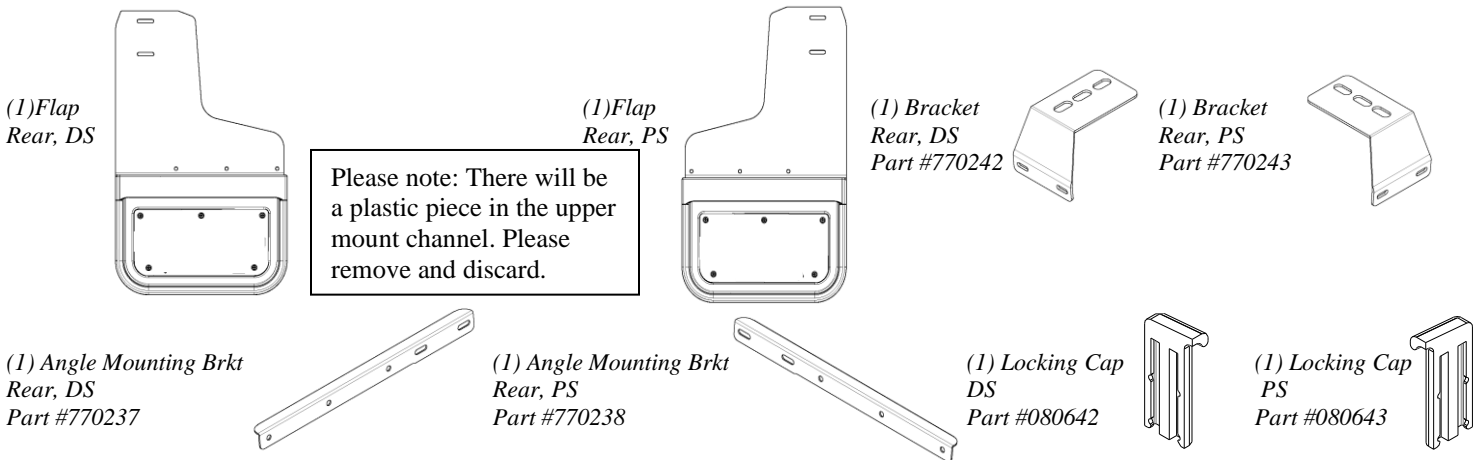

PARTS BAG #770279

a) (10) Button Hd. Screw,
1/4"-20 x 3/4", SS, Blk Ox.
Part #014081

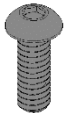

b) (2) Vinyl Adhesive
Clear, Bracket
Part #770252

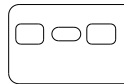

c) (2) Vinyl Adhesive
Clear, Bracket
Part #770253



d) (14) Washer, Nylon
1/4" x 5/8"
Part #054071



e) (10) Hex Nut
1/4"-20, SS, Blk Ox.
Part #025038



f) (10) Washer, lock
1/4", Helicoil, SS, Blk Ox.
Part # 024012



g) (4) Screw, Sheet Metal, SS Blk Ox
#8-18 x 1", 1/4" Hex Head
Part #016055
*Only used on vehicles with
steel rear bumper.*



h) (4) Washer, Flat
0.203" x 1", SS, Blk Ox.
Part #018070
*Only used on vehicles with
steel rear bumper*

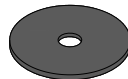

i) (2) Washer Nut Plate
1/4", SS
Part # 759549
*Only used on vehicles with
steel rear bumper*

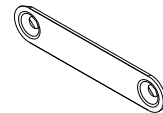

j) (4) Screw w/ 24mm washer
M6.3-1.8 x 30mm Hex Head
Part #016076
*Used on vehicles with
plastic bumper*



INSTALLATION *(For ease of installation it is suggested that the wheel be removed)*

1. Before you install your mud flap and bracket set, see the diagrams and parts list and review to ensure you have all necessary parts. Start on the driver's side.
2. Apply vinyl adhesive (b & c) to the top and bottom of the mounting bracket. (See Diagram #1)

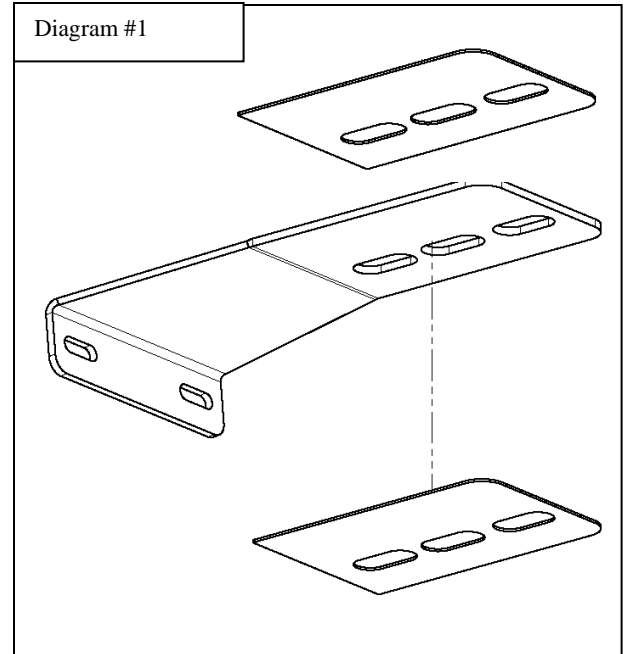

3. Secure the angle mounting bracket assembly through holes #4 to #6 to the mud flap through holes #1 to #3 using a button head screw (a), and secure with a nylon washer (d), lock washer (f), and hex nut (e). (See Diagram #2)

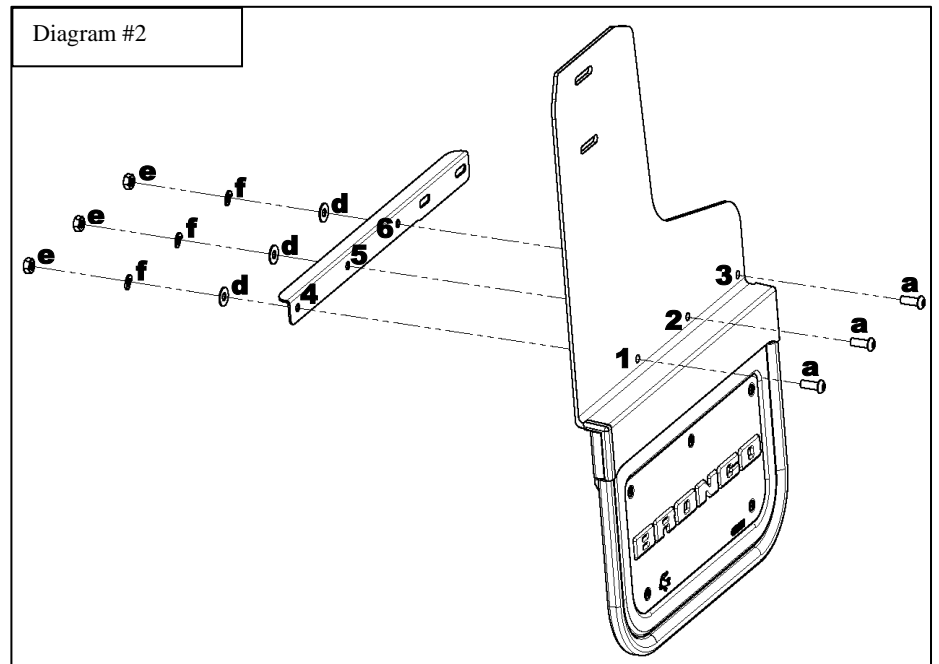

4. Secure the mounting bracket through holes #7 & #8 to the mounting channel through holes #9 & #10 using a button head screw (a) and nylon washer (d), and secure with a nylon washer (d), lock washer (f), and hex nut (e). (See Diagram #3)

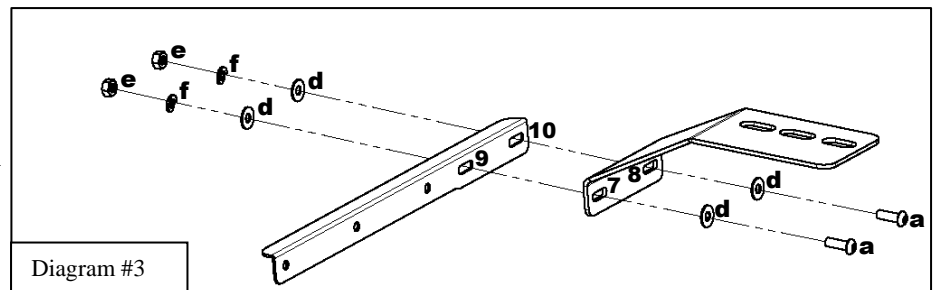

5. Remove rear factory tow hooks by removing the 2 factory M 12 bolts and the factory push pin. (See Diagram #4)

6. Install mounting bracket holes #11 to #13 between the tow hook and the frame, securing with the original push pin and M12 tow hook bolts. (See Diagram #4)

*Note: To allow for levelling adjustments, do not tightly secure at this time.

Note: Some models may be sold without tow hooks, however the factory bolts and push pin will still be included in the correct location for installation of this bracket.

7. With a square or other levelling tool, ensure that the flap is level.

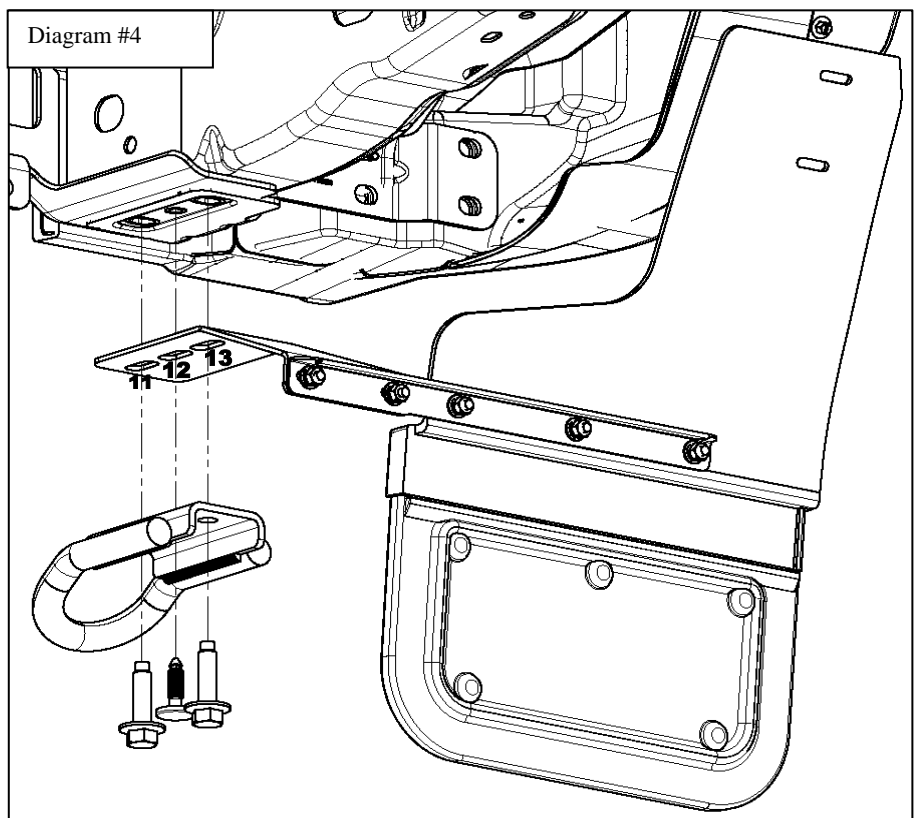

8a. For vehicles with plastic rear bumper, square the flap with the bumper and mark the bumper through mud flap holes #14 & #15. Move mud flap aside and using a 5/32" drill bit, drill pilot holes into the bumper. Loosely install mud flap holes #14 & #15 to the newly drilled holes using M6.3-1.8 screw (j). (See Diagram #5a).

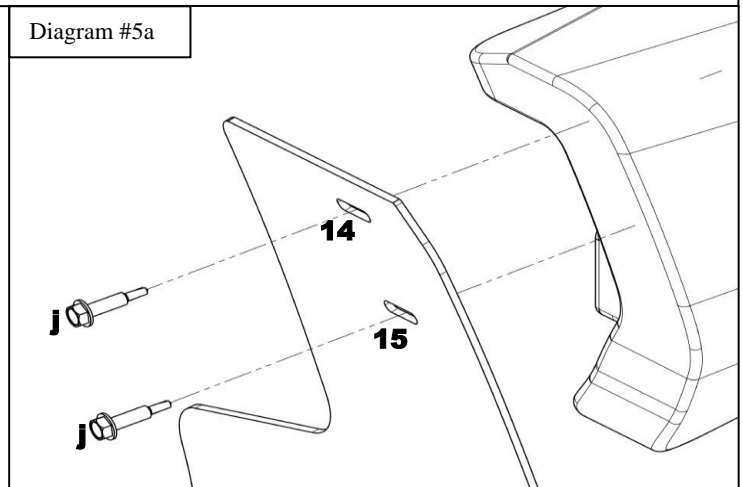

8b. For vehicles with a steel rear bumper, square flap with flare and mark the bumper through mud flap holes #14 & #15. Move mud flap aside and using a 1/4" drill bit, drill pilot holes into the bumper. Loosely install mud flap holes #14 & #15 through newly created holes into washer nut plate (i) using a sheet metal screw (g) and flat washer (h). For ease of install, it is recommended that you start with hole #14 (See Diagram #5b)

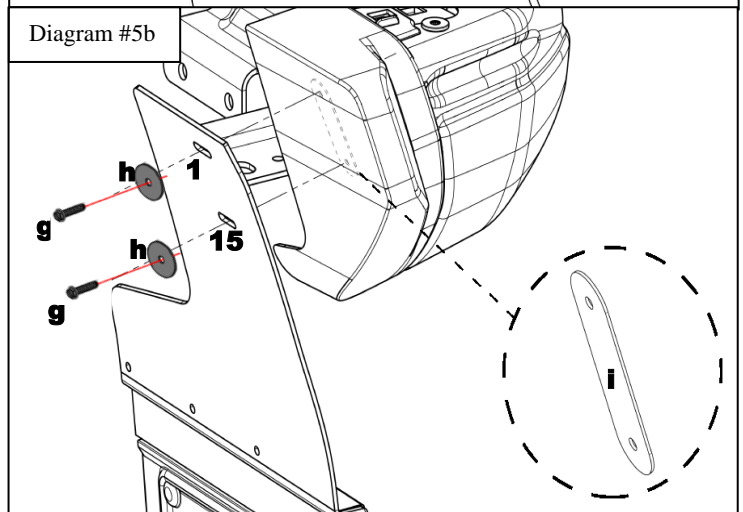

9. Carefully tighten all fasteners, ensuring that the flap remains level.

10. Repeat procedure on the passenger side.

*Note: Torque tow hook bolts to factory specifications of 59 ft. lbs.

Please check out our YouTube channel to see an install video for this application.

