



**2020-C GMC Sierra HD**  
**2" Offset Mud Flap Set, Front**  
**Mounting Diagram & Instructions**  
**Kit# GCAA200F**

**IMPORTANT:**

**Manufacturer is not responsible for negligent use of vehicle with mud flaps installed, including over-tightening of screws and bolts causing damage to vehicle or mud flaps.**



**TOOLS REQUIRED-**

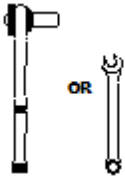

7/16" Open Wrench or  
Socket Wrench



1/4" Socket Driver  
Bit

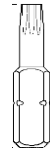

T15 Torx

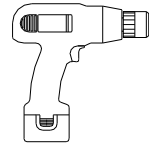

Electric or Rechargeable  
Drill



**\*Note\*** These flaps are meant for use with the Factory Protector Only. They are **NOT** meant for use with the Factory Splash Guard.

**FLAPS**

(1) Flap Assy  
Front, DS

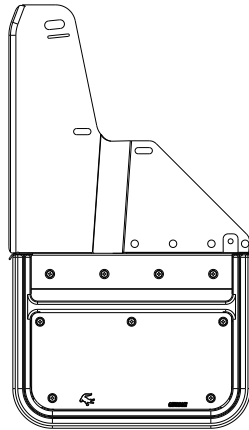

(1) Flap Assy  
Front, PS

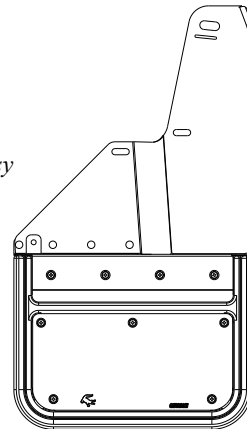

**PARTS BAG # 769056**

**a)** (2) Washer, Flat  
0.281" x 1", 18g, Ox,  
Part #018069

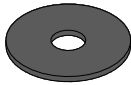

**b)** (4) Washer, Flat  
0.203" x 1", 18g, Ox,  
Part #018070



**c)** (2) Washer, Flat  
0.437" x 1", Nylon  
Part #054091



**d)** (4) Washer, Nylon  
0.203" x 0.885"  
Part #054080

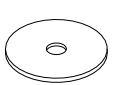

**e)** (2) Cap Screw, Ox.  
1/4"-20UNC x 5/8"  
Part #014071



**f)** (4) Screw, Sheet Metal, Ox.  
1/4" Hex Washer Head, #8-18x1"  
Part # 016055



**g)** (1) Mud Flap Clip  
Driver Side  
Part # 769312

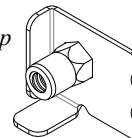

**h)** (1) Mud Flap Clip  
Passenger Side  
Part #769313

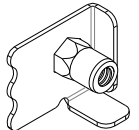

## INSTALLATION *(For ease of installation it is suggested that the wheel be removed)*

1. Before you install your Mud Flap Set, see diagram and parts list for all necessary parts. Start on the driver's side.
2. Remove factory screw from wheel well holes #5 & #6.
3. Loosely install mount clip (g) on mud flap hole #1 using a cap screw (e), black oxidized washer (a), & nylon washer (c).
4. Tuck the offset tab #4 underneath the factory plastic cap until the tab is fully engaged inside the factory plastic cap
5. Loosely secure mud flap through hole #2 into factory hole #5 using supplied sheet metal screw (f), oxidized washer (b) & nylon washer (d)
6. Install mount clip (g) on hole #1 behind the fender lip.
7. Loosely secure mud flap through hole #3 into hole #6 using supplied sheet metal screw (f), oxidized washer (b) & nylon washer (d)
8. Using a bubble level or other levelling tool, ensure that the mud flap is level. Tighten fasteners.
9. Repeat procedure for passenger side.

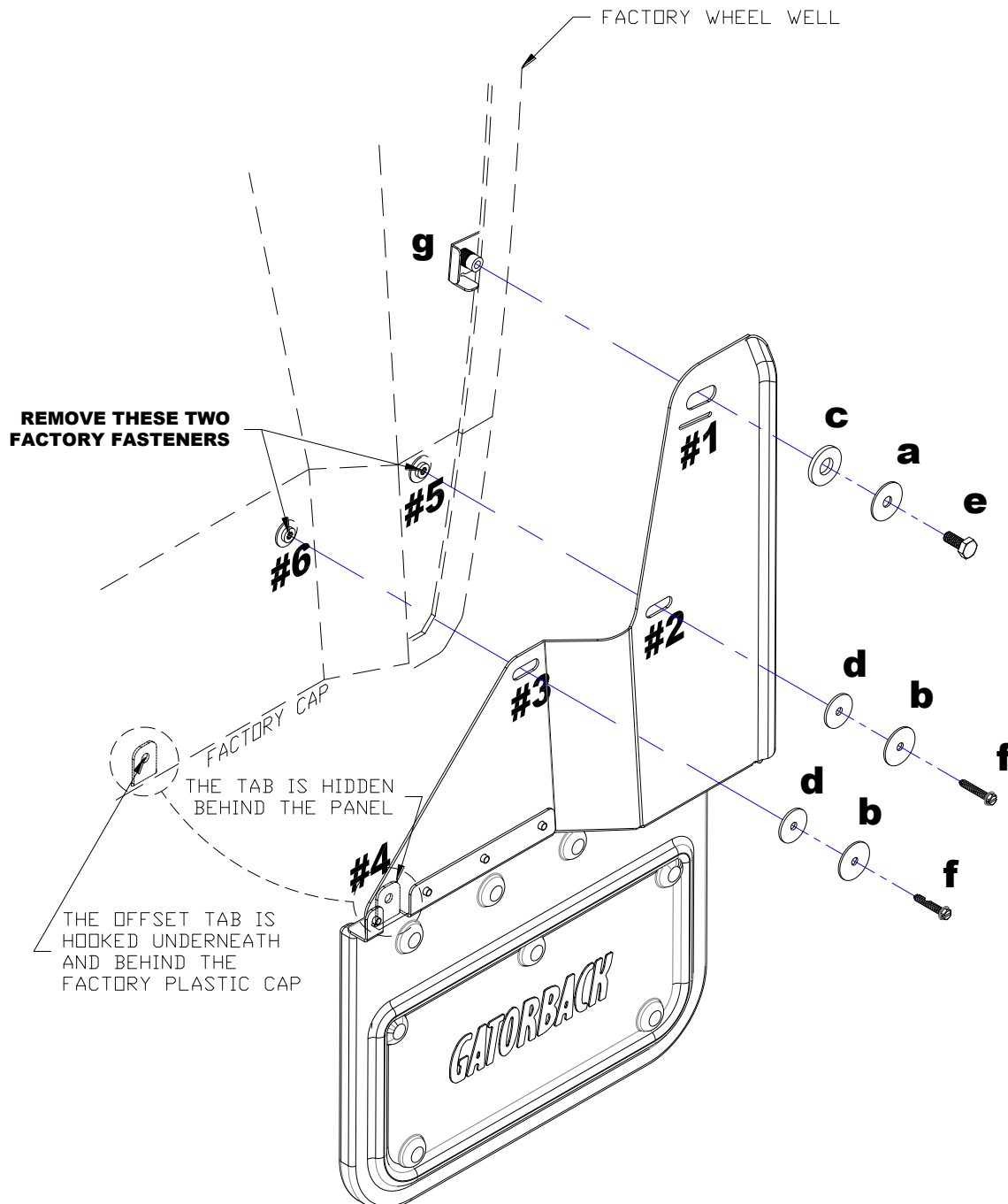



**2020-C GMC Sierra HD**  
**2" Offset Mud Flap Set, Rear**  
**Mounting Diagram & Instructions**  
**Kit# GCAA200R**

**IMPORTANT:**

*Manufacturer is not responsible for negligent use of vehicle with mud flaps installed, including over-tightening of screws and bolts causing damage to vehicle or mud flaps.*



**TOOLS REQUIRED-**

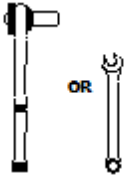

7/16" Open Wrench or  
Socket Wrench

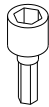

1/4" Socket Driver  
Bit



T15 Torx

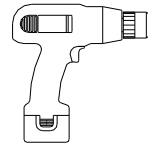

Electric or Rechargeable  
Drill



**\*Note\*** These flaps are meant for use with the Factory Protector Only. They are **NOT** meant for use with the Factory Splash Guard.

**FLAPS**

(1) Flap Assy  
Rear, DS

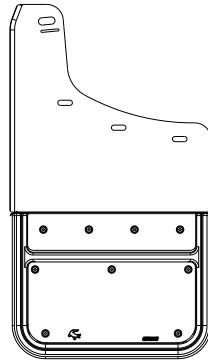

(1) Flap Assy  
Rear, PS

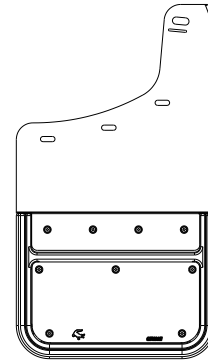

**PARTS BAG # 769057**

**a)** (2) Washer, Flat  
0.281" x 1", 18g, Ox,  
Part #018069

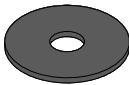

**b)** (6) Washer, Flat  
0.203" x 1", 18g, Ox,  
Part #018070

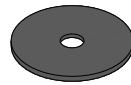

**c)** (2) Washer, Flat  
0.437" x 1", Nylon  
Part #054076

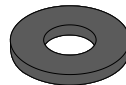

**d)** (4) Washer, Nylon  
0.203" x 0.885"  
Part #054080

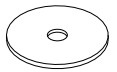

**e)** (2) Cap Screw, Ox  
1/4"-20UNC x 5/8"  
Part #014071

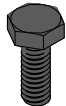

**f)** (6) Screw, Sheet Metal, Ox.  
1/4" Hex Washer Head, #8-18x1"  
Part # 016055



**g)** (1) Mud Flap Clip  
Driver Side  
Part # 769312

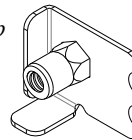

**h)** (1) Mud Flap Clip  
Passenger Side  
Part #769313

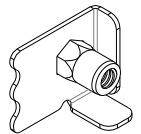

## INSTALLATION *(For ease of installation it is suggested that the wheel be removed)*

1. Before you install your Mud Flap Set, see diagram and parts list for all necessary parts. Start on the driver's side.
2. Remove factory screw from wheel well holes #5 to #7.
3. Loosely install mount clip (g) on mud flap hole #1 using a cap screw (e), oxidized washer (a), and nylon washer (c).
4. Loosely secure mud flap through hole #2 into factory hole #5 using supplied sheet metal screw (f), oxidized washer (b) and nylon washer (d)
5. Install mount clip (g) on hole #1 behind the fender lip.
6. Loosely secure mud flap through hole #3 into hole #6 and through hole #4 into hole #7 using supplied sheet metal screws (f), oxidized washers (b), and nylon washers (d).
7. Using a bubble level or other levelling tool, ensure that the mud flap is level. Tighten fasteners.
8. Repeat procedure for passenger side.

