



STEP 1 – PRIOR TO INSTALLATION

- A)** Bushwacker® only approves installing the cowl guard according to these written instructions with the hardware provided. **WARNING:** Failure to install according to these instructions will invalidate the warranty. This includes, but is not limited to using alternative installation methods, hardware, or materials. **DO NOT USE:** Loctite, SuperGlue, or similar products on the hardware or the flares.
- B) Painting:** (Optional) if paint is desired it must be done prior to installing triple gauge pod on dash. Clean outer surface with a good grade degreaser. **DO NOT USE LACQUER THINNER OR ENAMEL REDUCER AS A DEGREASER.** Wipe outer surface thoroughly with a tack rag prior to paint. Application of plastic adhesion promoter for TPO plastic as per your paint system manufacturer's recommendations is required. Paint triple gauge pod using a high quality enamel, or polyurethane automotive paint. If painting edge trim (not recommended), use a flex additive.
- C)** Wash and completely dry the vehicle before installation. Dirt and debris will negatively affect this products adhesion to the vehicle surface.

Jeep JL Cowl Guard

Unit Part #76129

BW76129 Rev-0 06-07-2018

For complete fitment info visit: www.bushwacker.com

TOOLS FOR EASY INSTALLATION:

- Cleaning cloth



The material that your product is made from can be recycled. Please also consider recycling the packaging that your product came in.



LIMITED LIFETIME WARRANTY AGAINST ANY MANUFACTURING DEFECTS

- To claim a warranty, you must provide Proof of Purchase.

Included in Hardware Kit:

1.



ALCOHOL PREP
PAD
2 pcs

Installation Procedures

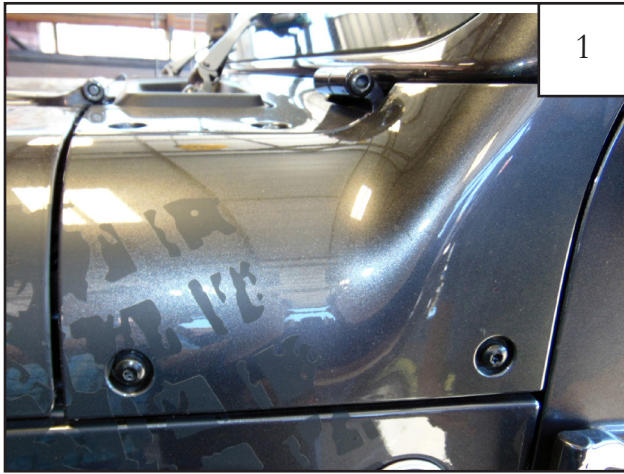

Clean all dirt and debris from installation area.

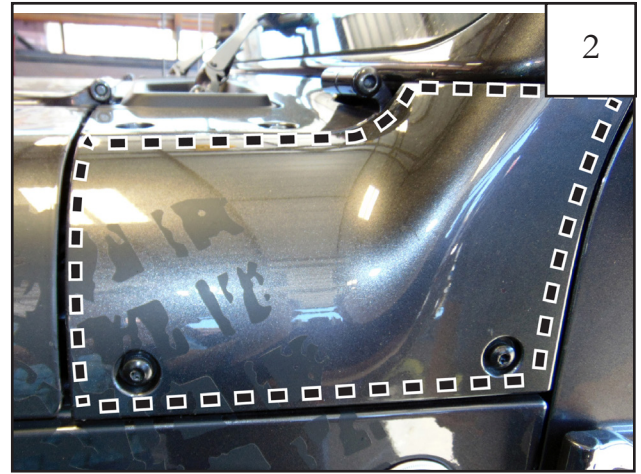

Using the supplied alcohol wipe, clean area where part will be placed. *NOTE: Temperature should be between 60°F and 110°F for proper tape adhesion.*

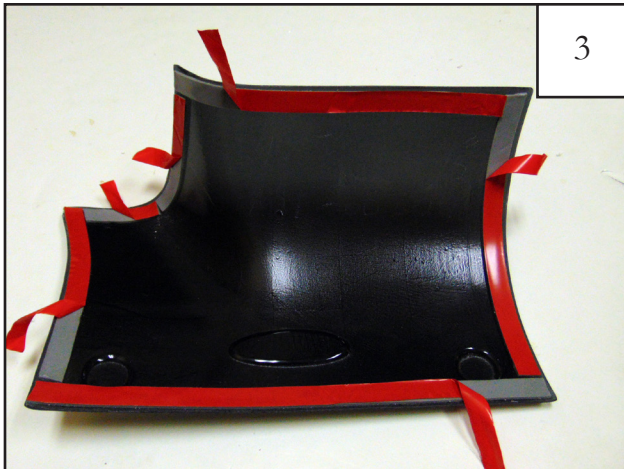

Peel back 2" of tape liner from each flange to expose adhesive.

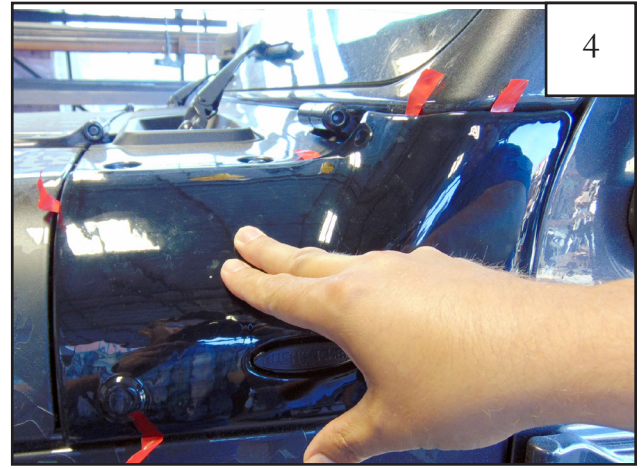

Align part on the vehicle and make sure tape tabs are folded out so they are accessible.

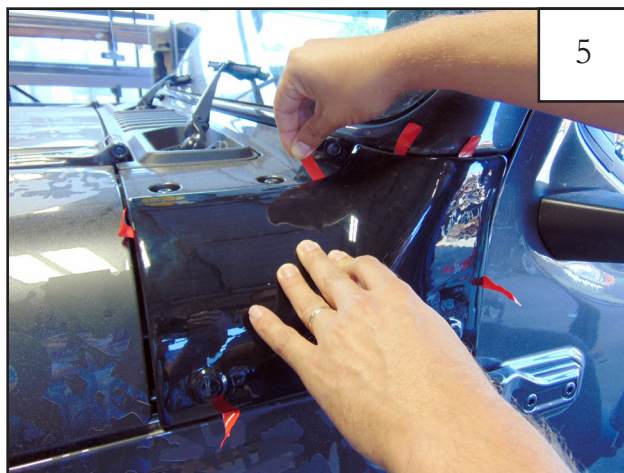

Begin by pulling the top tape liner first. Press down on entire length of part applying strong pressure to the taped areas.



Pull liner of lower tape strip. Press down on entire length of part applying strong pressure to the taped areas.



Pull liner located at the rear toward the door. Press down on entire length of part applying strong pressure to the taped areas.

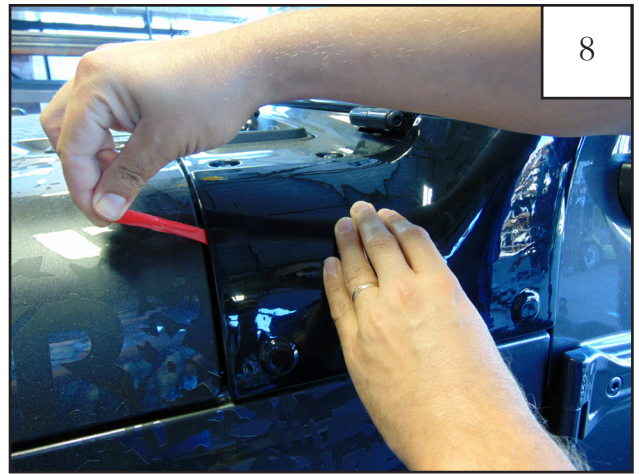

Pull liner located at the front toward the hood. Press down on entire length of part applying strong pressure to the taped areas.

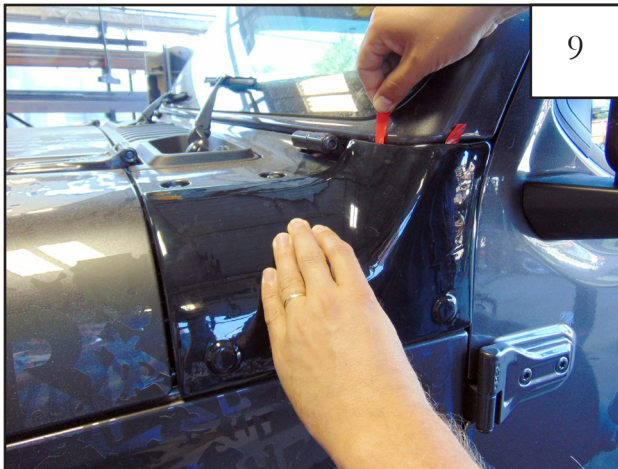

Pull liner located at the top corner closest to the center of the windshield. Press down on entire length of part applying strong pressure to the taped areas.

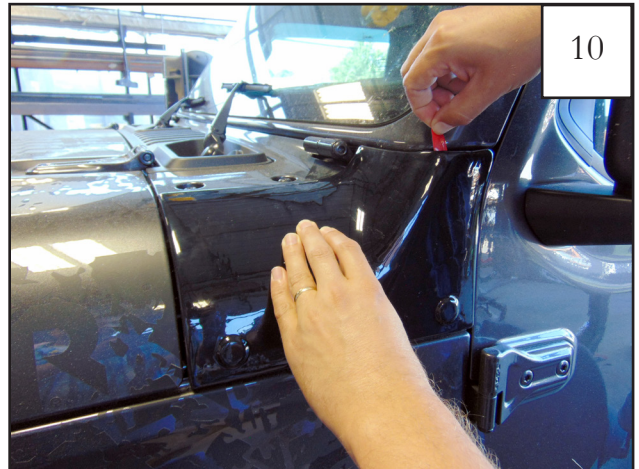

Pull remaining liner. Press down on entire length of part applying strong pressure to the taped areas.



Apply strong pressure for 30 seconds on each section of the part to ensure proper adhesion. *NOTE: The tape reaches maximum adhesive bond after 24 hours of contact.*



Repeat Steps 1-11 for opposite side. Installation complete.